

BUTTERFLY®
CONCEPTS, LLC

**Butterfly Tray
Assembly &
Installation Manual
G2**

WARRANTY INFORMATION

Butterfly Concepts LLC ("Butterfly Concepts") warrants to the original purchaser of Butterfly Concepts products ("Products") that for one (1) year from the date of purchase the Products shall be free from defects in materials and workmanship. The sole remedy available to Purchaser shall be the repair or replacement (at Butterfly Concepts' sole option) of defective Products excluding labor. All replacement and/or repair parts shall be shipped ExWorks Middlebury, Indiana U.S.A or Hsinchu Hsien, 304 Taiwan. This warranty excludes liability for defects in or damage to the Products (both internal and external) caused, directly or indirectly, by misuse (which includes any use or application not specified in Butterfly Concepts' guidelines or recommendations), neglect, negligence, alteration, accident, corrosive chemicals, unsuitable feed, acts of nature, or failure to (a) follow installation instructions, (b) operating instructions or (c) properly maintain the Products. Replacement parts are only warranted for the remainder of the warranty period for the original part. All replaced Products shall become Butterfly Concepts property. Butterfly Concepts does not warrant nor determine warranty of any item that is manufactured by others such as feed tube, feed auger, motors, gear boxes, switches, winches, etc. Such items are warranted separately by the manufacturer, if at all.

Butterfly Concepts makes no other representations or warranties of any kind except as expressly stated herein. Butterfly Concepts disclaims any and all implied warranties including the warranty of merchantability and the warranty of suitability for a particular purpose. To the fullest extent permitted by applicable law, Butterfly Concepts shall not be liable to purchaser for any consequential, incidental, exemplary, punitive, special, or indirect damages. Butterfly Concepts shall not be liable for any damages that are based on negligence, breach of warranty or strict liability. Except as expressly provided herein, Butterfly Concepts' liability hereunder shall in no event exceed the purchase price of the defective products. Some countries or regional entities do not allow exclusion or limitation of incidental or consequential damages, so the above exclusion or limitation may not apply to you.

No person including any dealer, distributor, agent, or representative of Butterfly Concepts is authorized to make any representation or warranty concerning Butterfly Concepts products other than as contained herein. Butterfly Concepts reserves the right to change models, make changes to the Products and specifications at any time without notice or obligation.

RECOMMENDED BUTTERFLY SETUPS - HANDLE TRAY RETURN

1

MAX: 40 M (130 FT)
or
50 Butterfly Trays

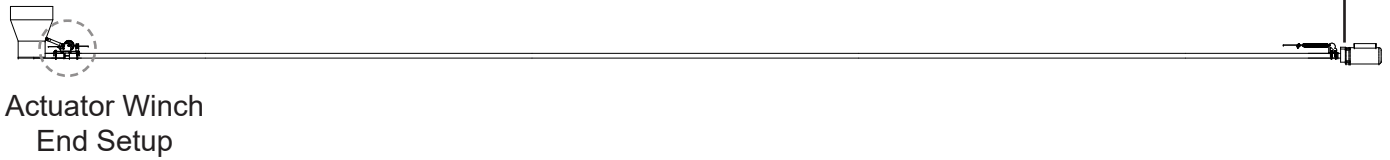

2

MAX: 80 M (260 FT)
or
100 Butterfly Trays



3

MAX: 40 M (130 FT)
or
50 Butterfly Trays

MAX: 40 M (130 FT)
or
50 Butterfly Trays



4

MAX: 80 M (260 FT)
or
100 Butterfly Trays

MAX: 80 M (260 FT)
or
100 Butterfly Trays

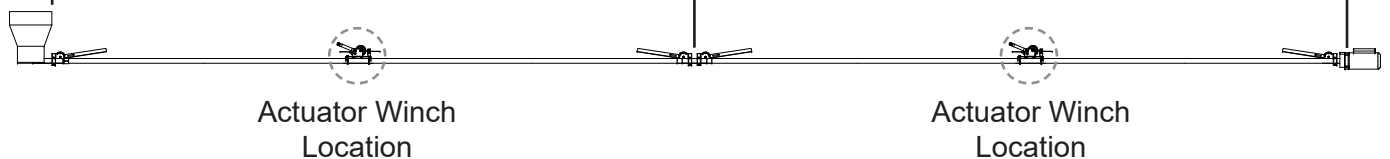

5

MAX: 40 M (130 FT)
or
50 Butterfly Trays

MAX: 40 M (130 FT)
or
50 Butterfly Trays

MAX: 40 M (130 FT)
or
50 Butterfly Trays

MAX: 40 M (130 FT)
or
50 Butterfly Trays

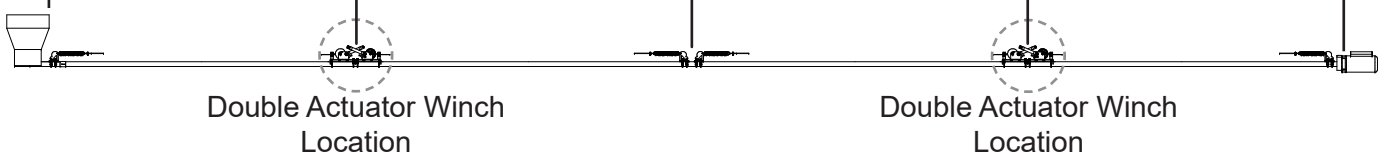

RECOMMENDED BUTTERFLY SETUPS - SPRING TRAY RETURN

1

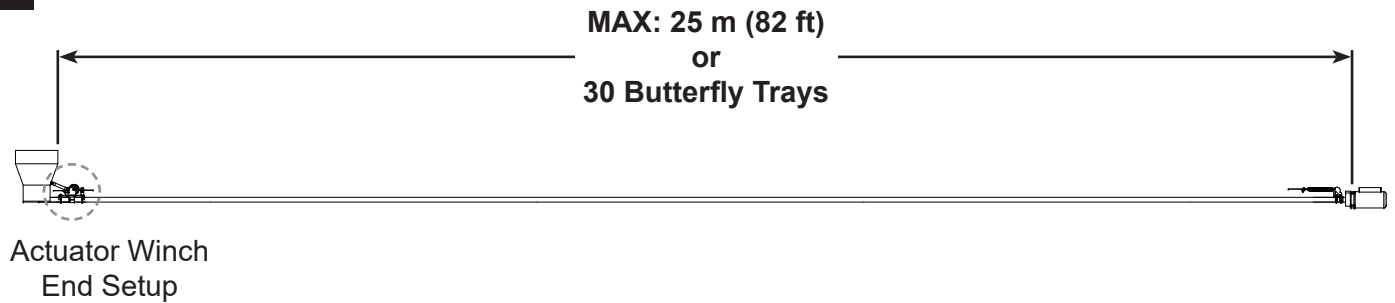

2

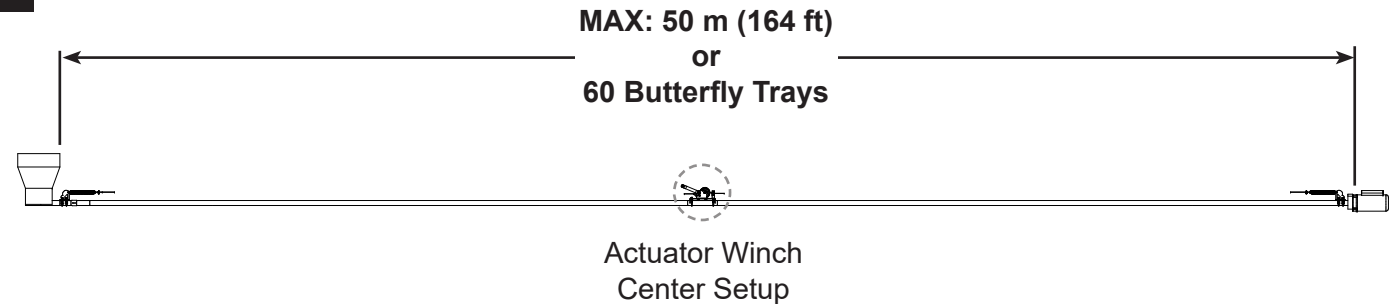

3

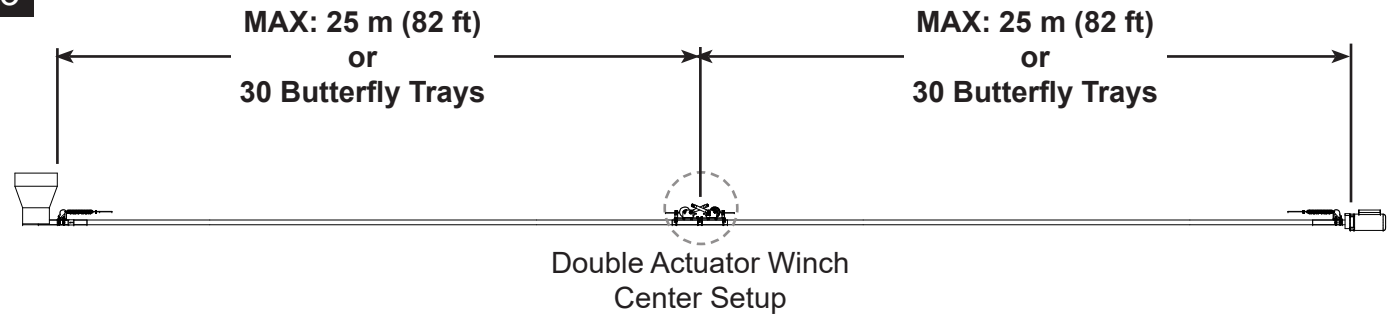

4

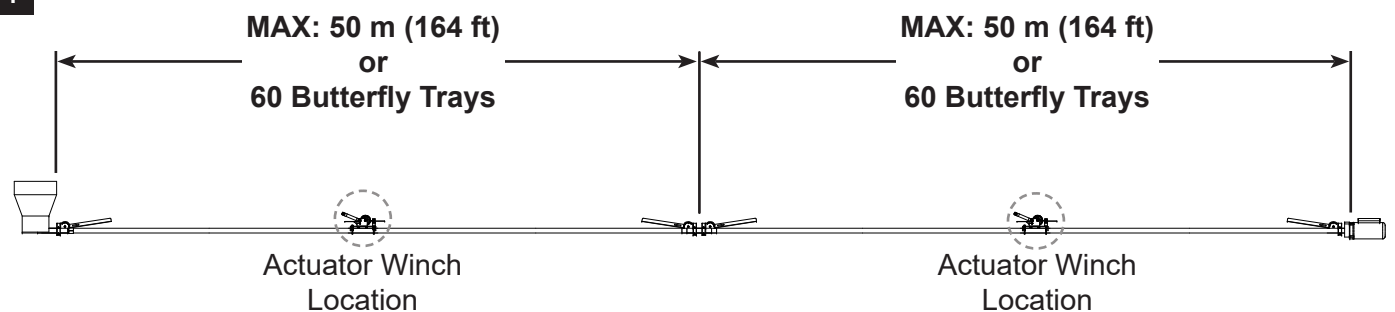

5

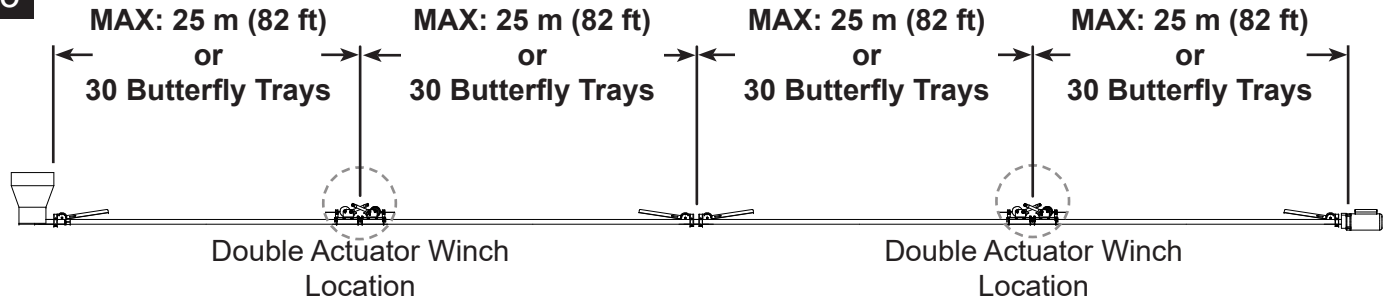

ACTUATOR CABLE

1

IMPORTANT: For all system installation, use 3 mm or 7/64 in in 1X7 galvanized cable only.

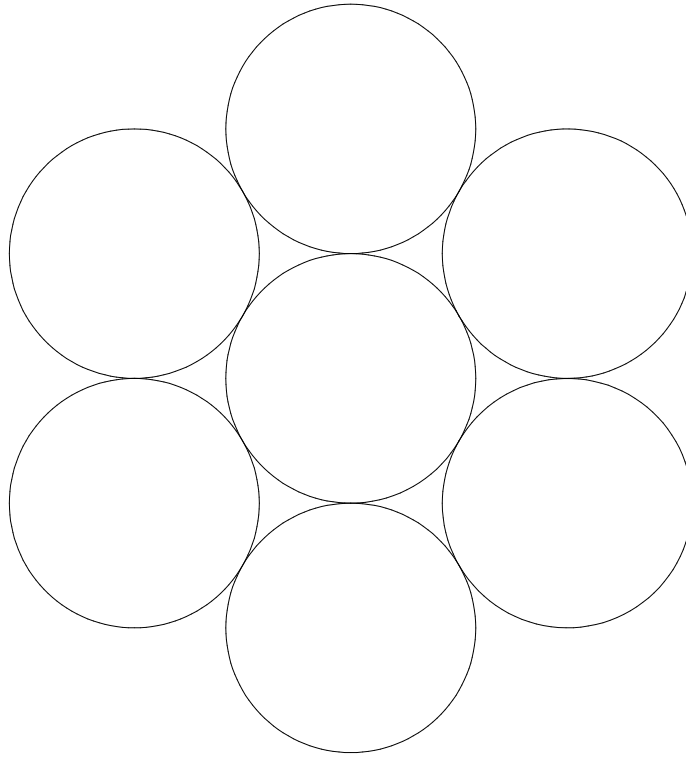

2

Do Not use any of these or any other strands.

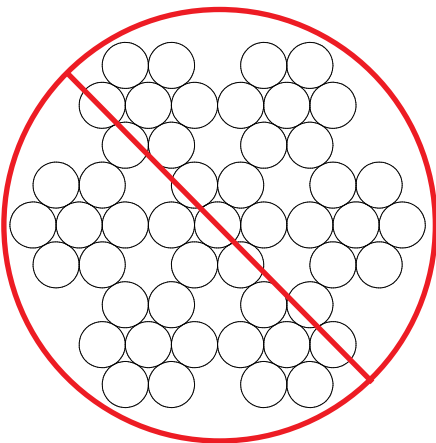

7X7

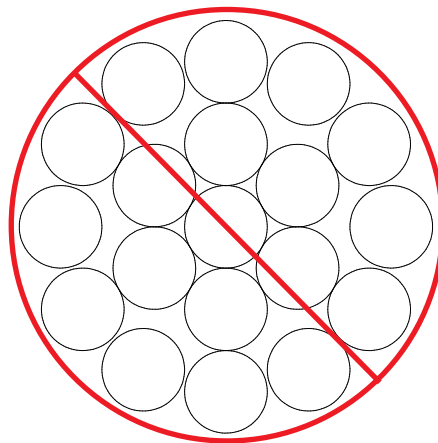

1X19

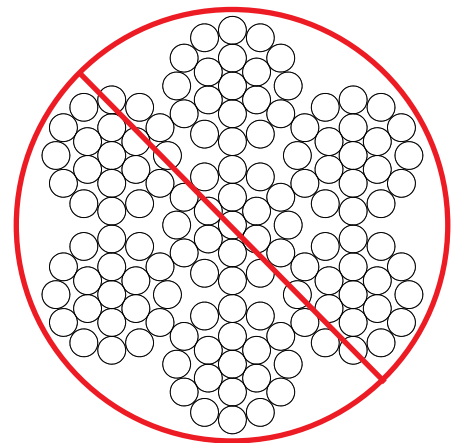

7X19

END CONTROL TRAY INSTALLATION

1

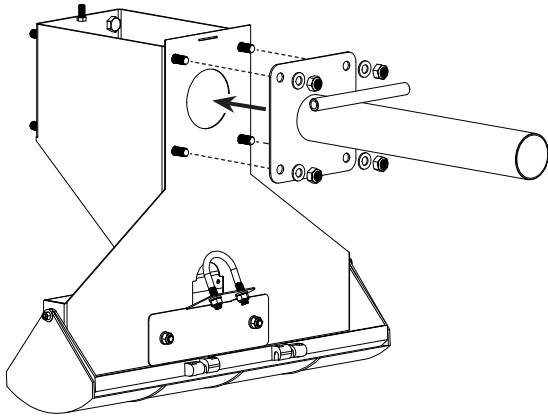

2

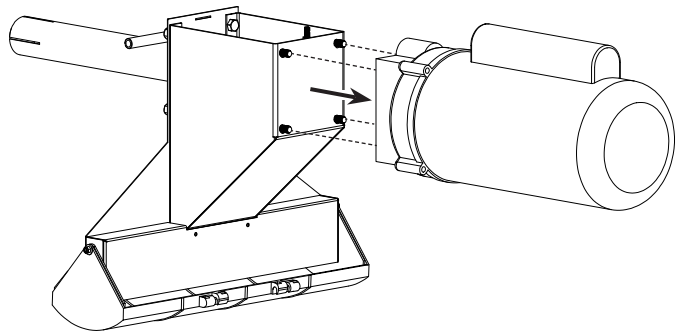

3

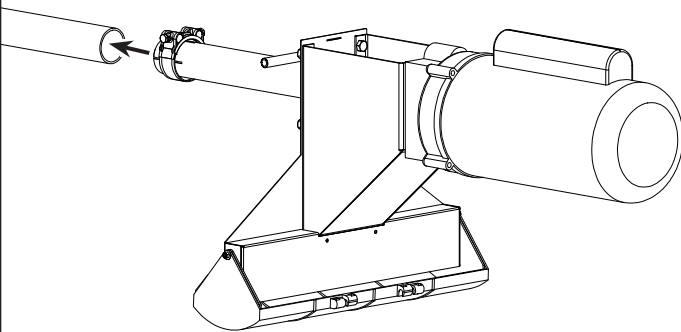

4



Measure in 8 mm / 5/16 in and mark both ends of the threaded rod.

5

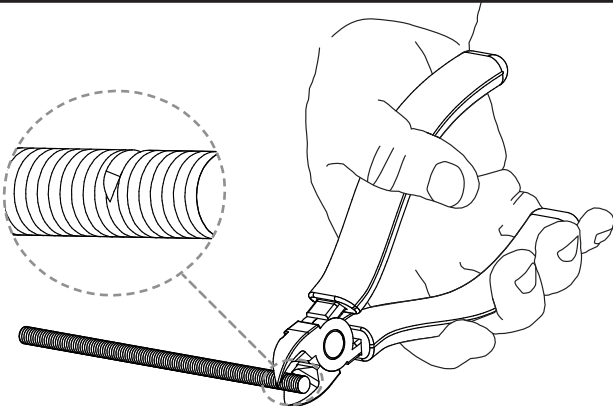

Both ends.

6

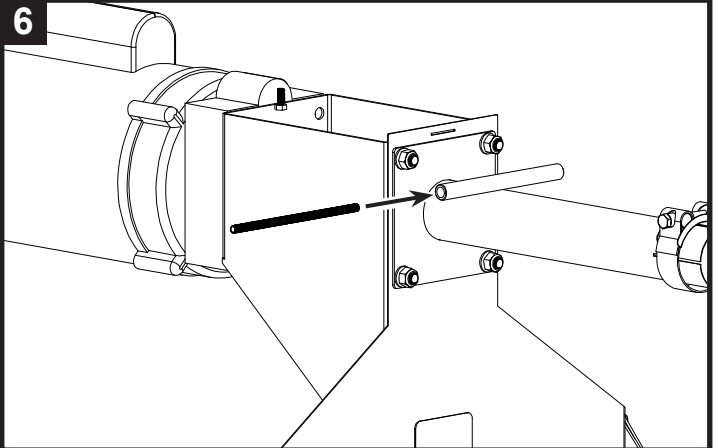

7

Apply a small amount of medium strength thread locker as shown.

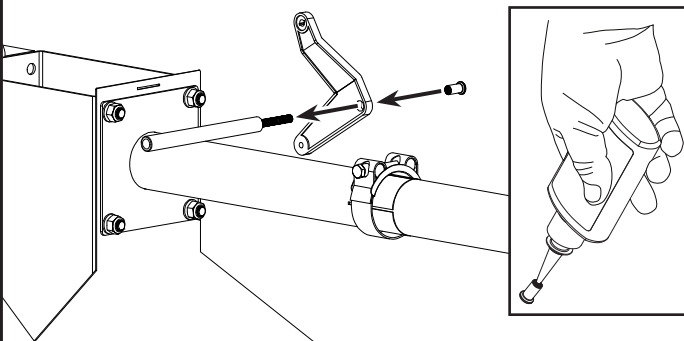

8

Apply a small amount of medium strength thread locker as shown.

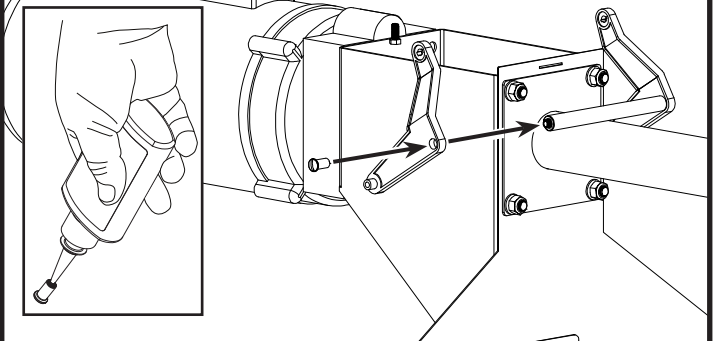

END CONTROL TRAY INSTALLATION

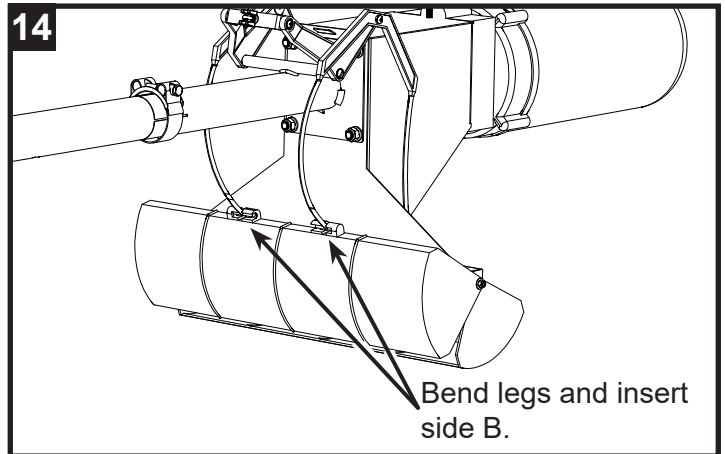
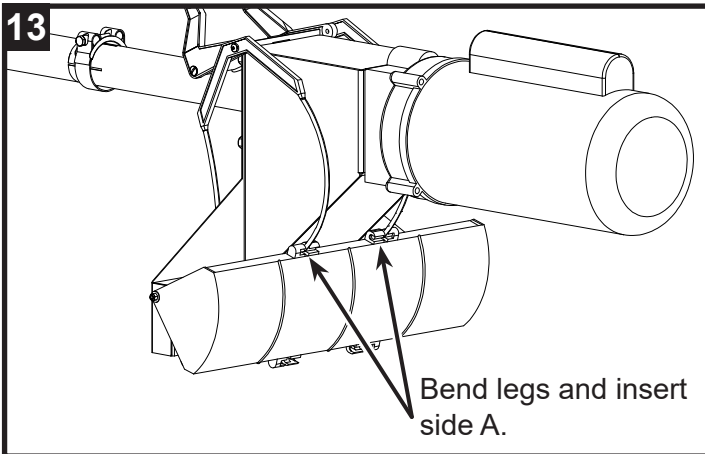
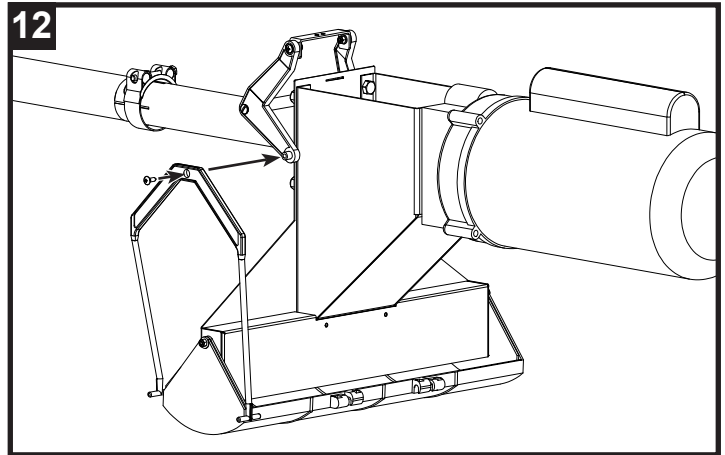
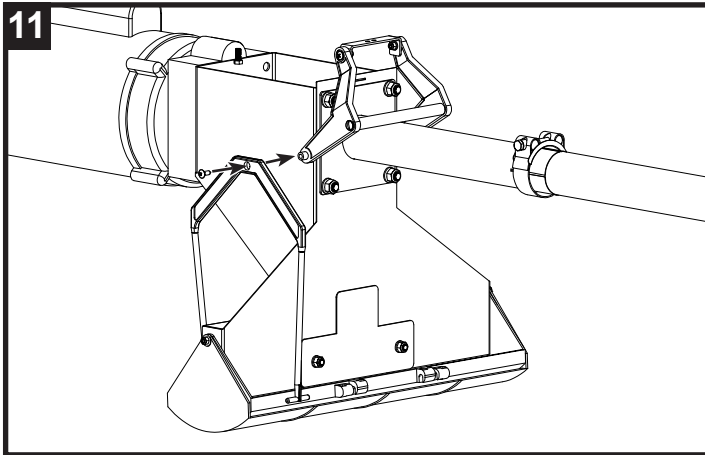
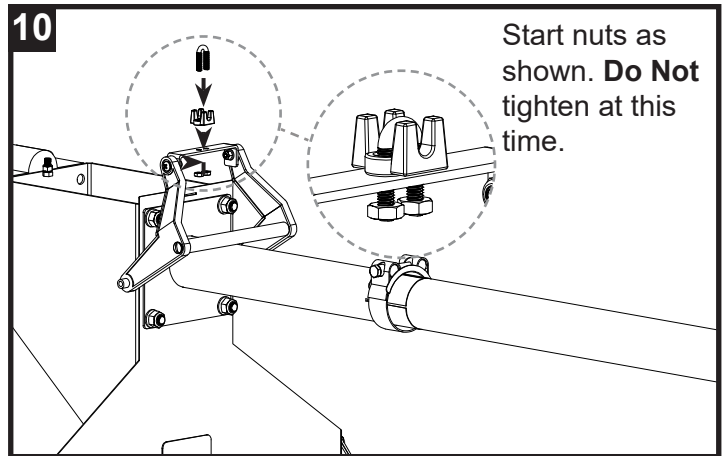
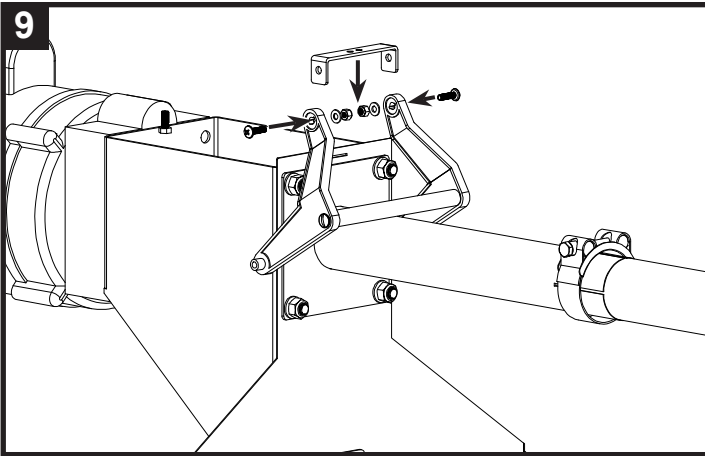

ACTUATOR ASSEMBLY

1

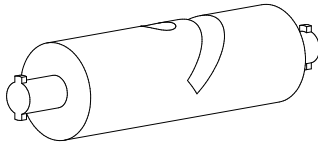

2

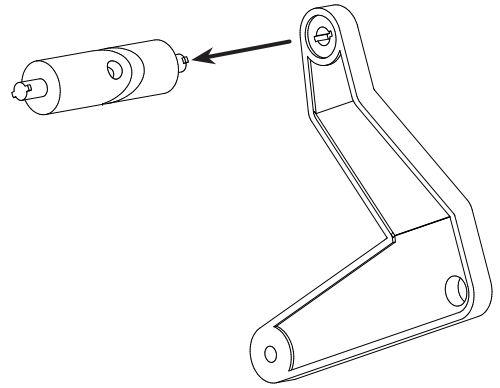

3

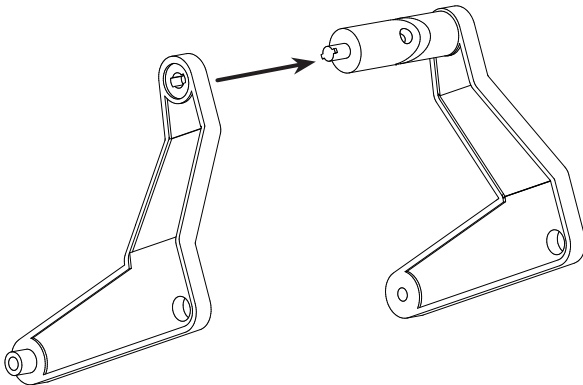

4

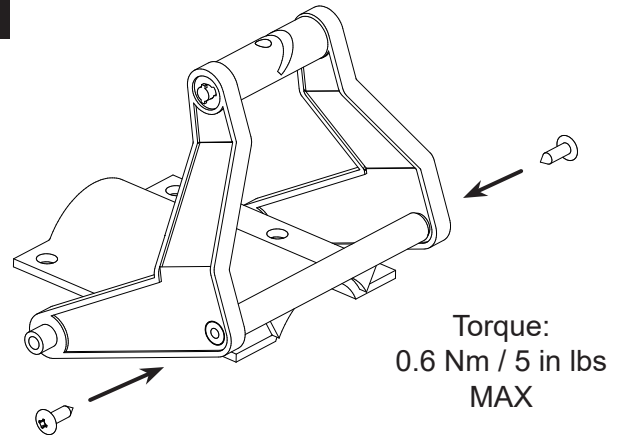

5

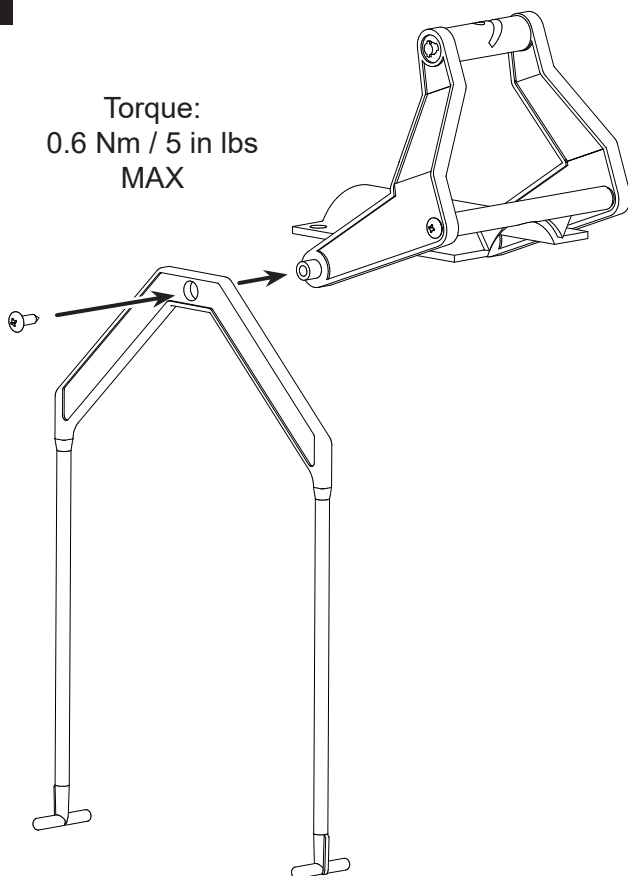

6

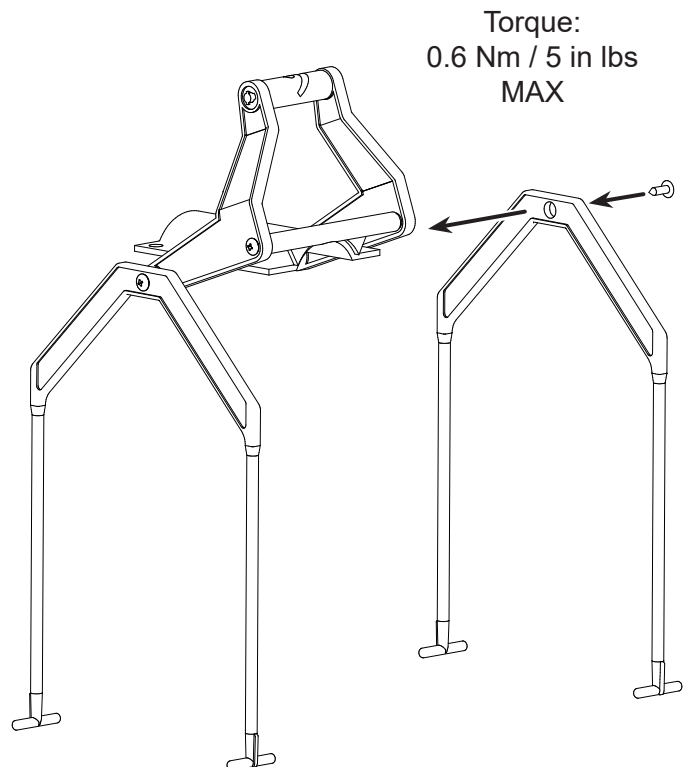

OPTIONAL ACTUATOR WINCH SETUPS

1 Option 1: Actuator winch setup

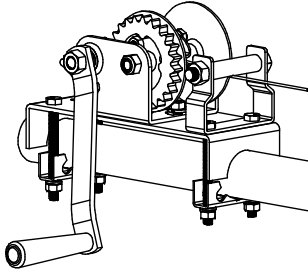

Install actuator winch as shown.

2 Option 2A: 2 actuator winch setup

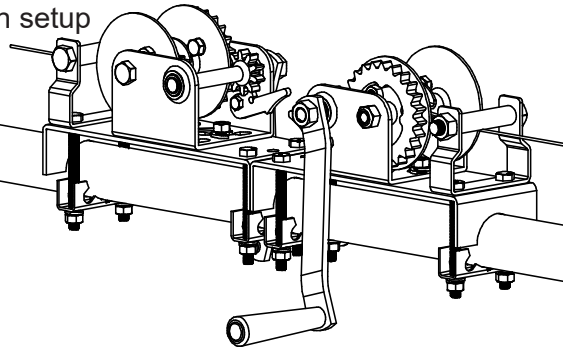

Install actuator winches as shown. This setup is for 3 or 4 trays on 3M / 10 ft feed tube. Shown on 4 tray feed tube. For 5 trays on 3M / 10 ft feed tube see Option 2B.

3 Option 2B: 2 actuator winch setup

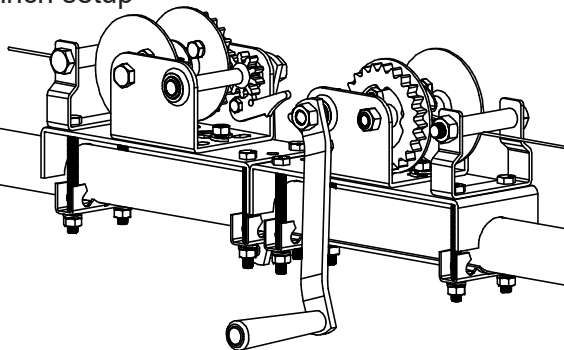

Install actuator winches as shown with cover. This setup is for 5 trays on 3M / 10 ft feed tube.

4 Option 3: Actuator winch setup

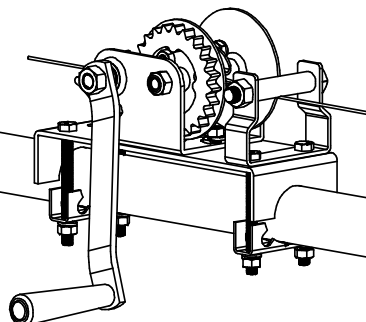

Install actuator winch as shown. Start fasteners, do not tighten at this time.

TRAY INSTALLATION

1

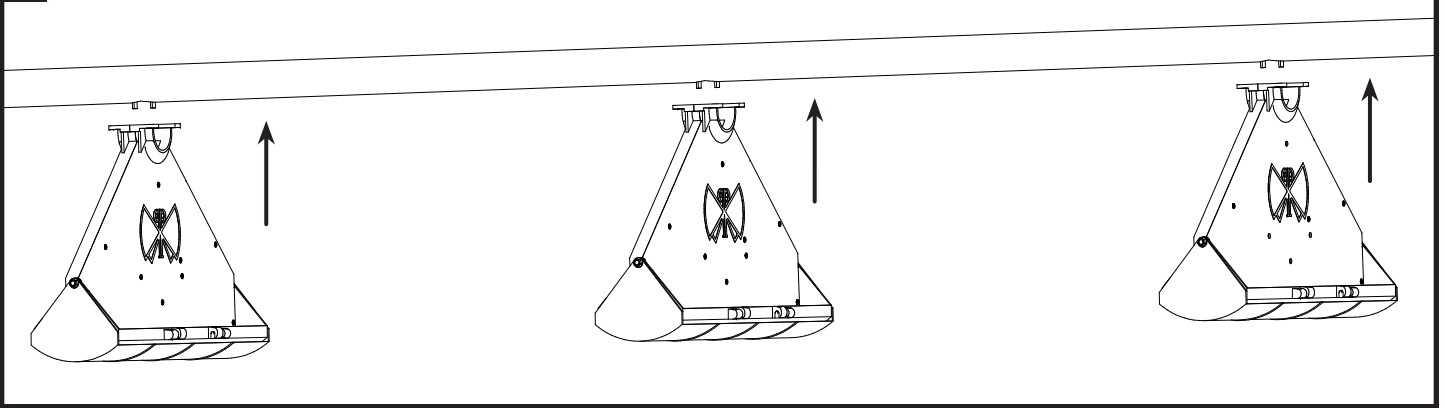

2

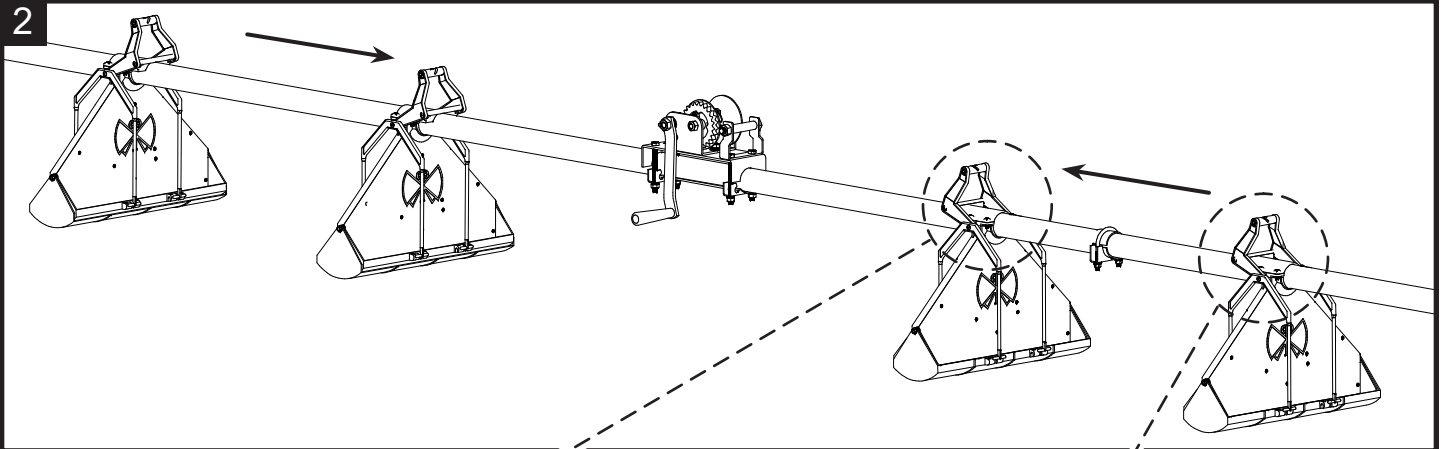

3

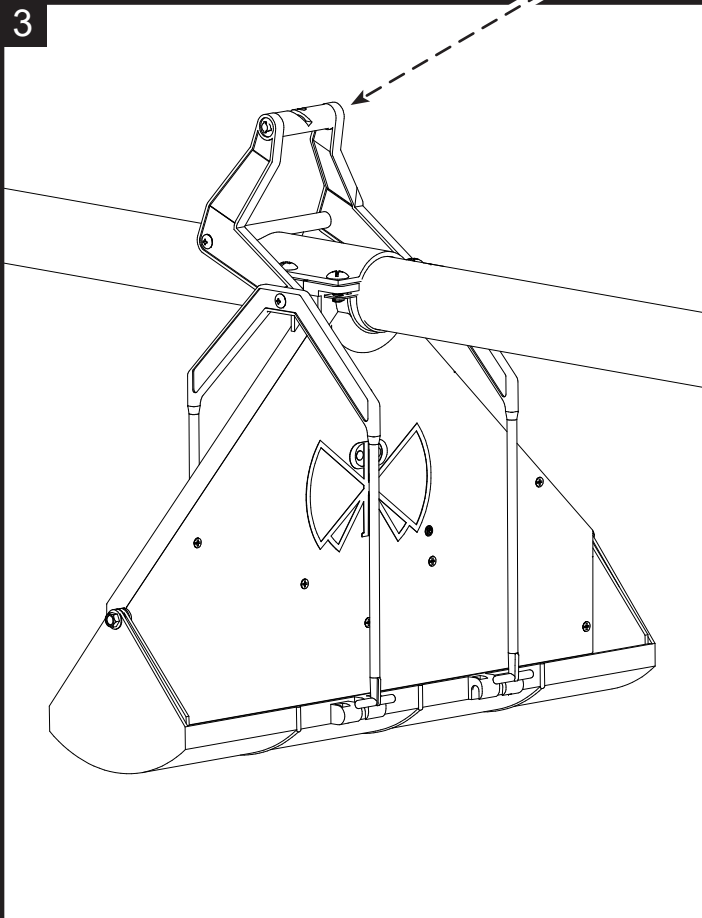

4

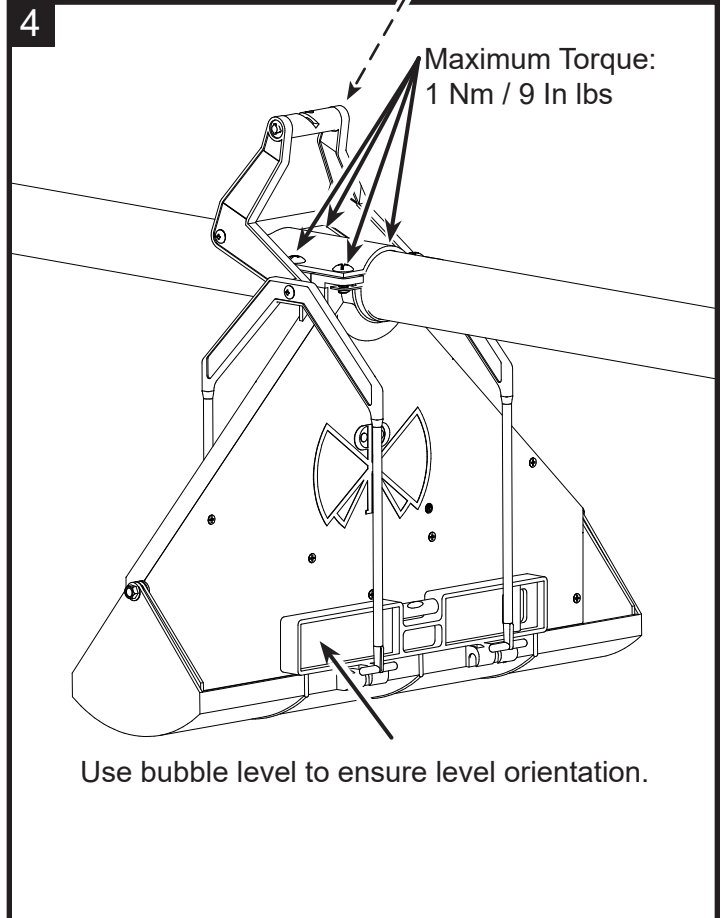

TRAY INSTALLATION

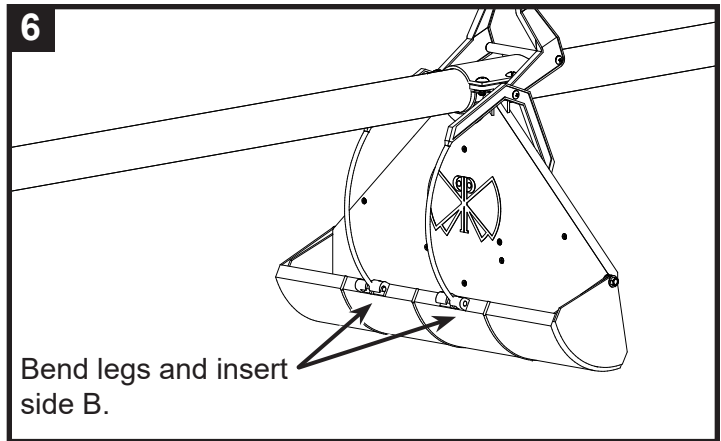
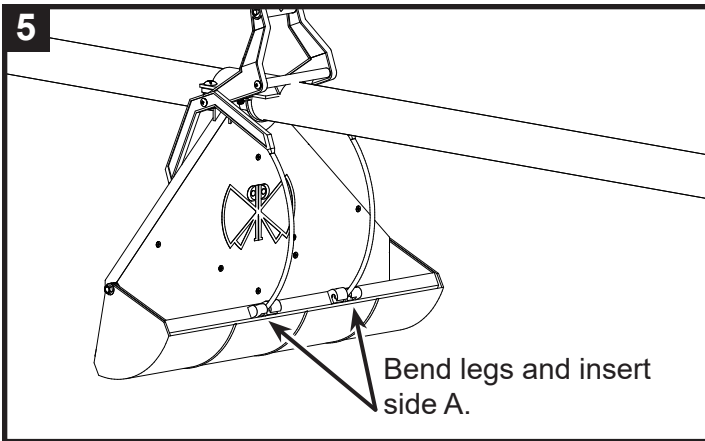

TRAY RETURN ASSEMBLY - HANDLE VERSION

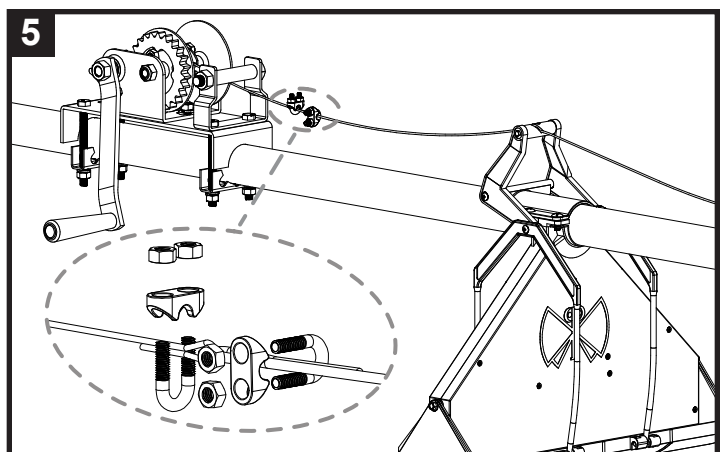
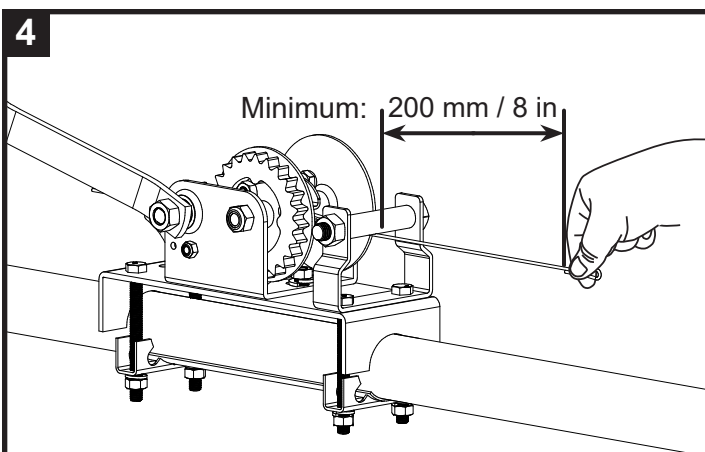
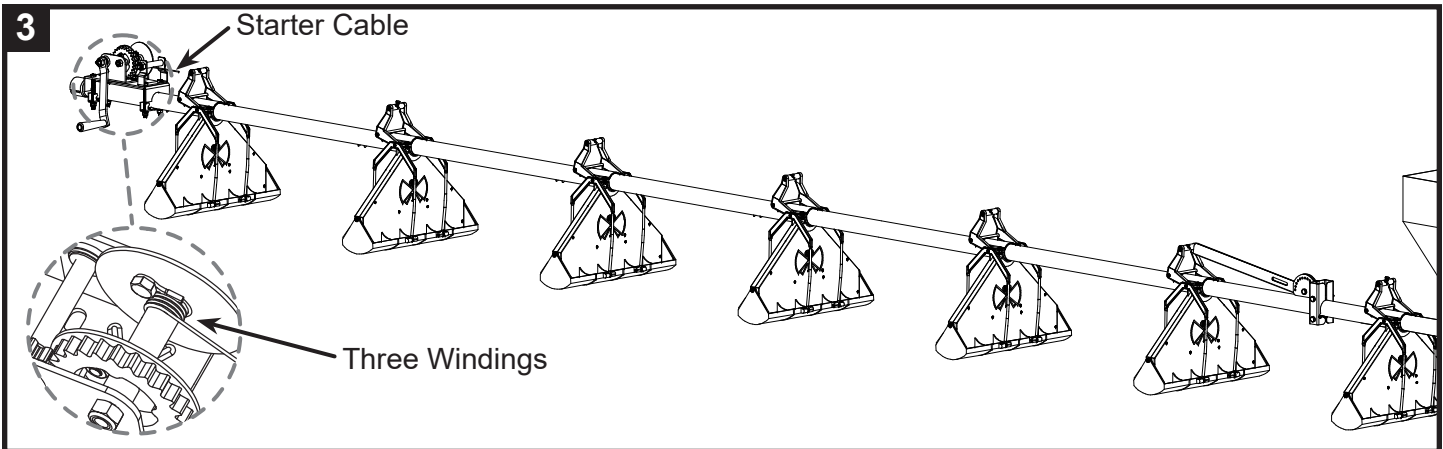
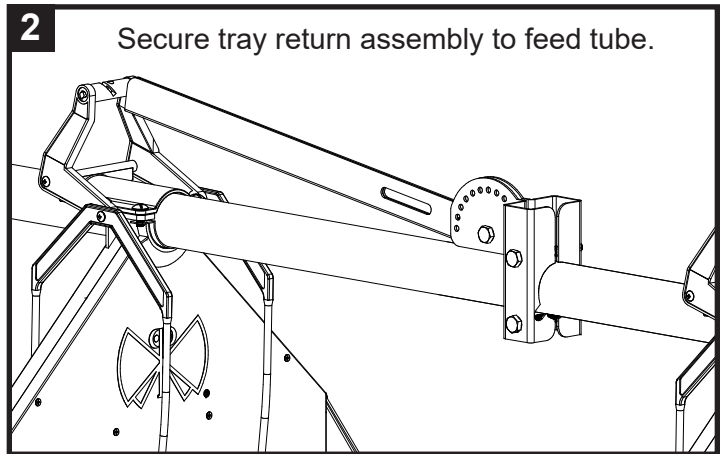
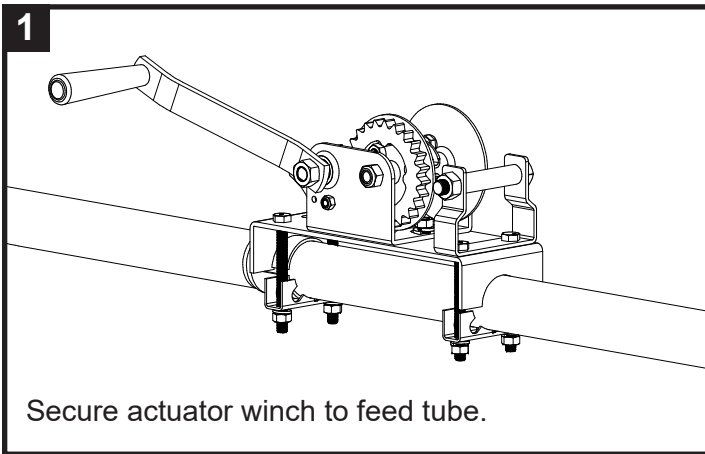

TRAY RETURN ASSEMBLY - HANDLE VERSION

6

Attach the actuator cable to the last tray.

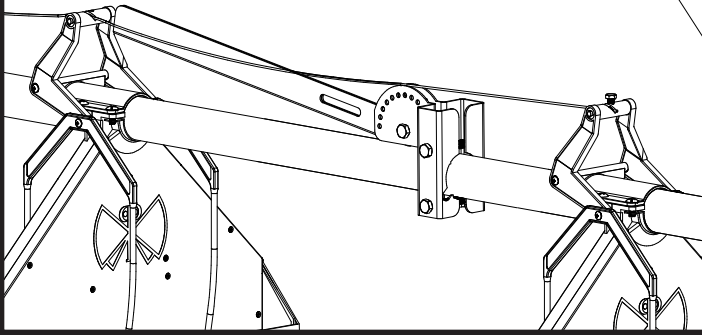

7

Position tray return handle and insert pin into the corresponding hole as shown.

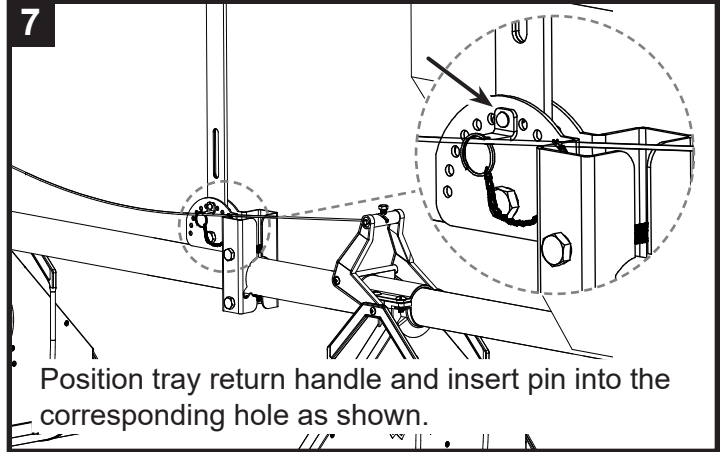

8

Actuator Winch

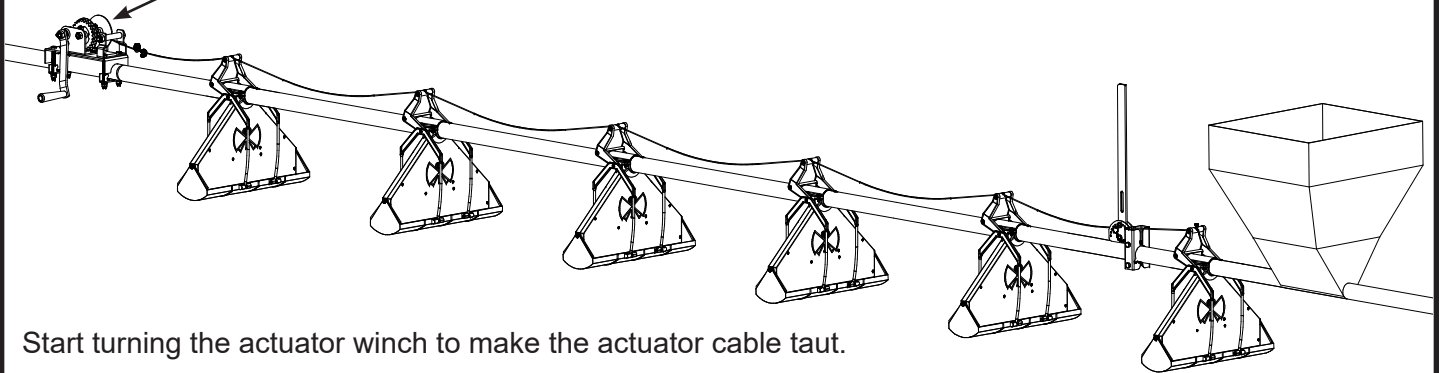

Start turning the actuator winch to make the actuator cable taut.

9

Actuator Winch

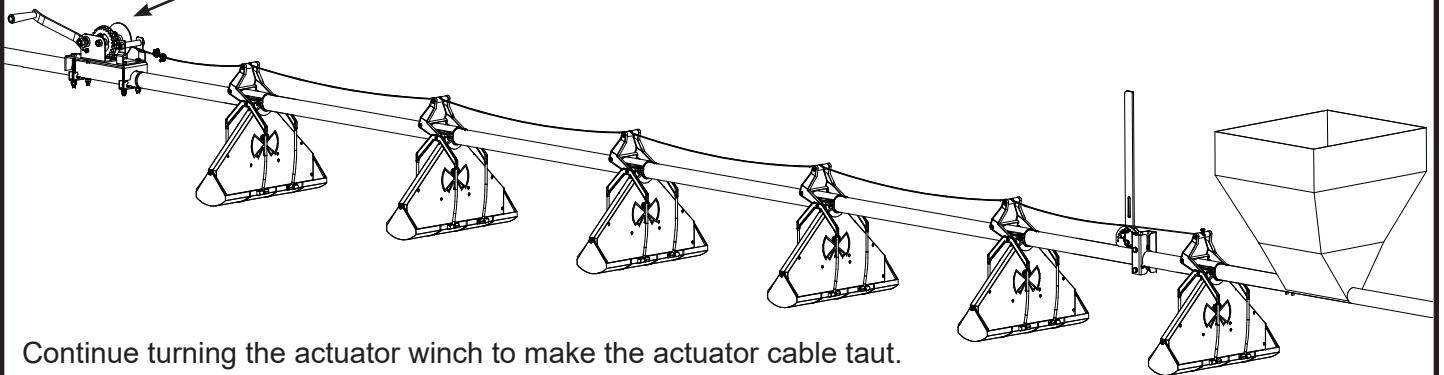

Continue turning the actuator winch to make the actuator cable taut.

10

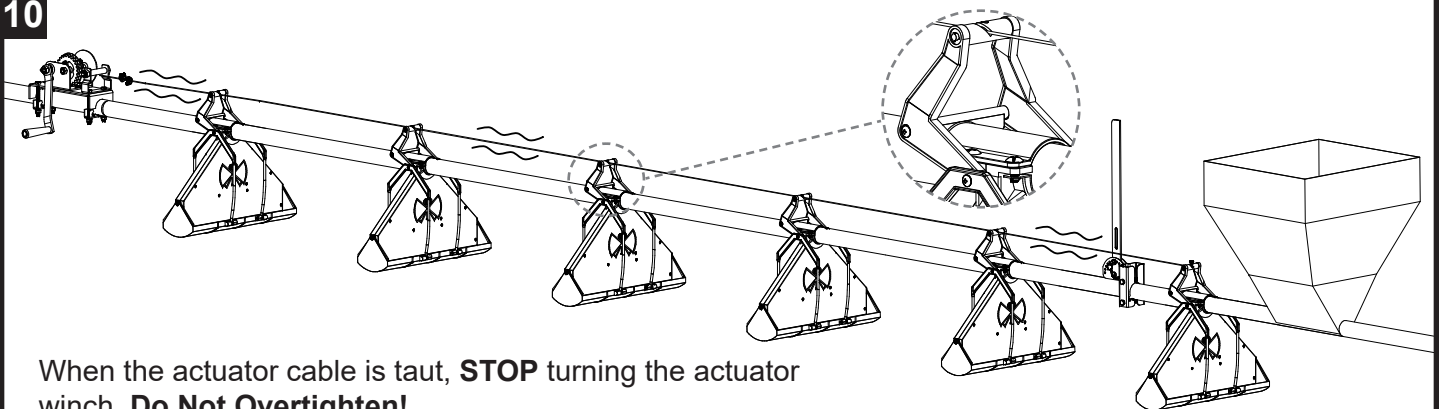

When the actuator cable is taut, **STOP** turning the actuator winch. **Do Not Overtighten!**

TRAY RETURN ASSEMBLY - HANDLE VERSION

11

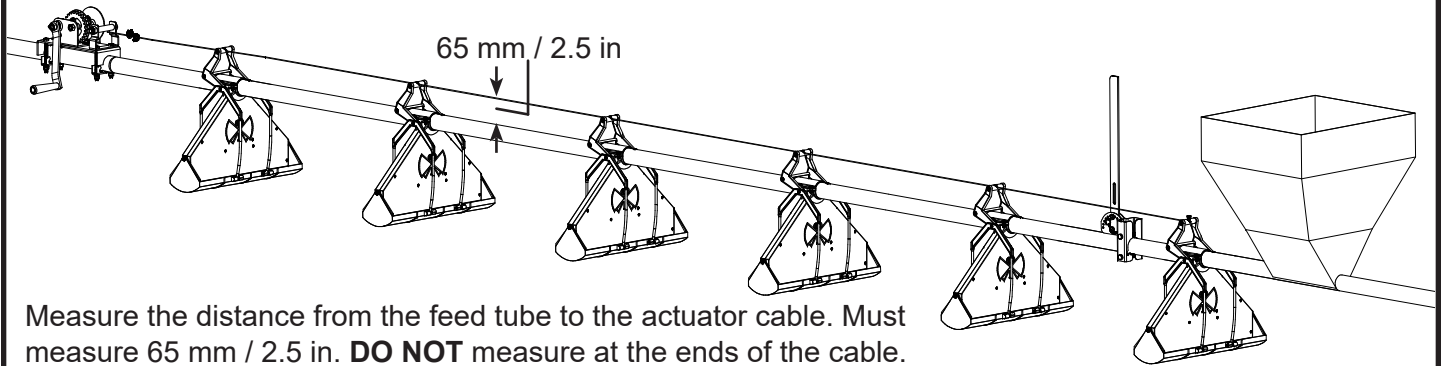

12

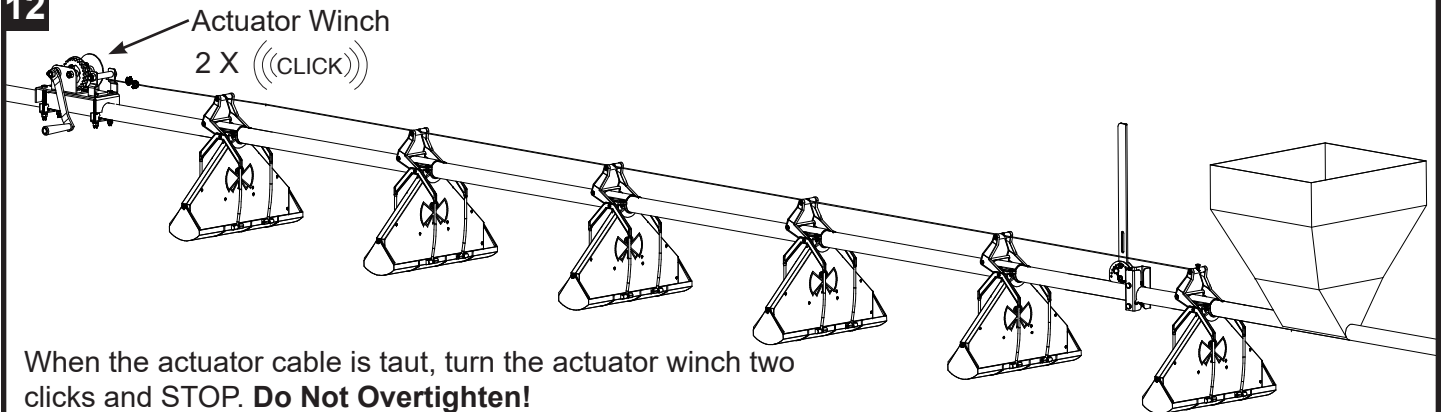

13

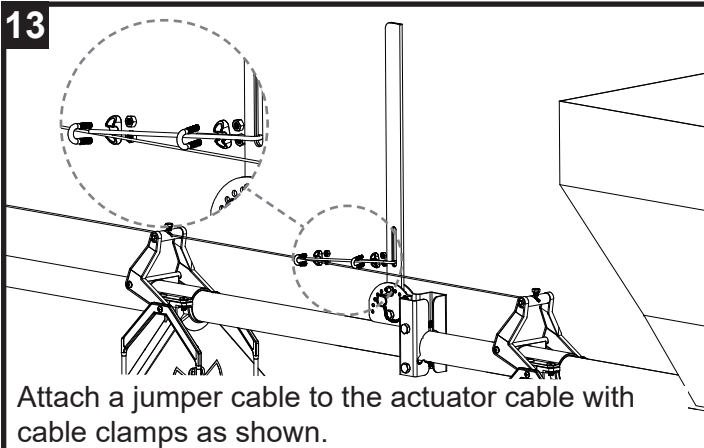

14

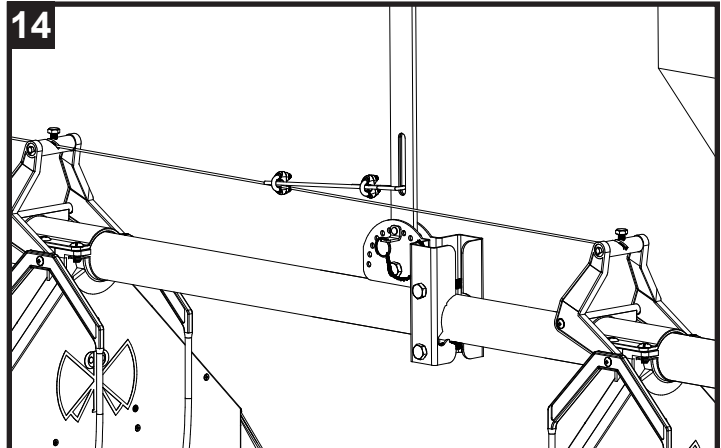

15

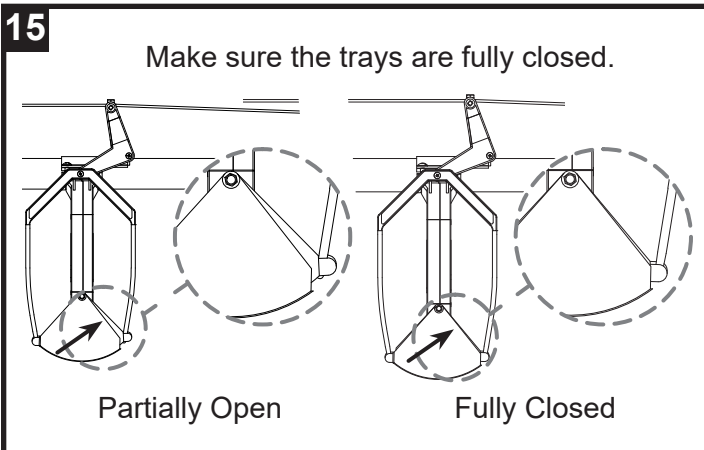

16

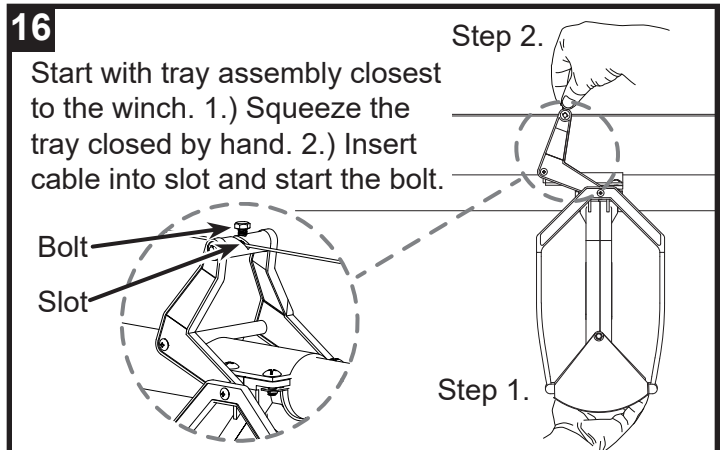

TRAY RETURN ASSEMBLY - HANDLE VERSION

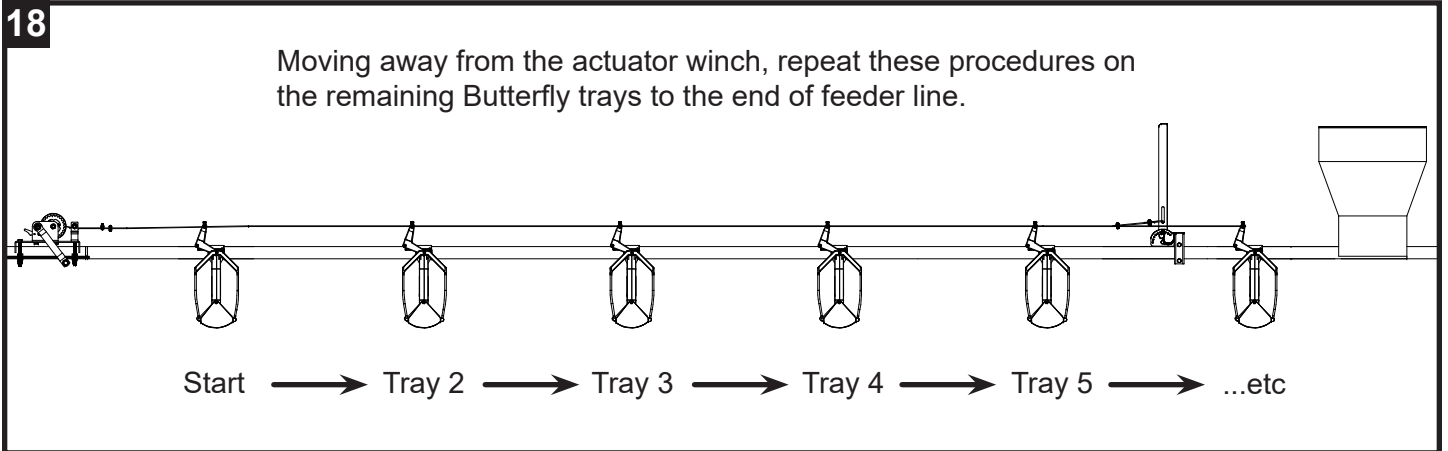
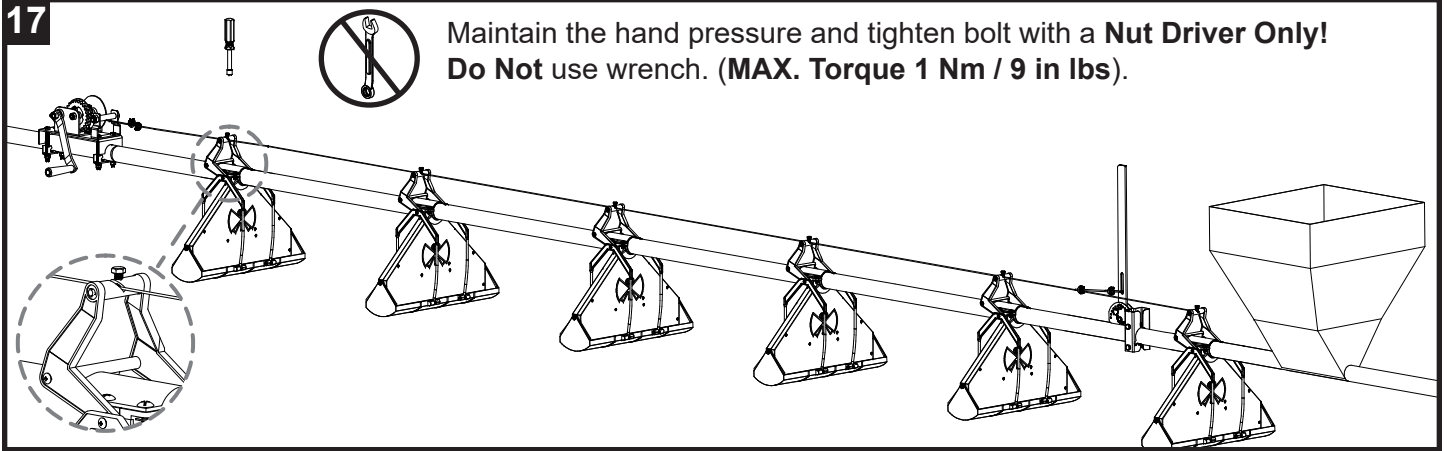

TRAY RETURN ASSEMBLY - SPRING VERSION

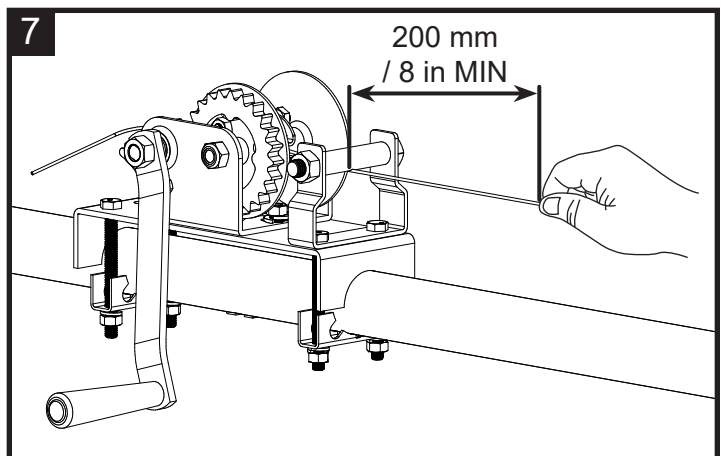
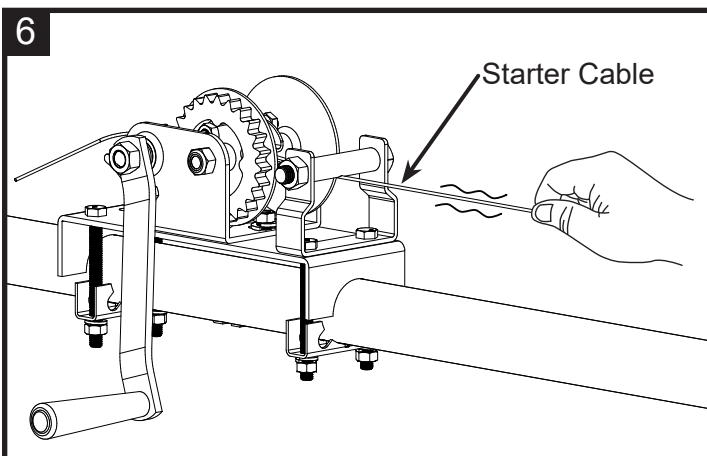
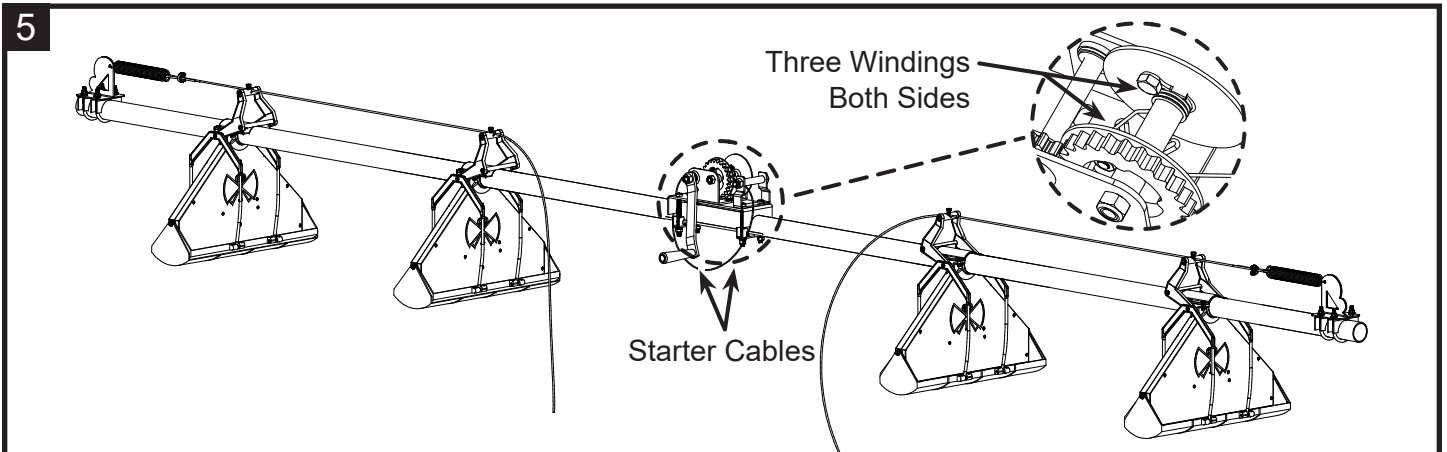
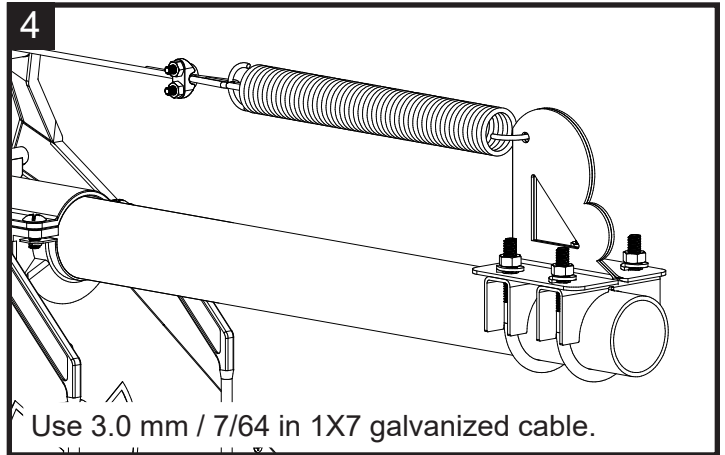
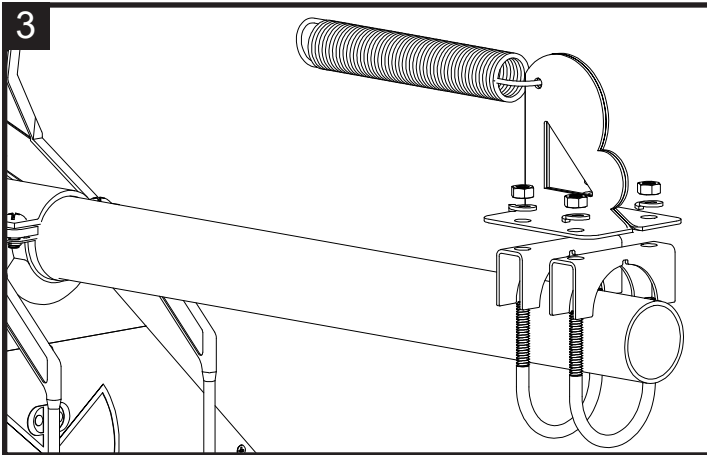
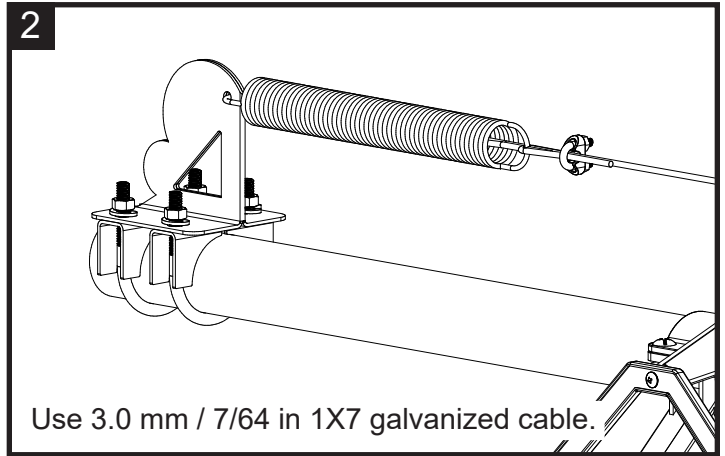
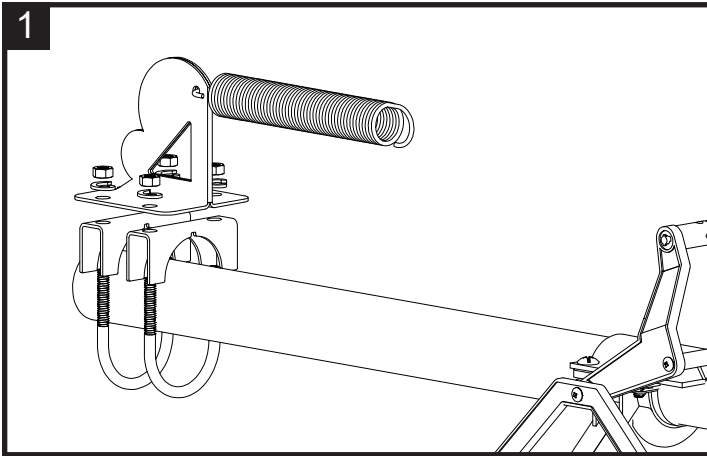

TRAY RETURN ASSEMBLY - SPRING VERSION

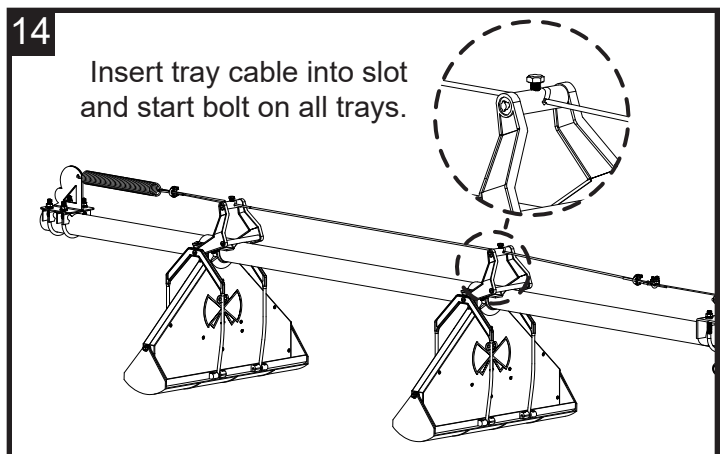
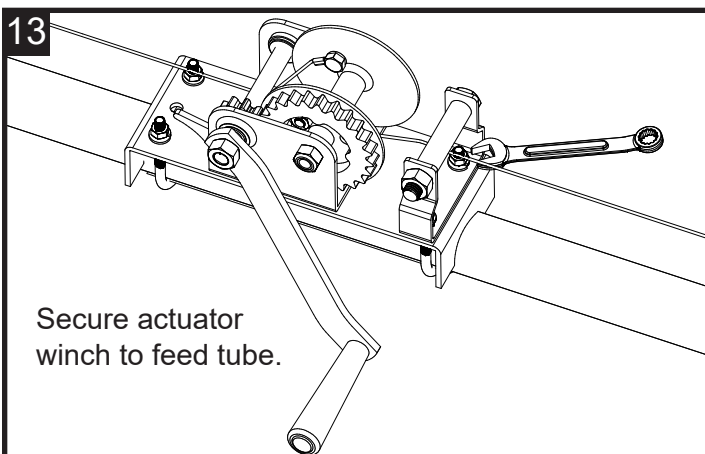
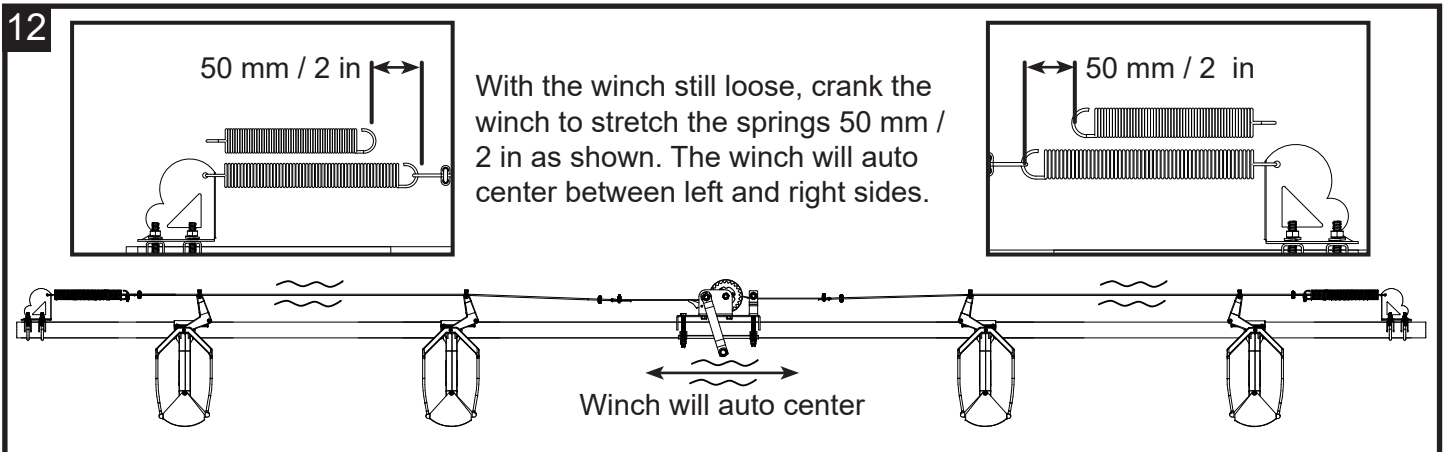
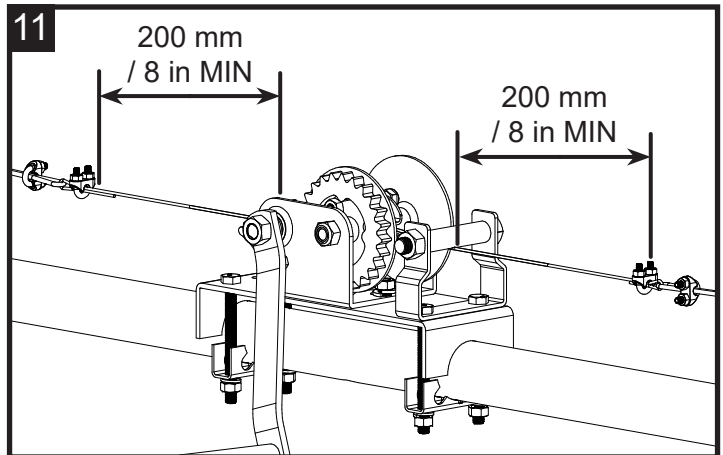
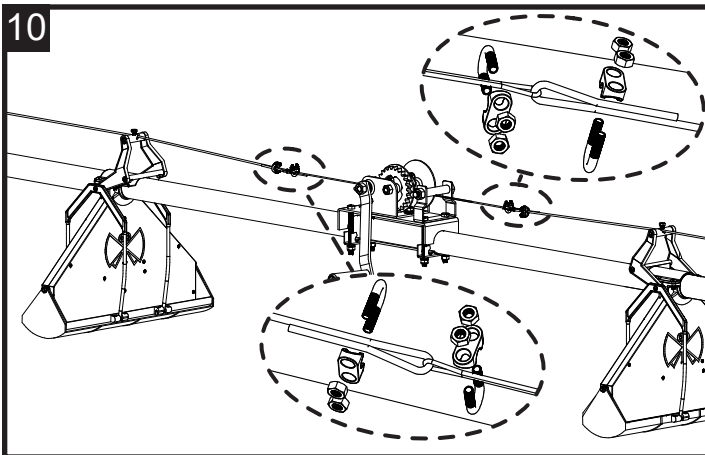
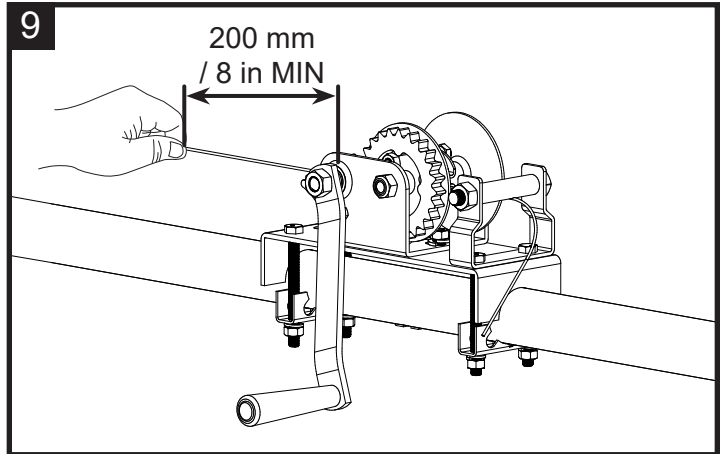
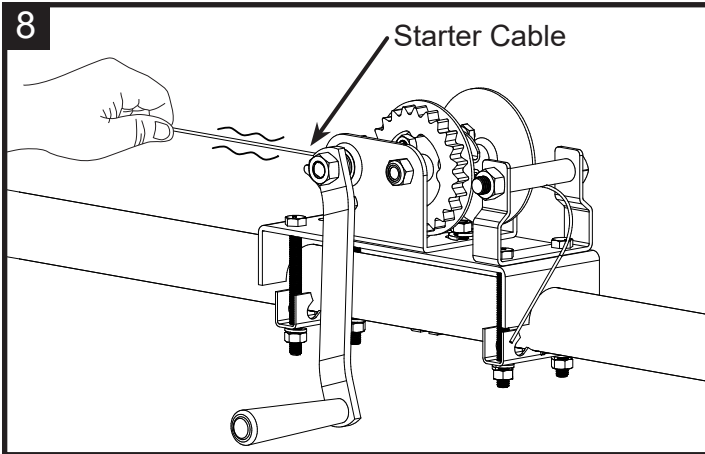

TRAY RETURN ASSEMBLY - SPRING VERSION

15

Start with tray closest to the actuator winch. Push actuator assembly away from the winch to close the tray.

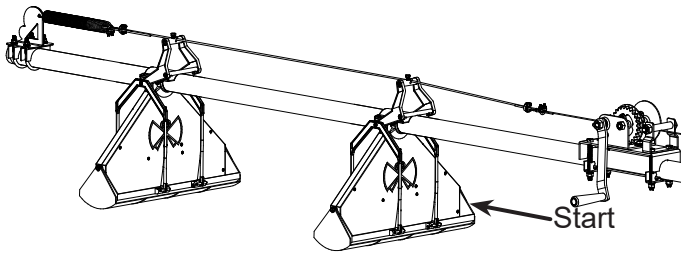

16

Use just enough pressure to fully close the tray. Make sure to use the same amount of pressure on the remaining trays.

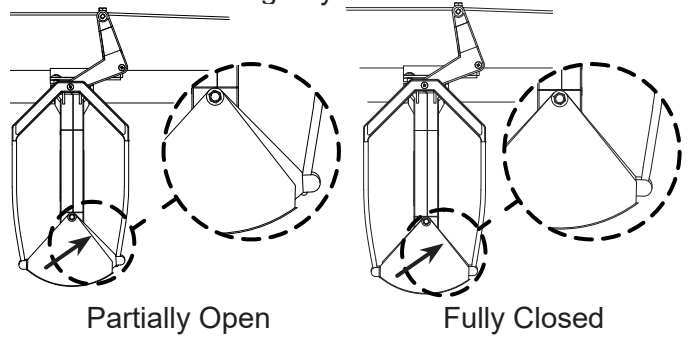

17

Maintaining light pressure, with trays in a fully closed position tighten bolts (**MAX. Torque 1 Nm / 9 in lbs**). Use a nut driver only. Do not use wrench.

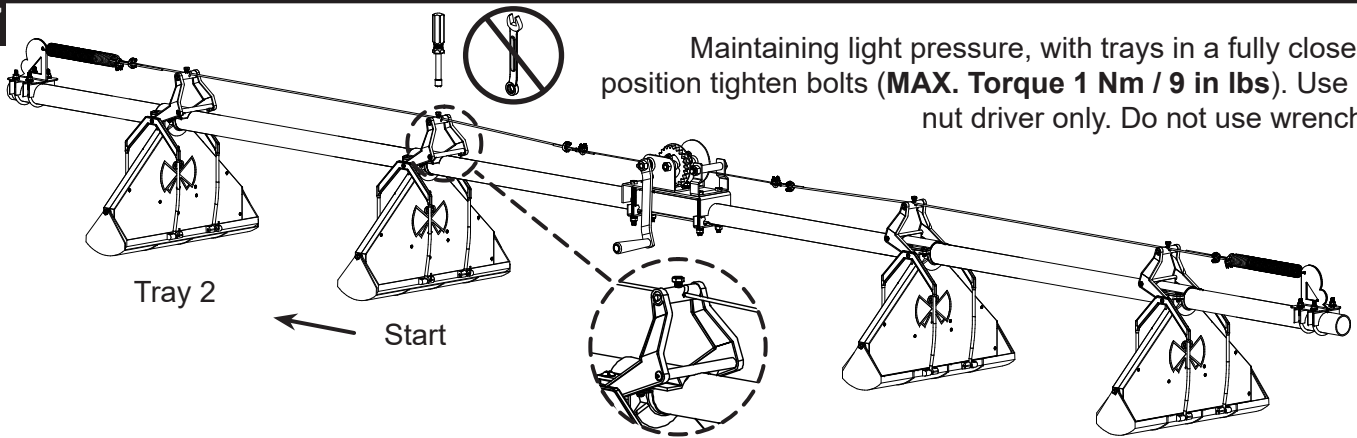

18

Moving away from the winch, repeat procedure on tray 2, 3, 4, and so forth to the end of line. Move to the other side and repeat steps 16 - 19.

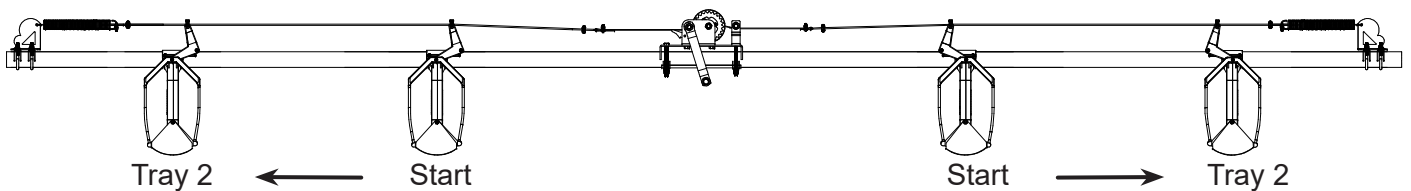

END CONTROL TRAY TO ACTUATOR CABLE INSTALLATION - HANDLE VERSION

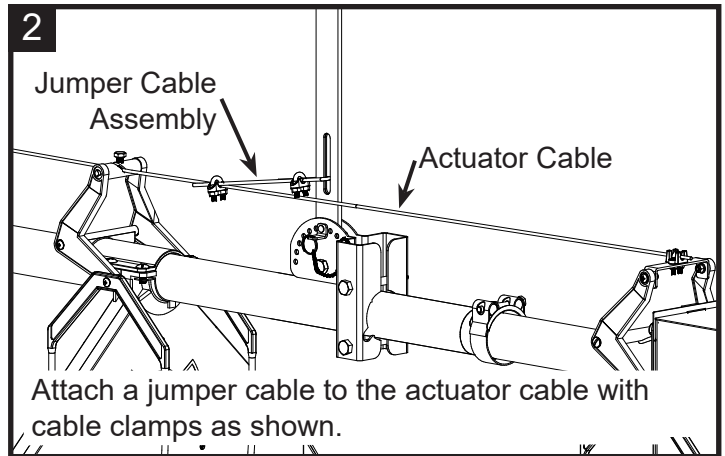
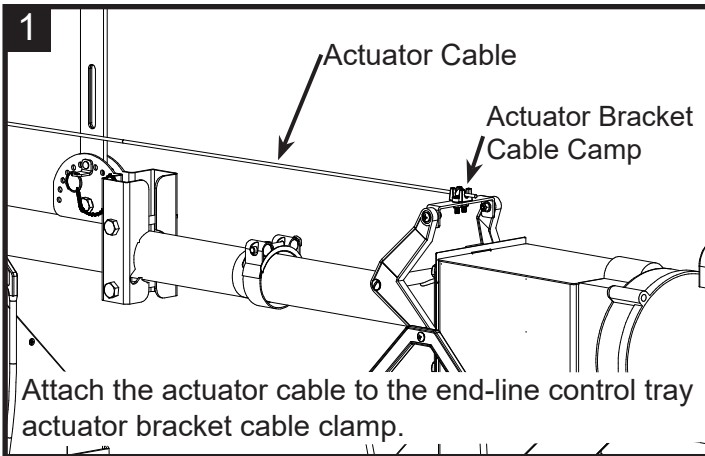

END CONTROL TRAY TO ACTUATOR CABLE INSTALLATION - SPRING VERSION

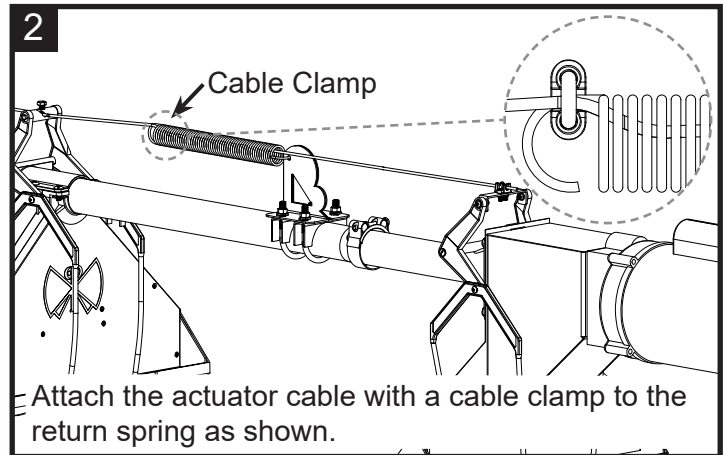
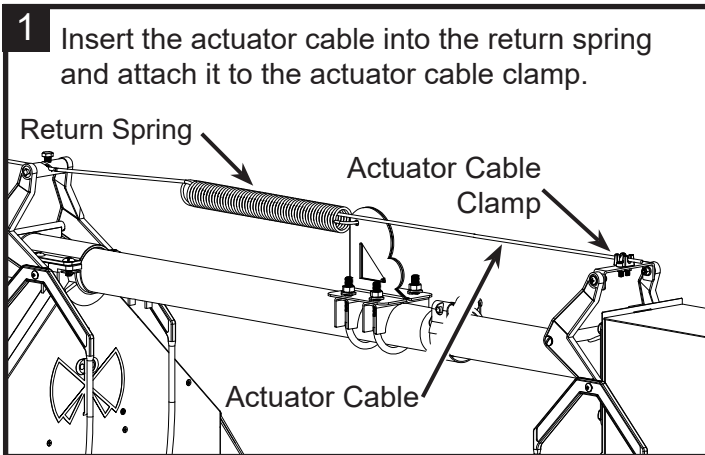

FEED TUBE HANGER LOCATION

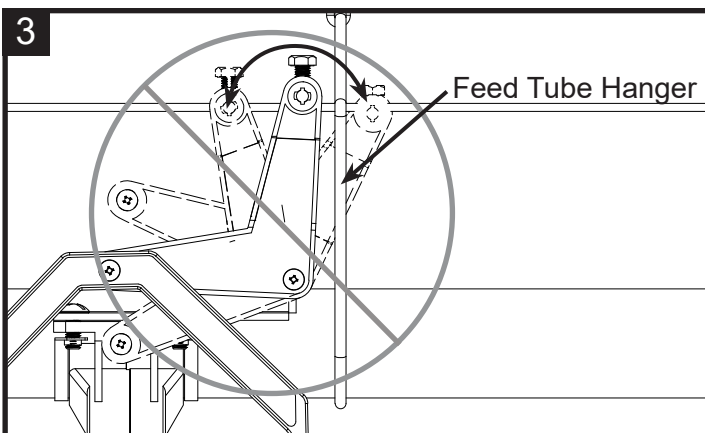
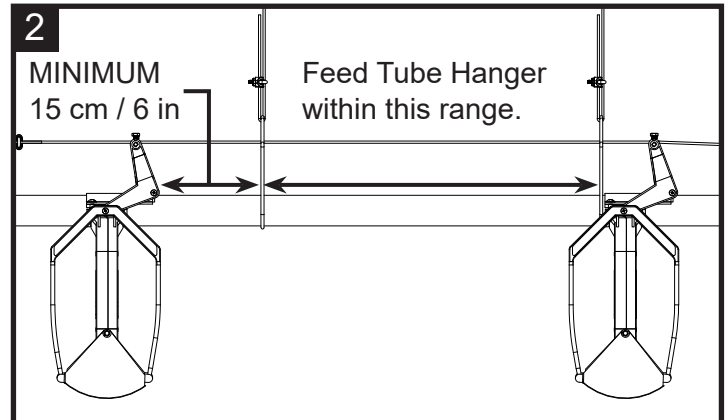
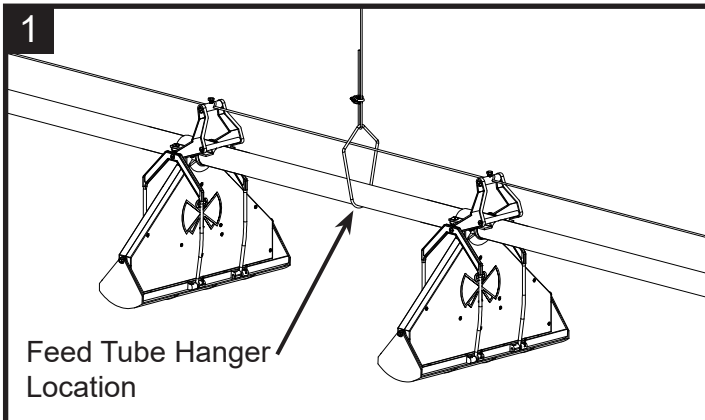

IMPORTANT INSTRUCTIONS

1

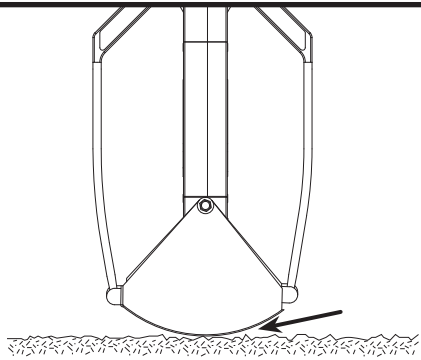

The bottom of the butterfly tray should only touch the litter.

2

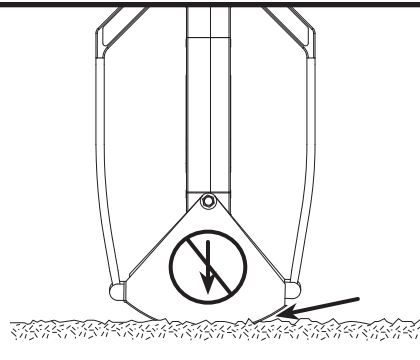

Do not put any weight or upward pressure on the feed tray.

3

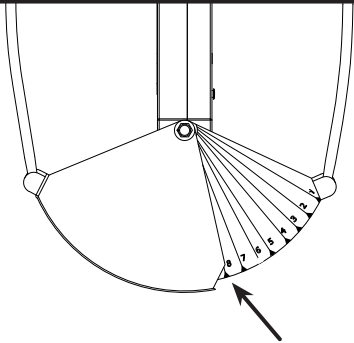

Never adjust the trays wider than the position 8 during the production cycles.

4

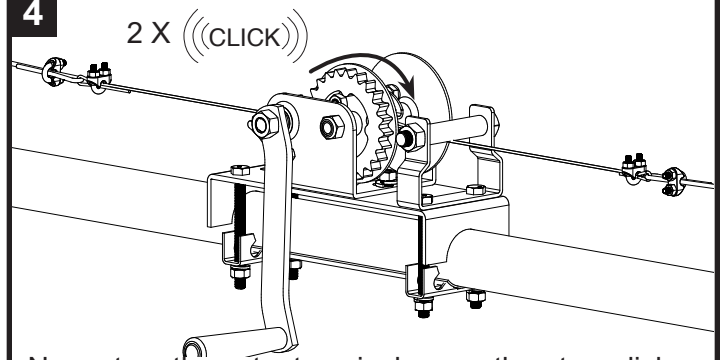

Never turn the actuator winch more than two clicks per day when adjusting the tray opening.

5

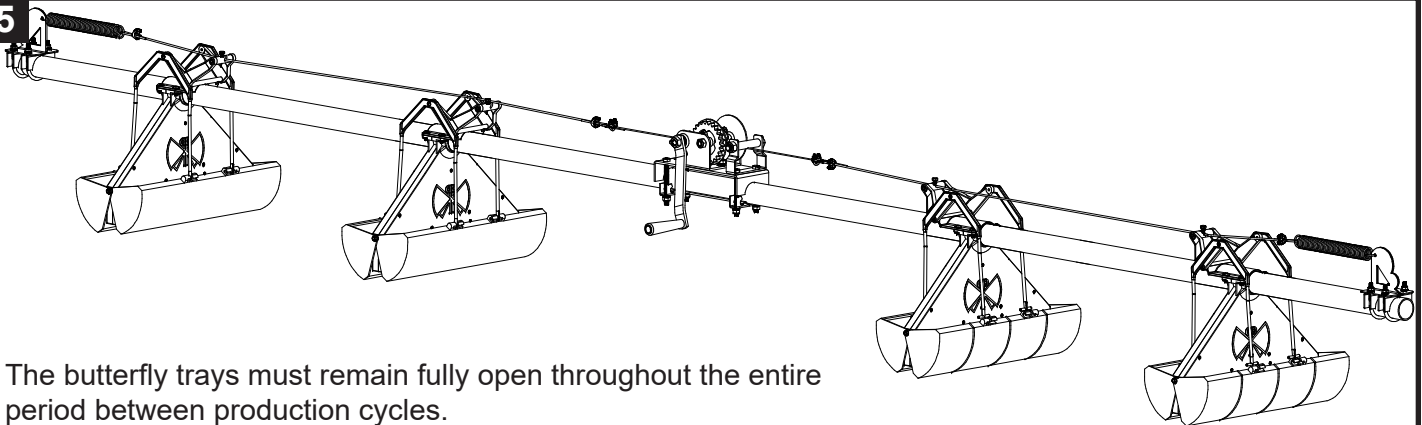

The butterfly trays must remain fully open throughout the entire period between production cycles.

TRAY RETURN HANDLE VERSION STARTUP

1

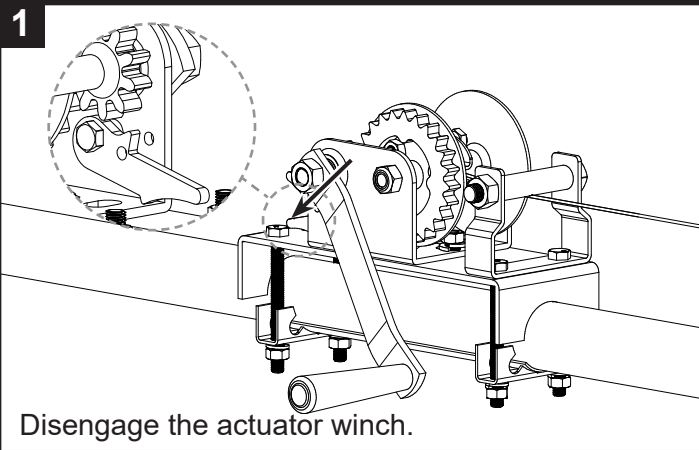

2

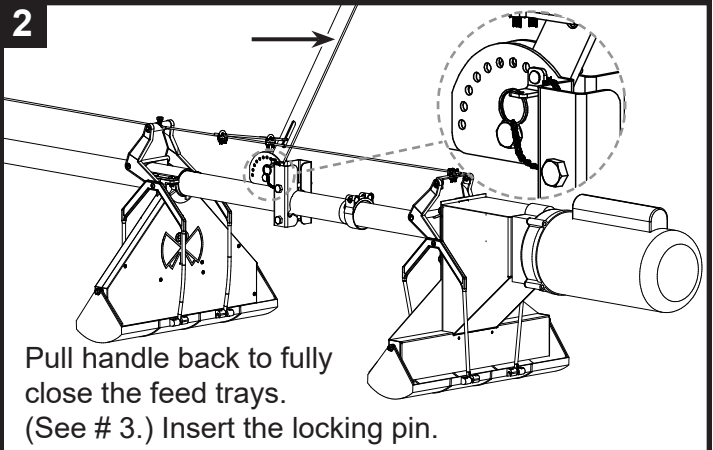

3

Make sure the trays are fully closed.

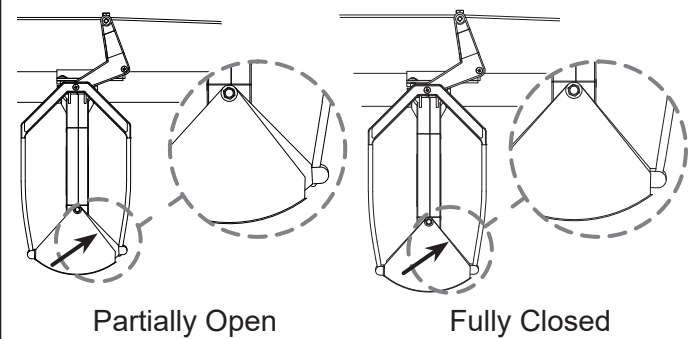

4

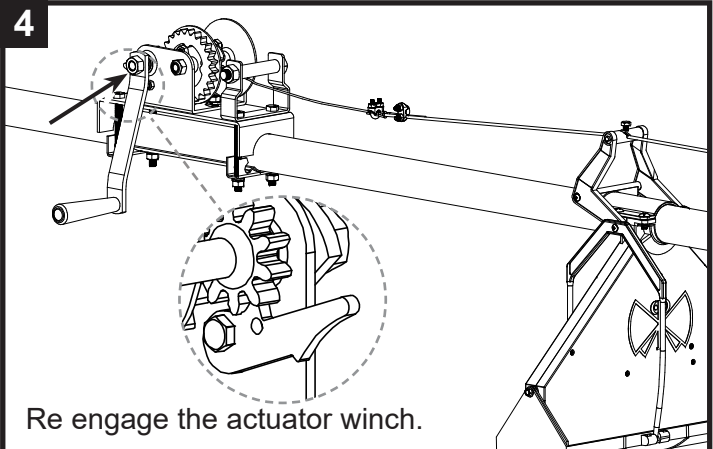

5

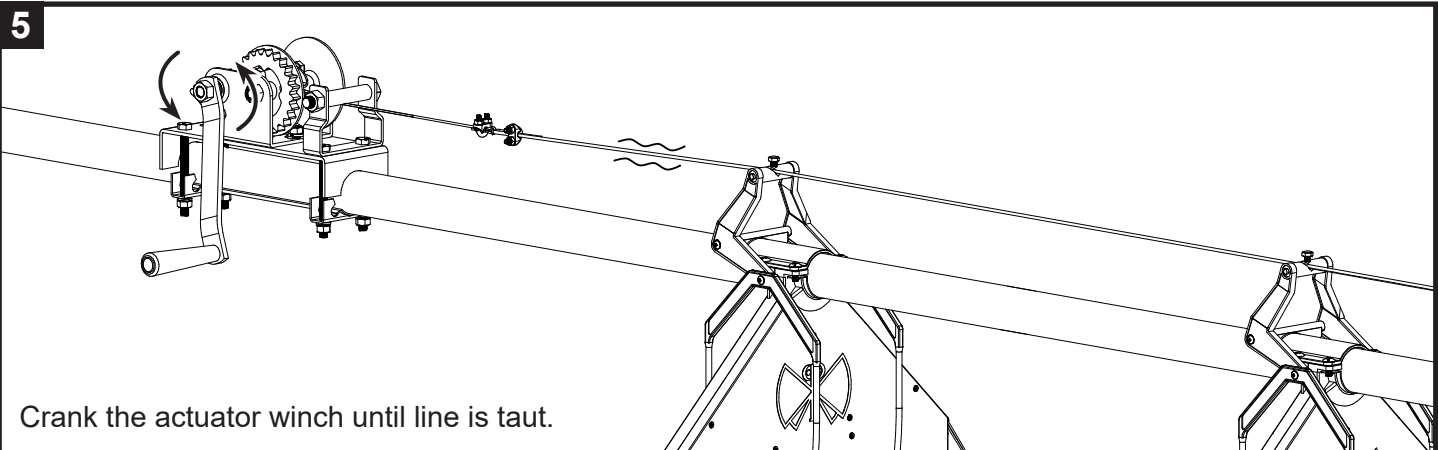

6

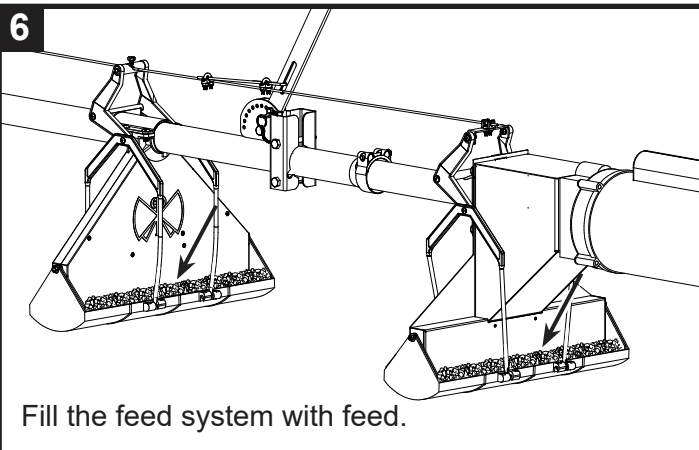

7

