

BUTTERFLY®
CONCEPTS, LLC

**Butterfly Tray
Assembly &
Installation Manual
G3**

WARRANTY INFORMATION

Butterfly Concepts LLC (“Butterfly Concepts”) warrants to the original purchaser of Butterfly Concepts products (“Products”) that for one (1) year from the date of purchase the Products shall be free from defects in materials and workmanship. The sole remedy available to Purchaser shall be the repair or replacement (at Butterfly Concepts’ sole option) of defective Products excluding labor. All replacement and/or repair parts shall be shipped ExWorks Middlebury, Indiana U.S.A or Hsinchu Hsien, 304 Taiwan. This warranty excludes liability for defects in or damage to the Products (both internal and external) caused, directly or indirectly, by misuse (which includes any use or application not specified in Butterfly Concepts’ guidelines or recommendations), neglect, negligence, alteration, accident, corrosive chemicals, unsuitable feed, acts of nature, or failure to (a) follow installation instructions, (b) operating instructions or (c) properly maintain the Products. Replacement parts are only warranted for the remainder of the warranty period for the original part. All replaced Products shall become Butterfly Concepts property. Butterfly Concepts does not warrant nor determine warranty of any item that is manufactured by others such as feed tube, feed auger, motors, gear boxes, switches, winches, etc. Such items are warranted separately by the manufacturer, if at all.

Butterfly Concepts makes no other representations or warranties of any kind except as expressly stated herein. Butterfly Concepts disclaims any and all implied warranties including the warranty of merchantability and the warranty of suitability for a particular purpose. To the fullest extent permitted by applicable law, Butterfly Concepts shall not be liable to purchaser for any consequential, incidental, exemplary, punitive, special, or indirect damages. Butterfly Concepts shall not be liable for any damages that are based on negligence, breach of warranty or strict liability. Except as expressly provided herein, Butterfly Concepts’ liability hereunder shall in no event exceed the purchase price of the defective products. Some countries or regional entities do not allow exclusion or limitation of incidental or consequential damages, so the above exclusion or limitation may not apply to you.

No person including any dealer, distributor, agent, or representative of Butterfly Concepts is authorized to make any representation or warranty concerning Butterfly Concepts products other than as contained herein. Butterfly Concepts reserves the right to change models, make changes to the Products and specifications at any time without notice or obligation.

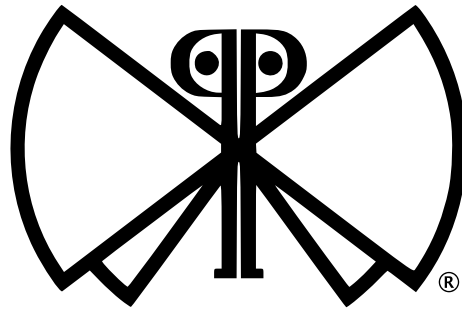

BUTTERFLY[®]

CONCEPTS, LLC

CONTENTS

BUTTERFLY TRAY ASSEMBLY & INSTALLATION MANUAL G3

RECOMMENDED SETUPS

Recommended Butterfly Tray Setups.....	4
--	---

END CONTROL

Actuator Cable	5
End Control Tray Installation	6
Actuator Arm Assembly	8
Optional Actuator Winch Setups.....	9

TRAY ASSEMBLY

Tray Installation	10
Tray Return Assembly - Spring Version.....	12
Actuator Winch Assembly	13
Cable Routing.....	14
Tray Return Assembly - Handle Version.....	16

END CONTROL TO ACTUATOR CABLE

End Control Tray to Actuator Cable Installation - Spring Version	20
End Control Tray to Actuator Cable Installation - Handle Version	20
Feed Tube Hanger Location.....	20

IMPORTANT INSTRUCTIONS

Important Instructions	21
Tray Return Handle Version Startup.....	22

RECOMMENDED BUTTERFLY TRAY SETUPS

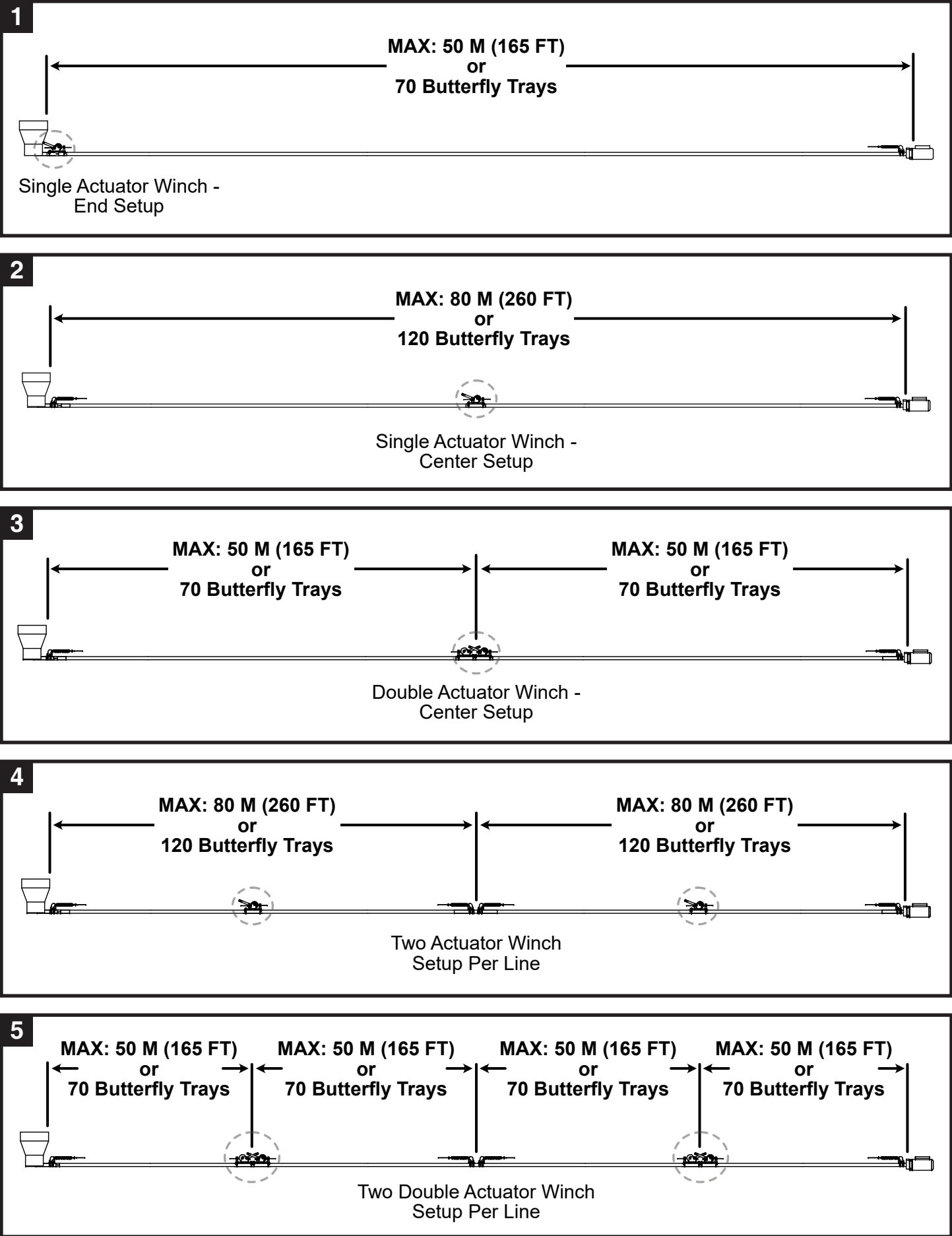

ACTUATOR CABLE

1 **IMPORTANT:** For all system installation, use 3 mm or 7/64 in 1X7 Galvanized Cable only.

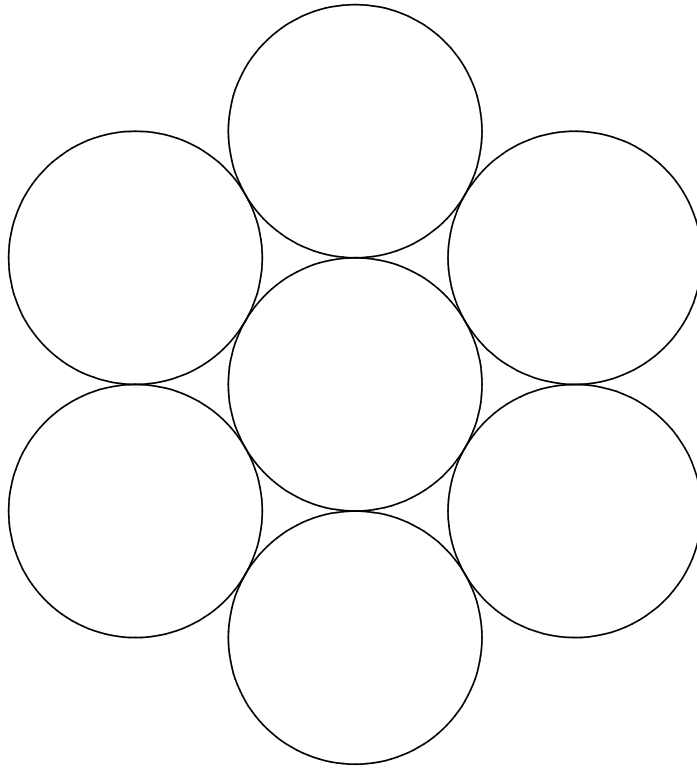

2 **Do Not** use any of these or any other strands.

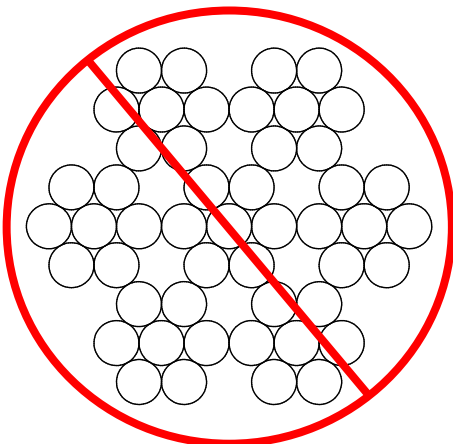

7X7

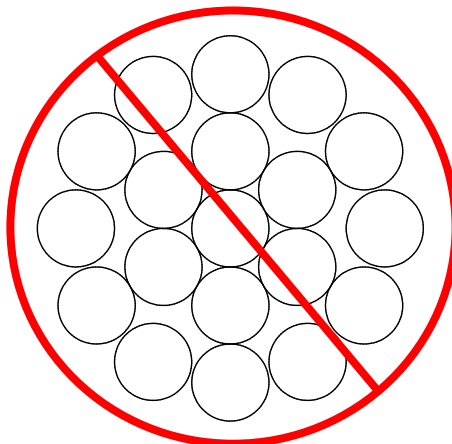

1X19

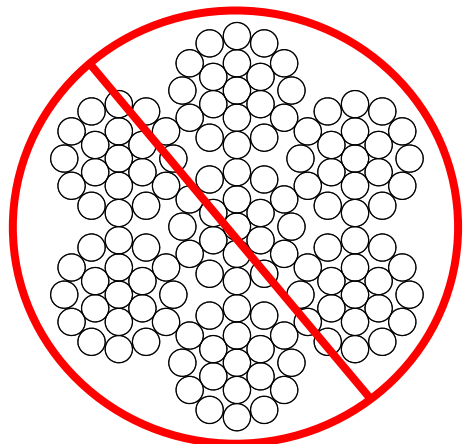

7X19

END CONTROL TRAY INSTALLATION

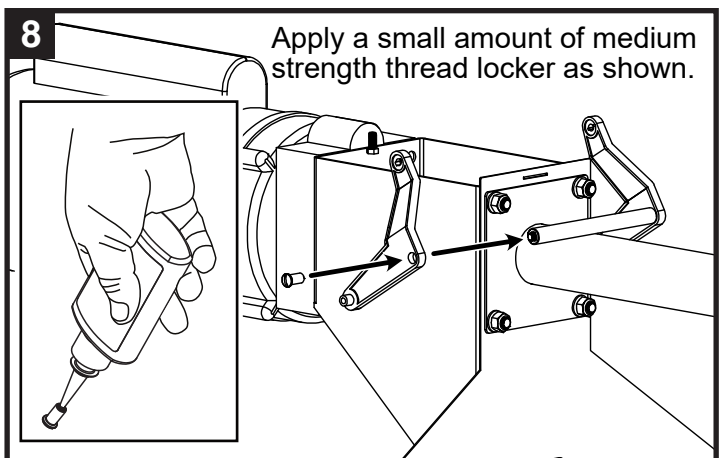
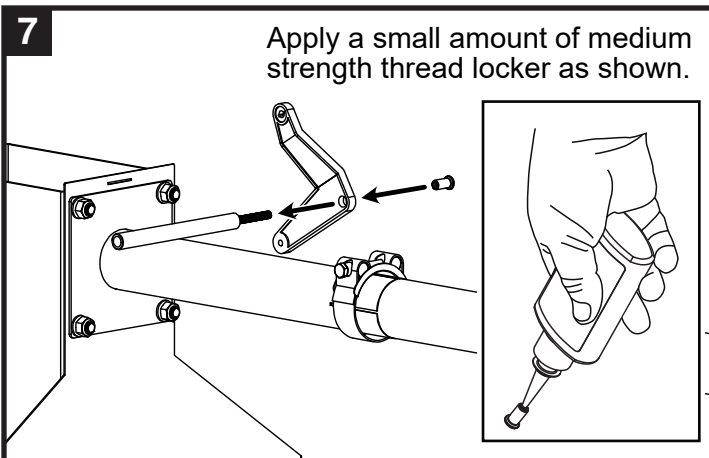
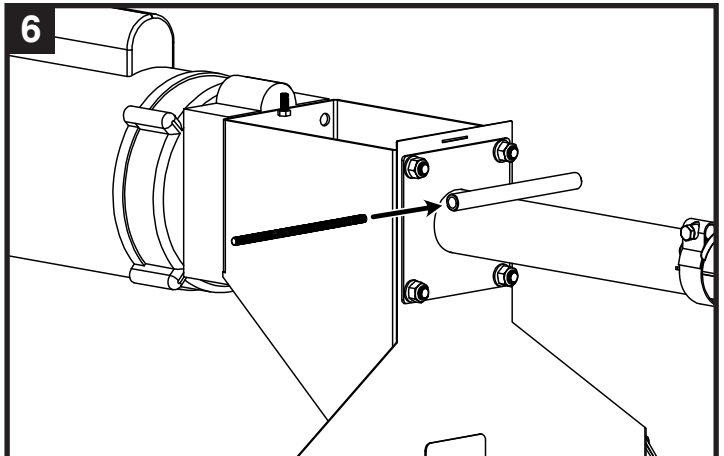
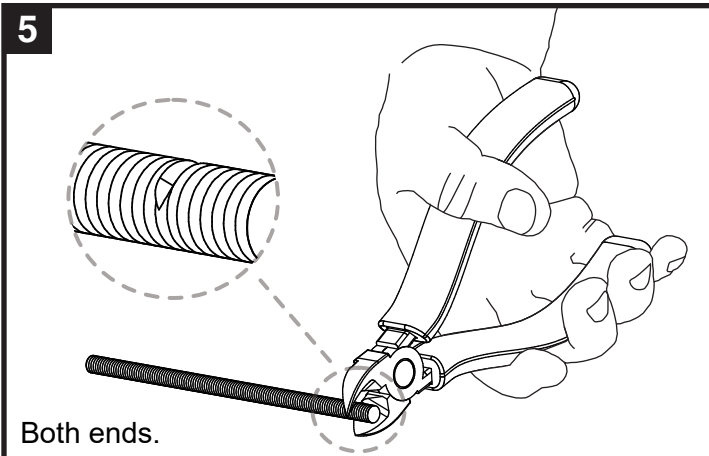
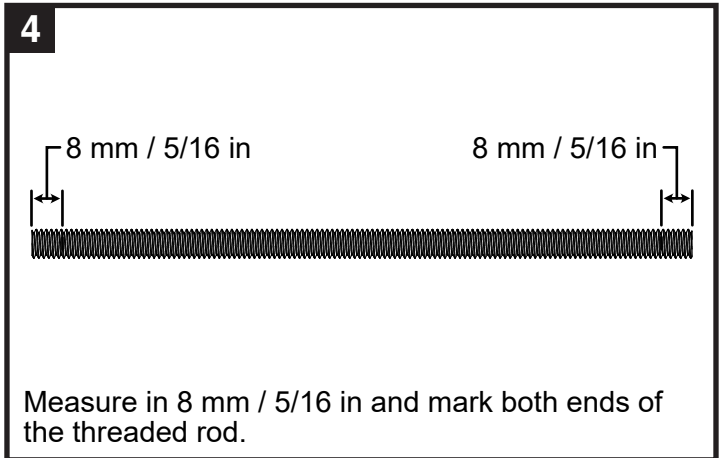
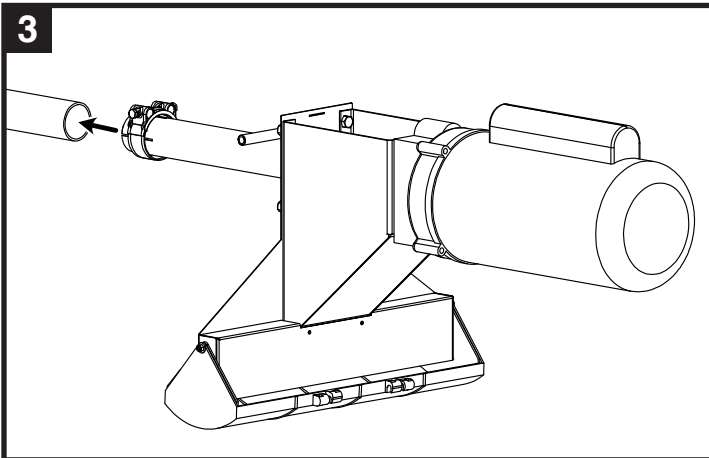
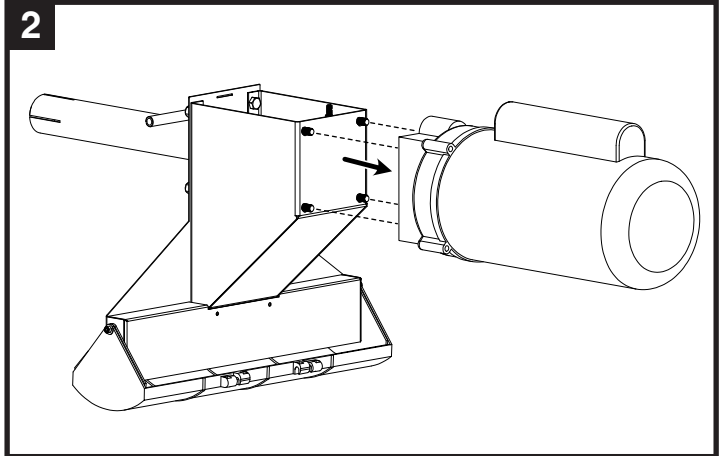
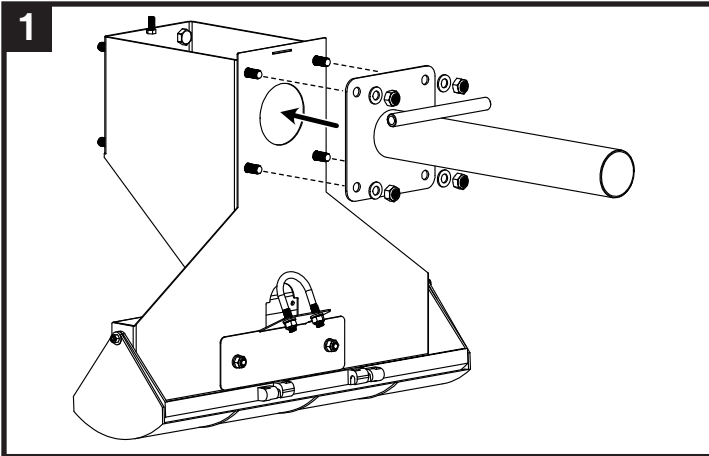

END CONTROL TRAY INSTALLATION

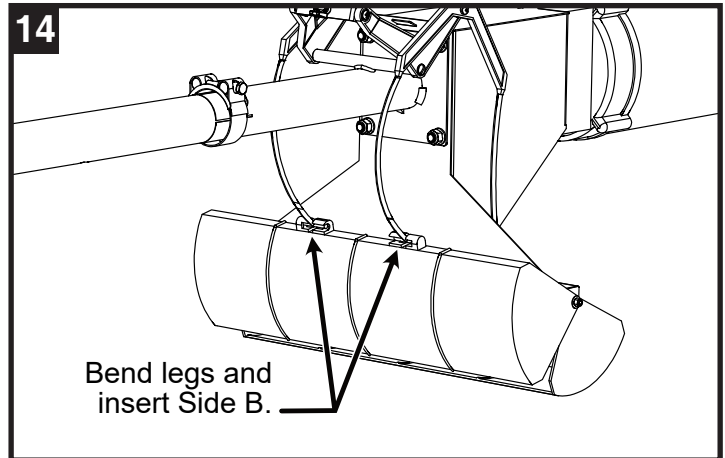
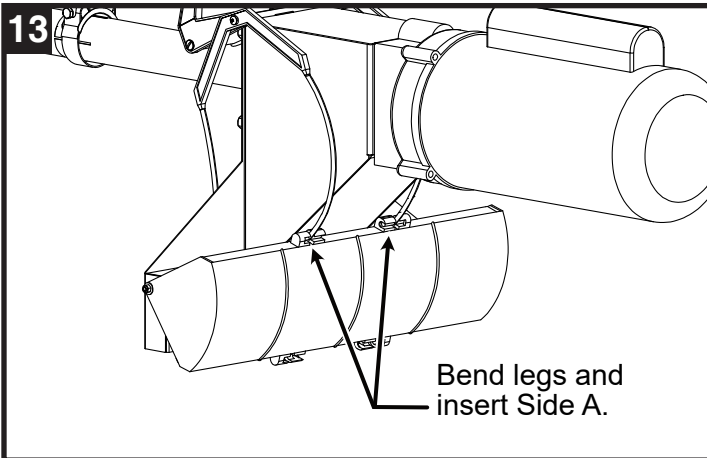
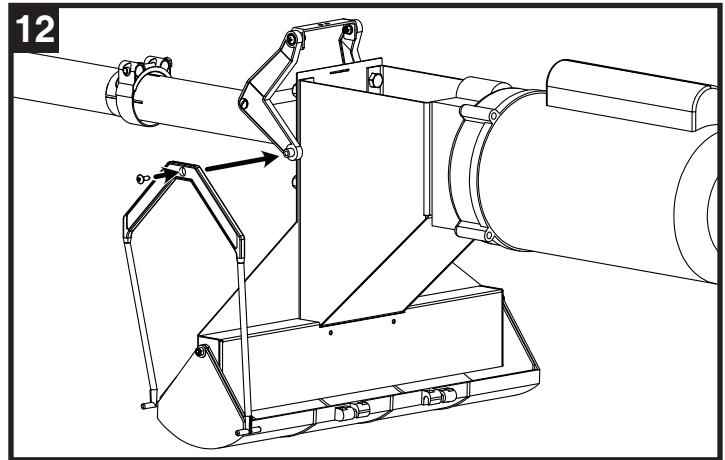
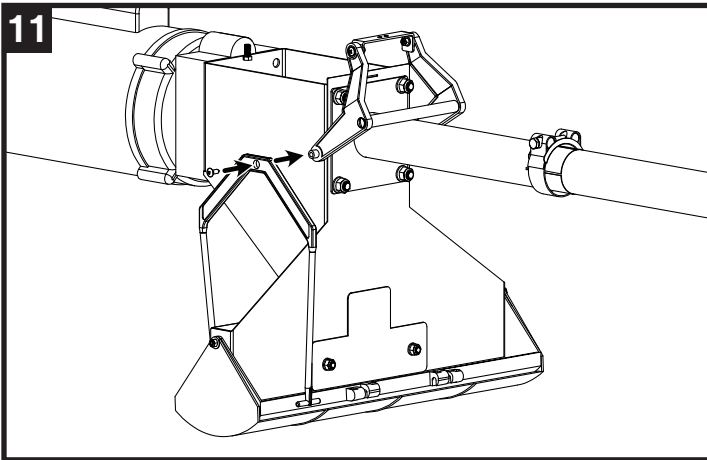
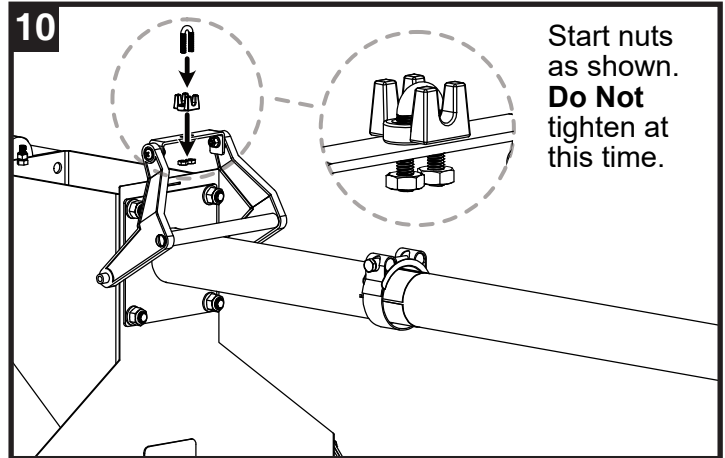
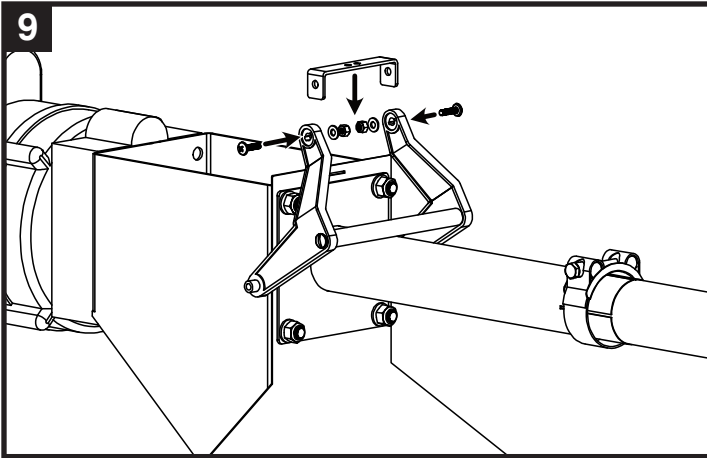

ACTUATOR ARM ASSEMBLY

1

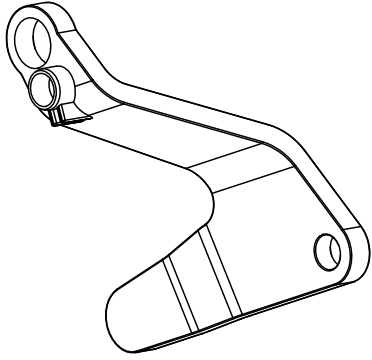

2

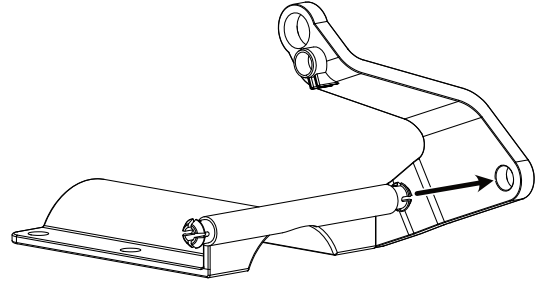

Insert Mounting Bracket into Actuator Arm until snapped.

3

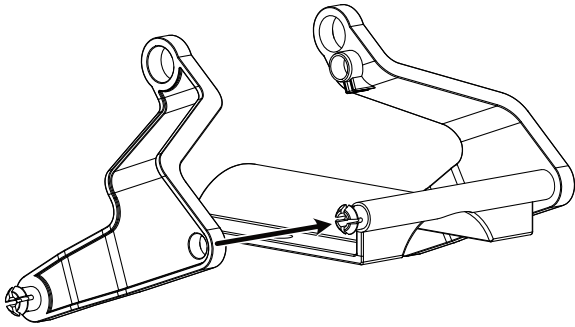

Insert second Actuator Arm onto Mounting Bracket until snapped.

4

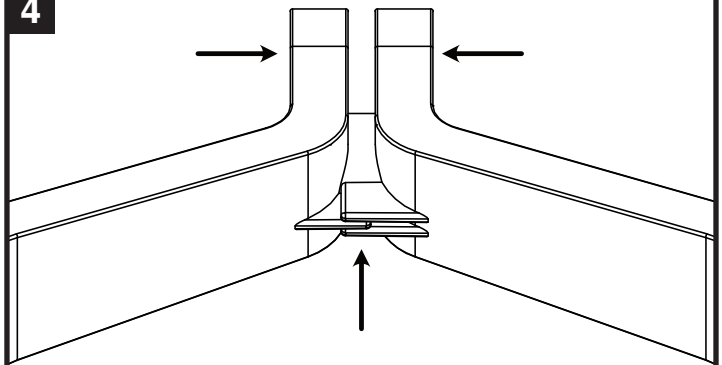

Fix arms until anti-rotation feature is aligned and both arms are pushed together tightly.

5

Actuator Arms should rotate freely around the Mounting Bracket when fully assembled.

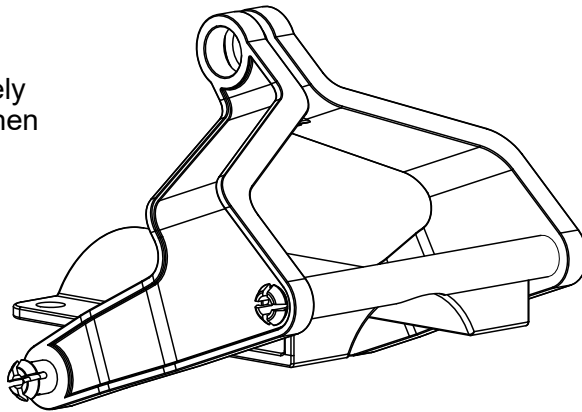

OPTIONAL ACTUATOR WINCH SETUPS (SEE PAGE 2 FOR REFERENCE)

1 Option 1: Actuator Winch Setup

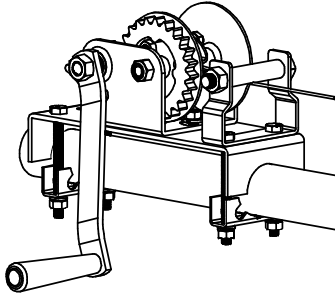

Install actuator winch as shown.

2 Option 2A: 2 Actuator Winch Setup

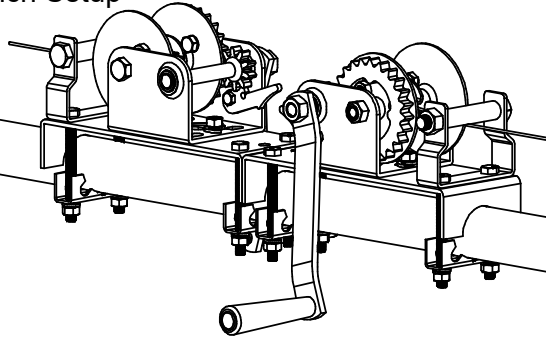

Install actuator winches as shown. This setup is for 3 or 4 trays on 3 M / 10 ft feed tube. Shown on 4 tray feed tube. For 5 trays on 3 M / 10 ft feed tube, see Option 2B.

3 Option 2B: 2 Actuator Winch Setup

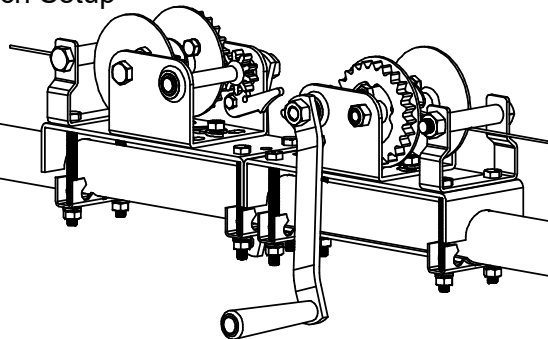

Install actuator winches as shown with cover. This setup is for 5 trays on 3 M / 10 ft feed tube.

4 Option 3: Actuator Winch Setup

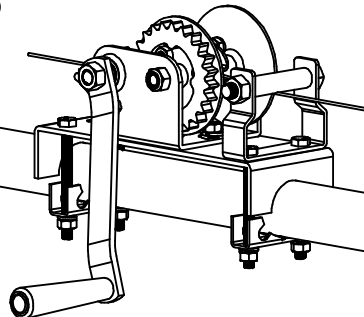

Install actuator winches as shown. Start fasteners, do not tighten at this time.

TRAY INSTALLATION

1

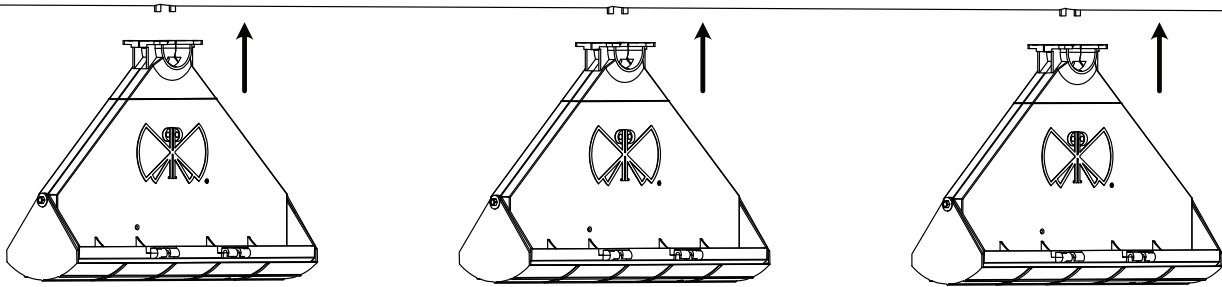

Align Butterfly Trays with the tabs on the conduit.

2

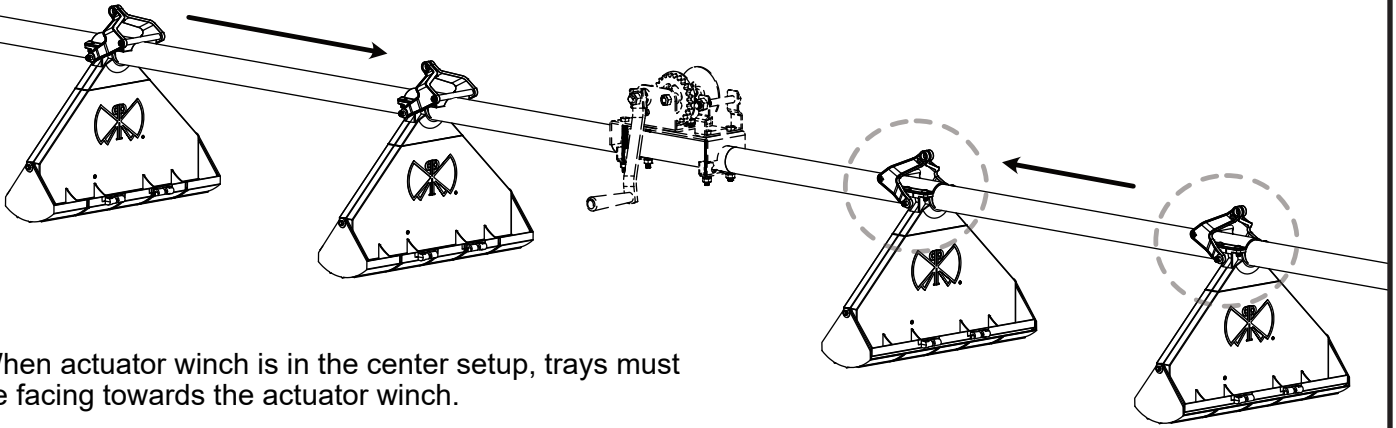

When actuator winch is in the center setup, trays must be facing towards the actuator winch.

3

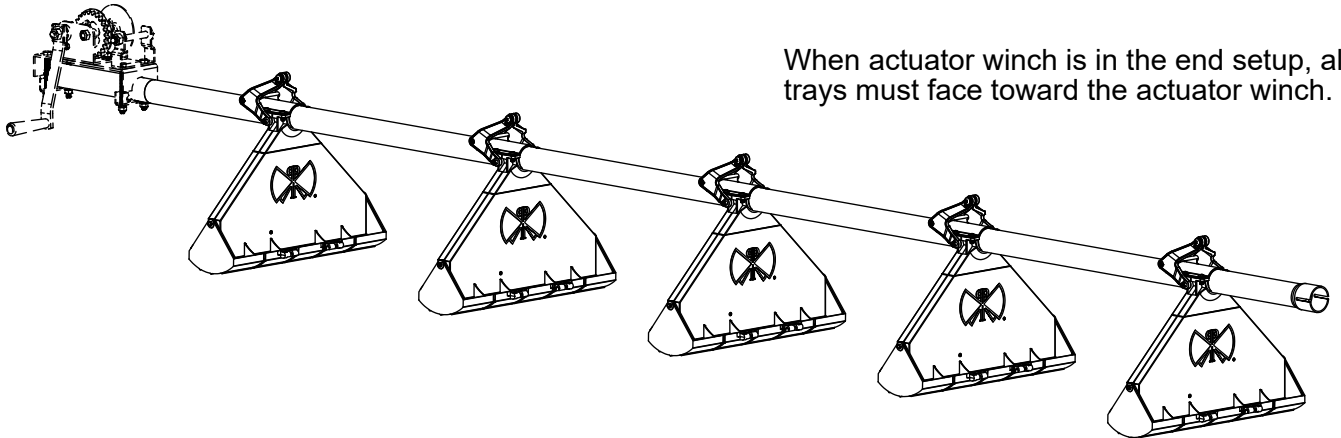

When actuator winch is in the end setup, all trays must face toward the actuator winch.

TRAY INSTALLATION

3

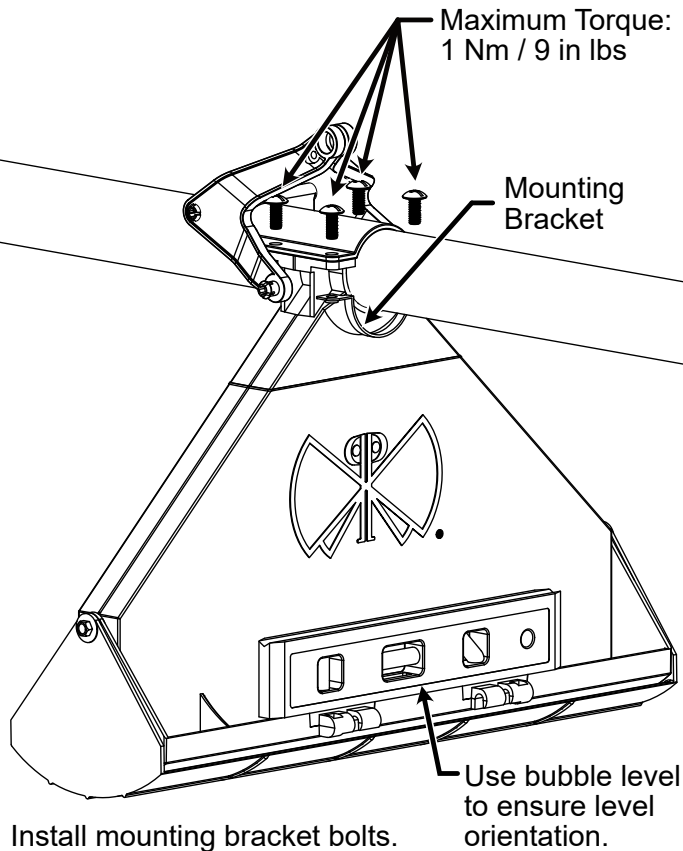

4

Install screw into actuator arm.

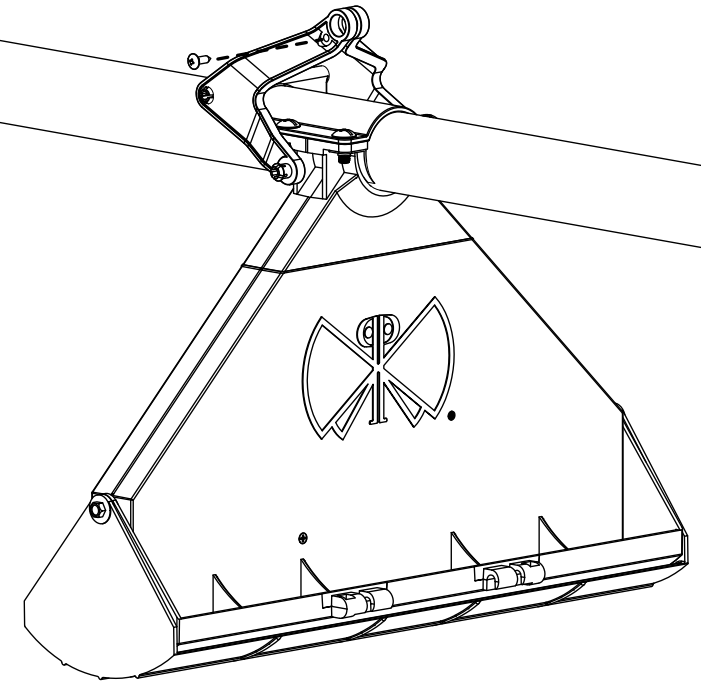

4

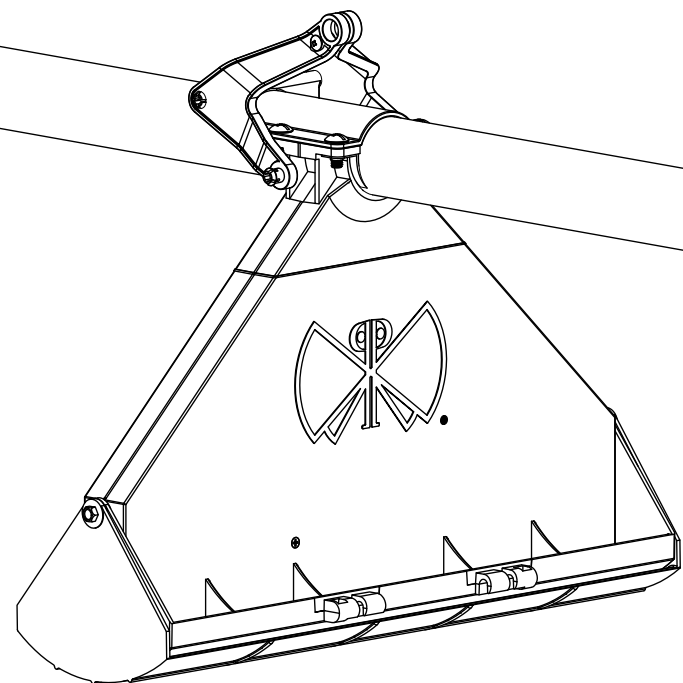

5

Slightly open the Tray and insert the Actuator Arms into Slide A.

Note: Legs can bend for easier installation.

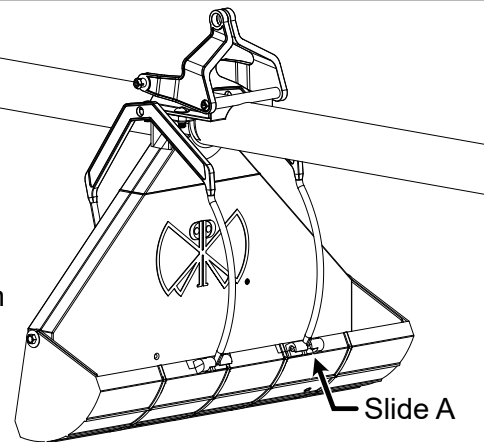

6

Slightly open the Tray and insert the Actuator Arms in Slide B.

Note: Legs can bend for easier installation.

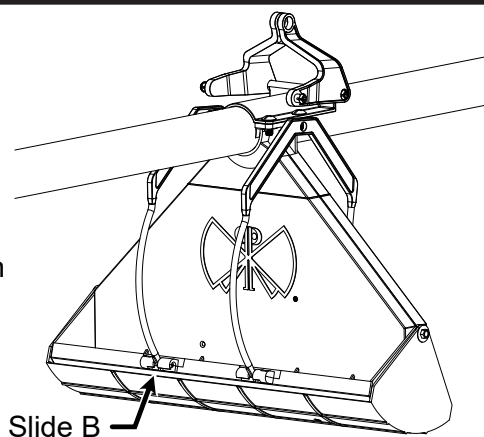

TRAY INSTALLATION

7

Insert Actuator Leg
onto the Actuator
Arm until snapped.

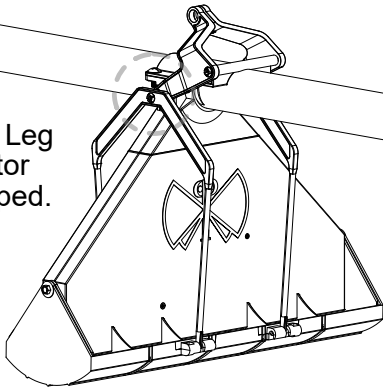

8

Insert the second
Actuator Leg onto the Actuator Arm
until snapped.

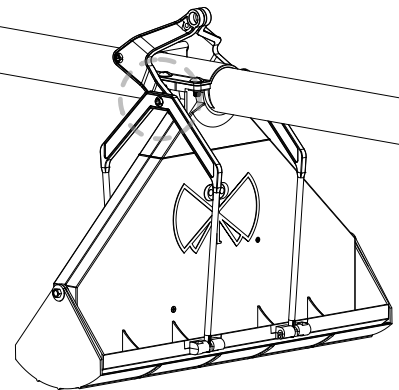

TRAY RETURN ASSEMBLY - SPRING VERSION

1

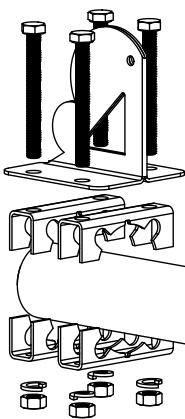

Orientation

2

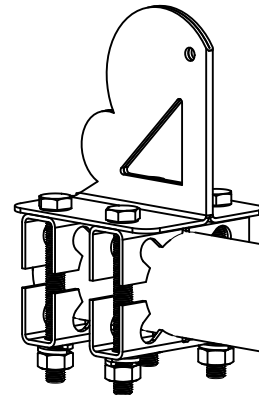

3

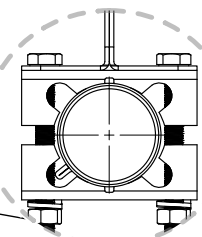

Orientation

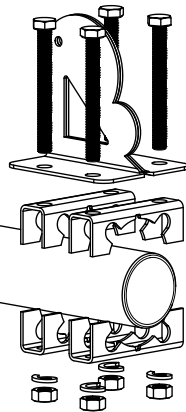

4

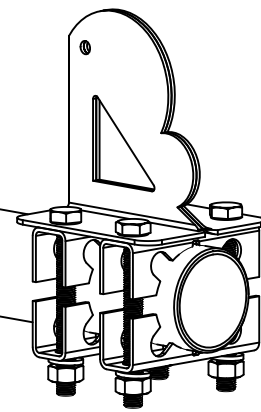

5

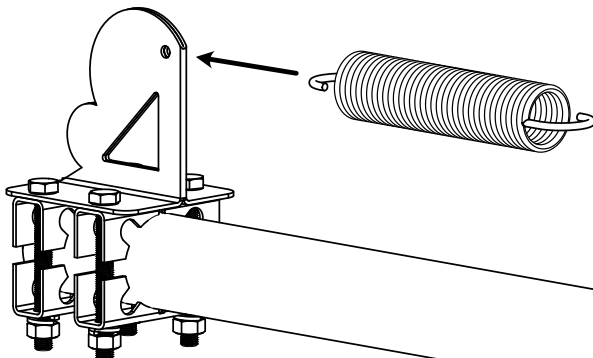

Install spring into the anchor bracket.

6

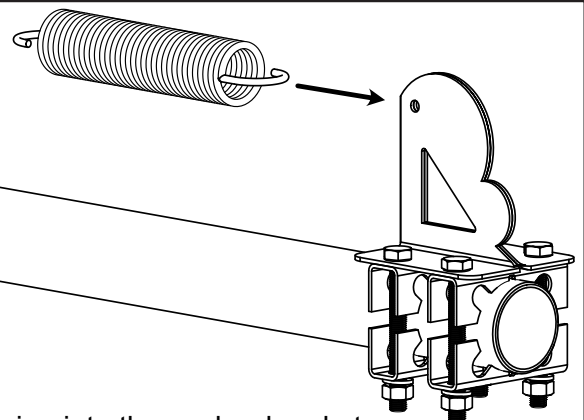

Install spring into the anchor bracket.

7

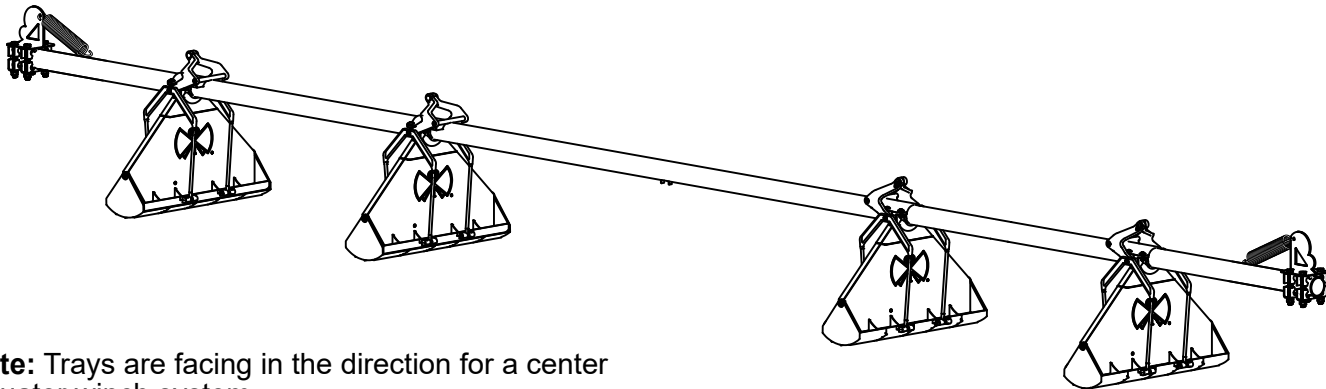

Note: Trays are facing in the direction for a center actuator winch system.

ACTUATOR WINCH ASSEMBLY

1

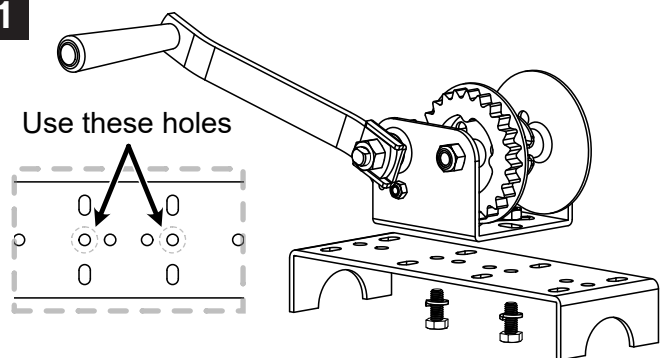

Install Actuator Winch onto the mounting bracket.

2

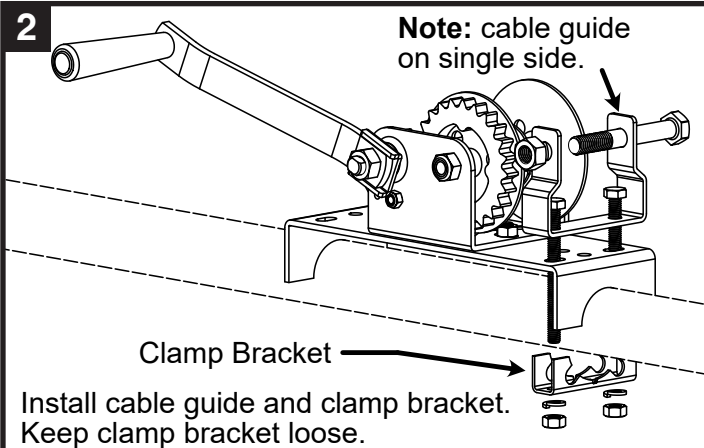

Install cable guide and clamp bracket. Keep clamp bracket loose.

3

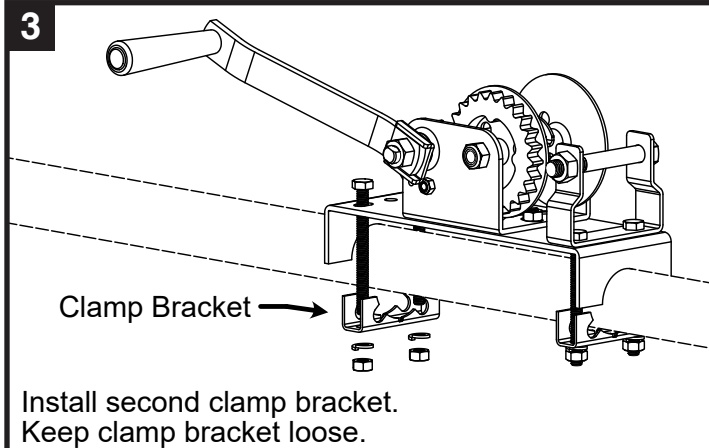

Install second clamp bracket. Keep clamp bracket loose.

4

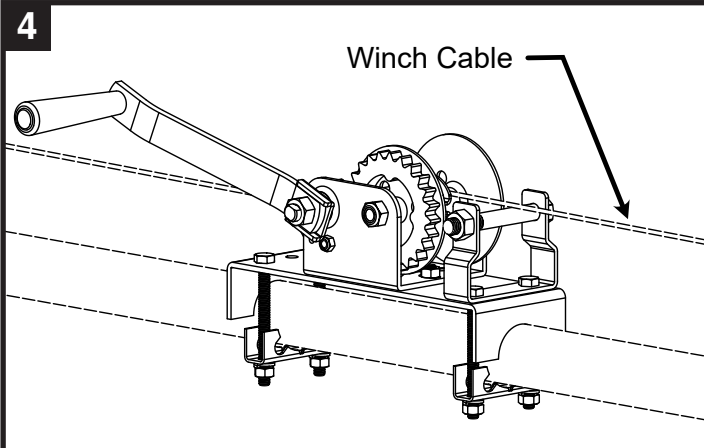

Winch Cable

5

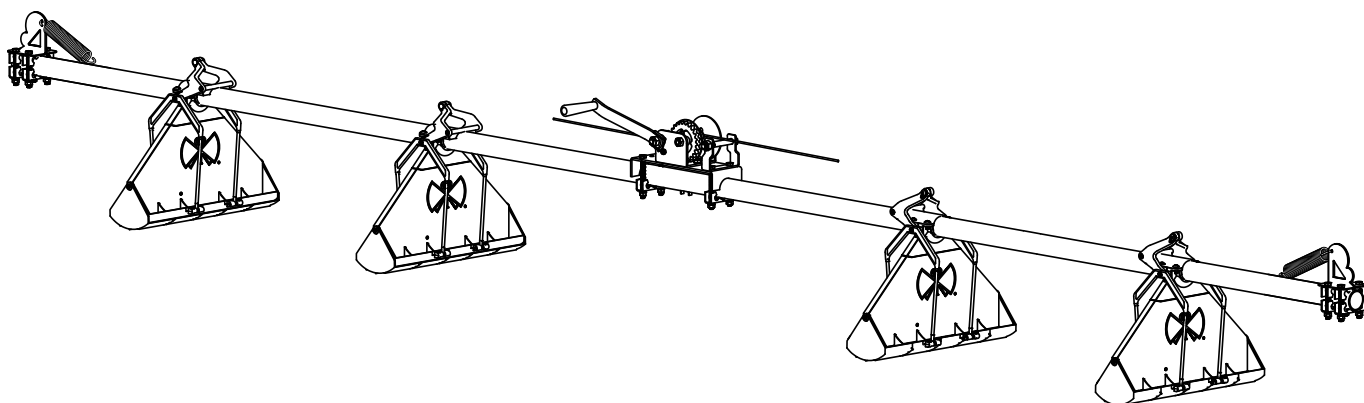

CABLE ROUTING

1

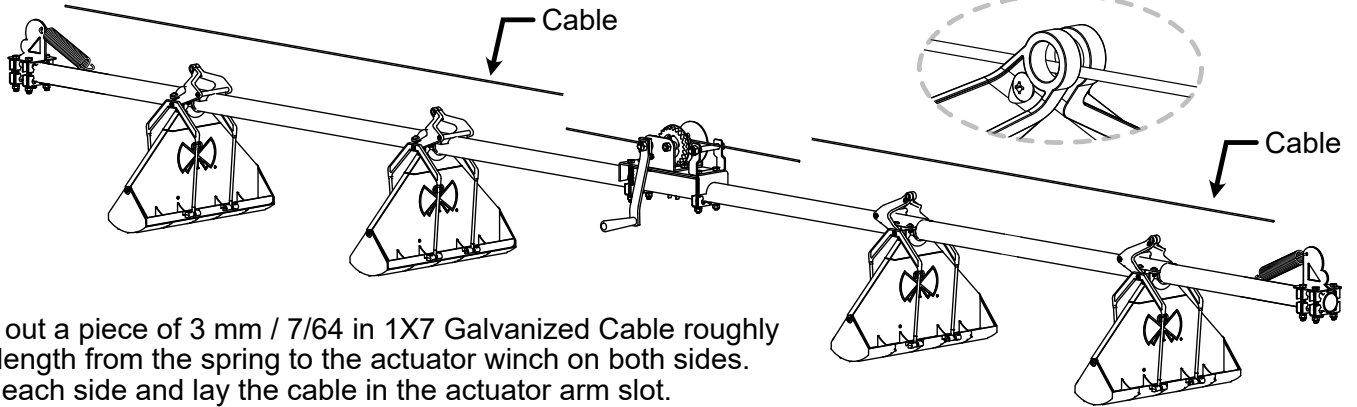

Pull out a piece of 3 mm / 7/64 in 1X7 Galvanized Cable roughly the length from the spring to the actuator winch on both sides. Cut each side and lay the cable in the actuator arm slot.

2

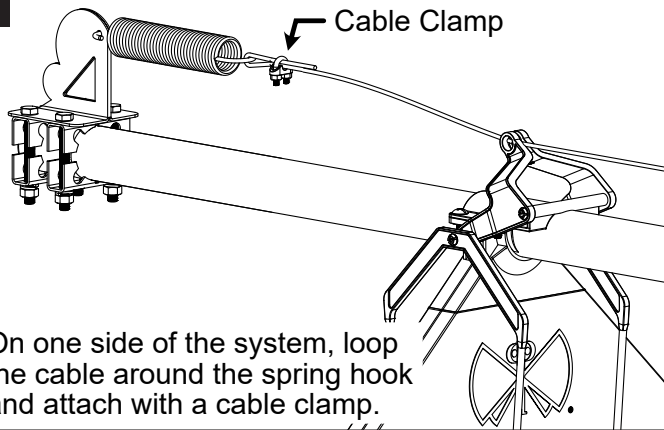

On one side of the system, loop the cable around the spring hook and attach with a cable clamp.

3

Important: Must have minimum distance when taut

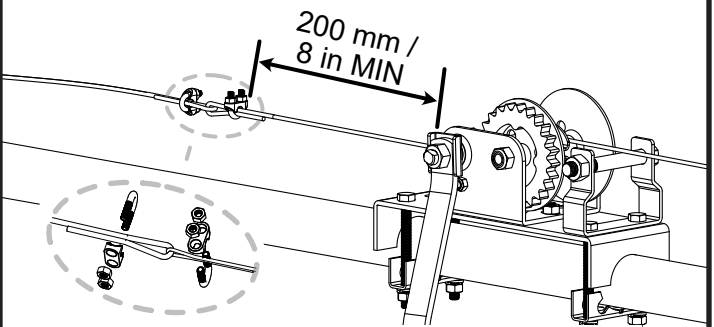

Create two loops to attach the cable to the winch cable. Use cable clamps to secure each.

4

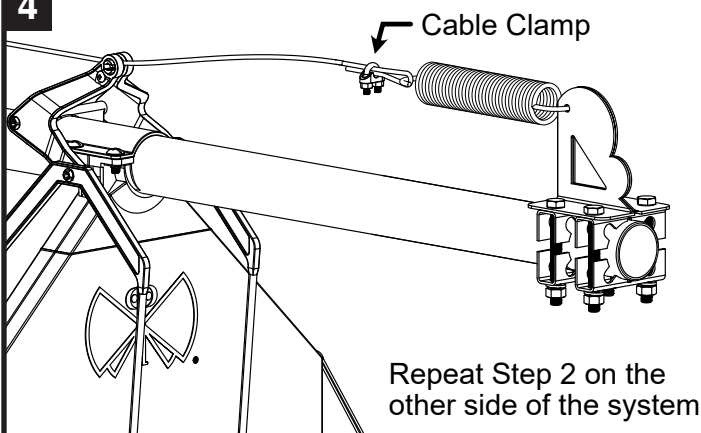

Repeat Step 2 on the other side of the system

5

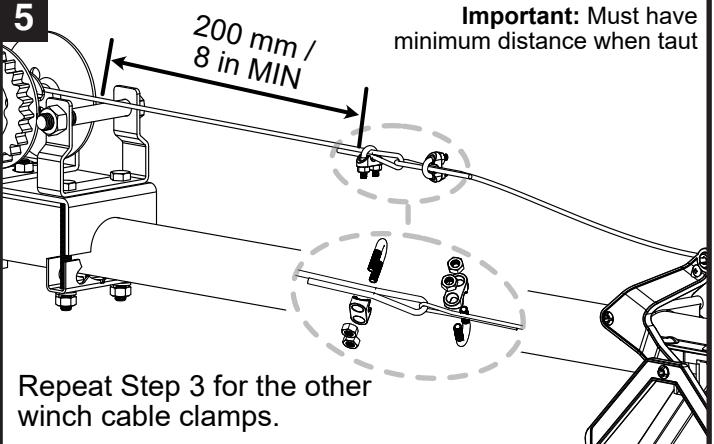

Repeat Step 3 for the other winch cable clamps.

6

Install spindle along with the actuator bolt into the actuator arm slot.

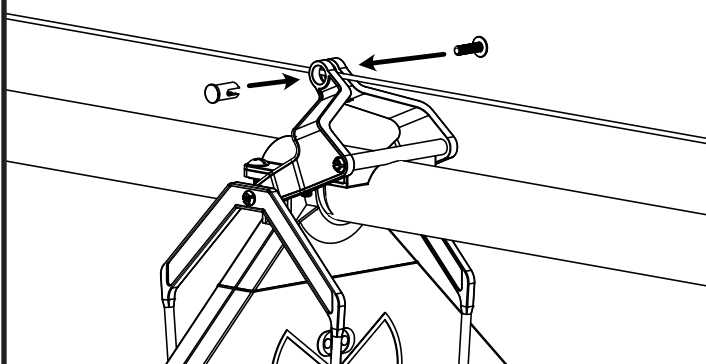

7

Note: Actuator Bolt should just start to engage with the Actuator Spindle. Leave loose for now.

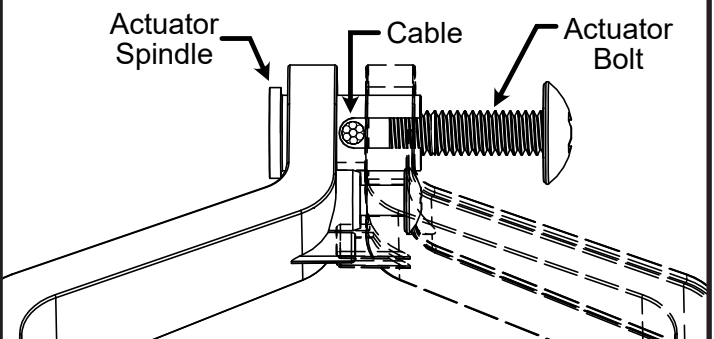

8

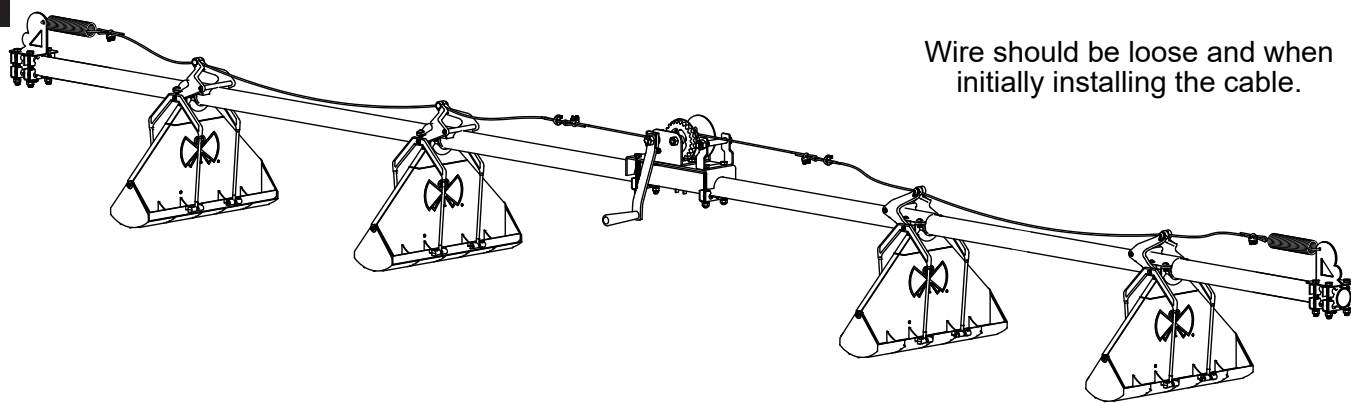

Wire should be loose and when initially installing the cable.

8

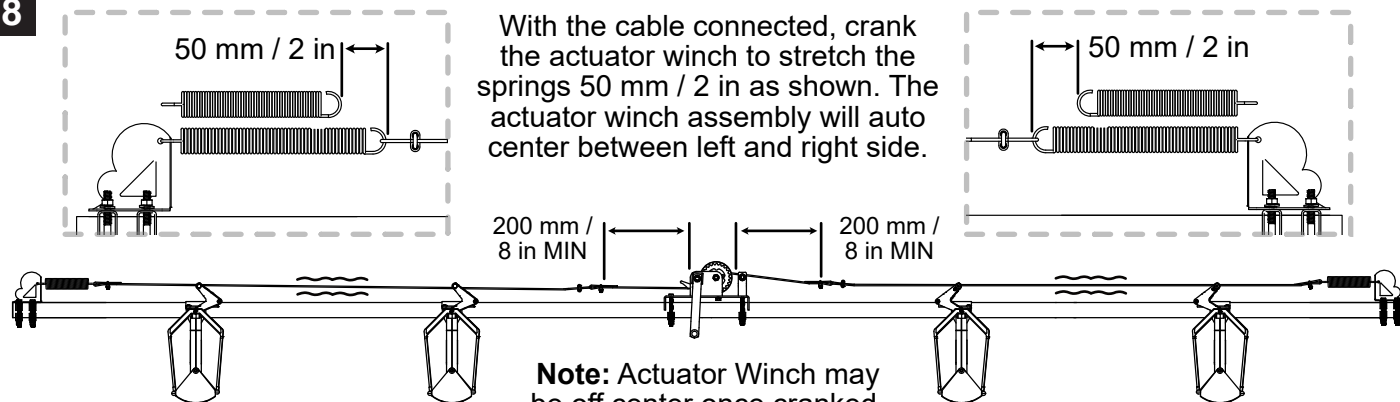

With the cable connected, crank the actuator winch to stretch the springs 50 mm / 2 in as shown. The actuator winch assembly will auto center between left and right side.

200 mm / 8 in MIN

200 mm / 8 in MIN

Note: Actuator Winch may be off center once cranked.

9

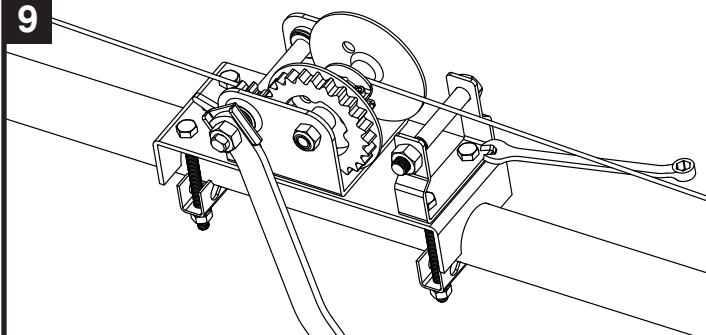

When actuator winch is centered between both sides of the system, tighten the actuator winch assembly to lock it in place

10

Make sure the trays are fully closed

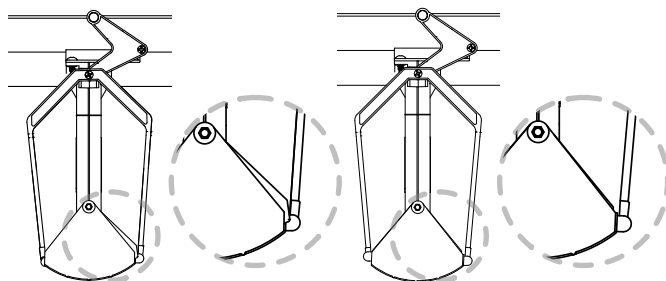

Partially Open

Fully Closed

11

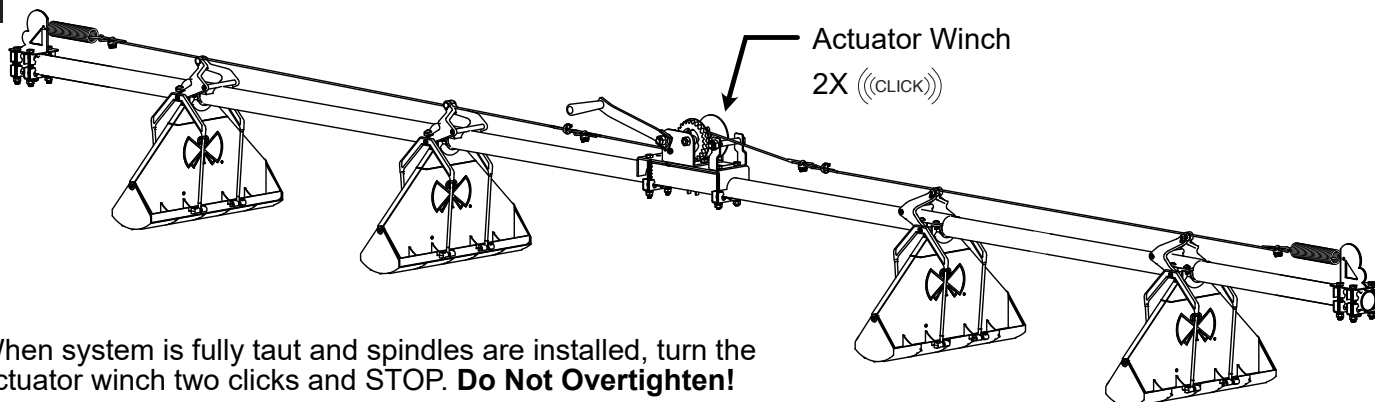

When system is fully taut and spindles are installed, turn the actuator winch two clicks and STOP. **Do Not Overtighten!**

12

With trays in a fully closed position, tighten bolts enough to keep cable centered in the spindle. Use a **screwdriver only**.
Do not use an impact tool.

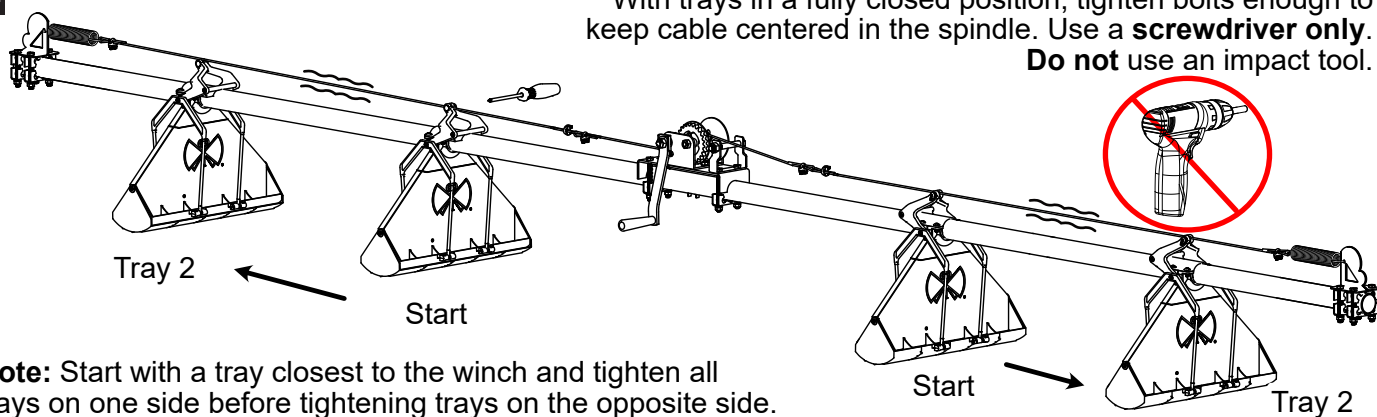

Note: Start with a tray closest to the winch and tighten all trays on one side before tightening trays on the opposite side.

TRAY RETURN ASSEMBLY - HANDLE VERSION

1

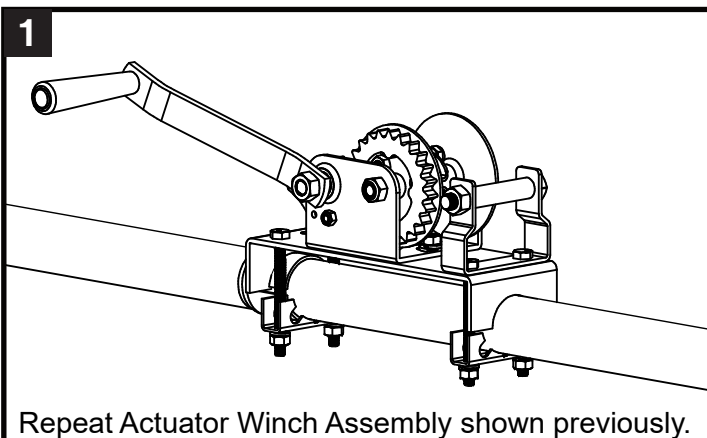

2

Secure tray return assembly to feed tube.

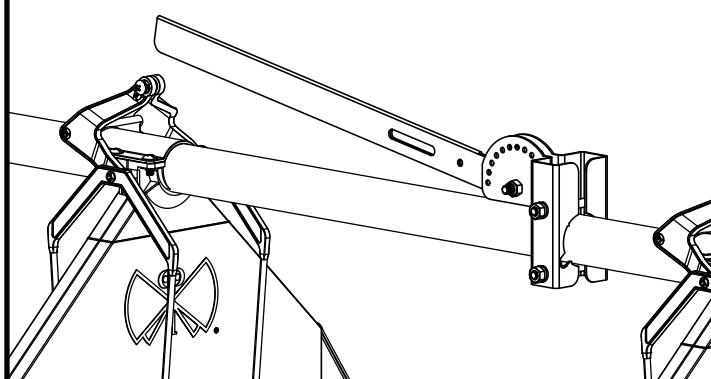

3

Actuator Winch at start of system

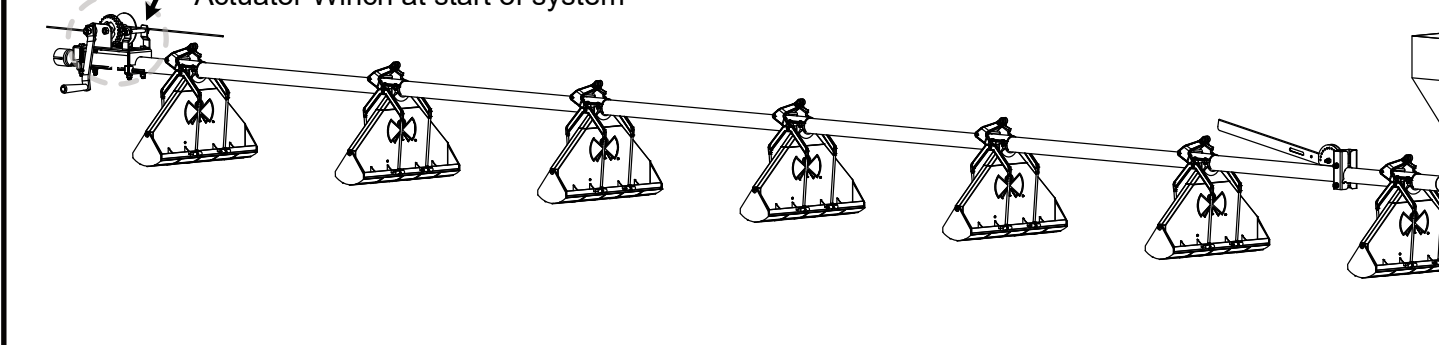

4

200 mm /
8 in MIN

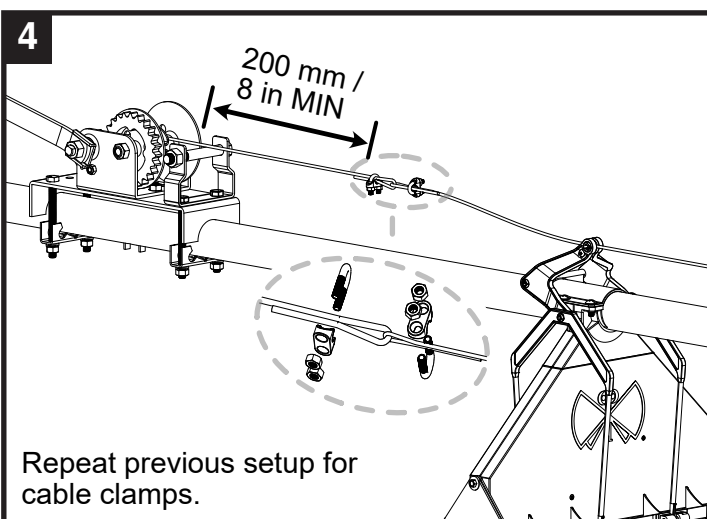

5

Attach the actuator cable to the last tray.

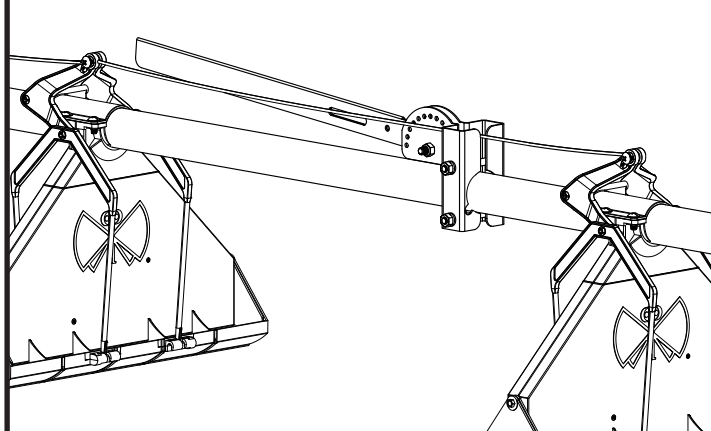

TRAY RETURN ASSEMBLY - HANDLE VERSION

6

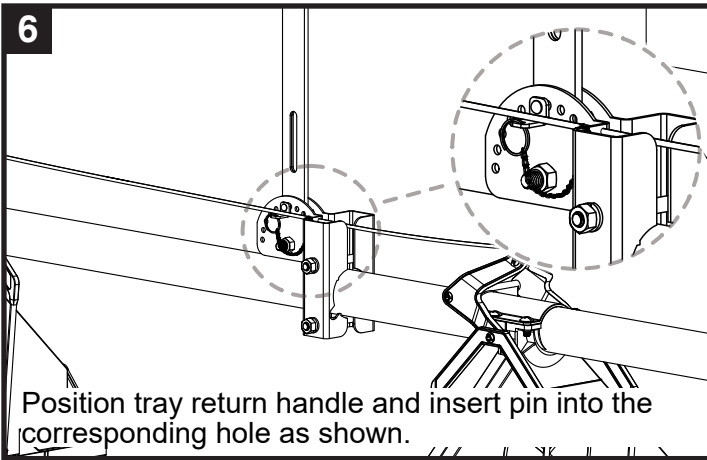

7

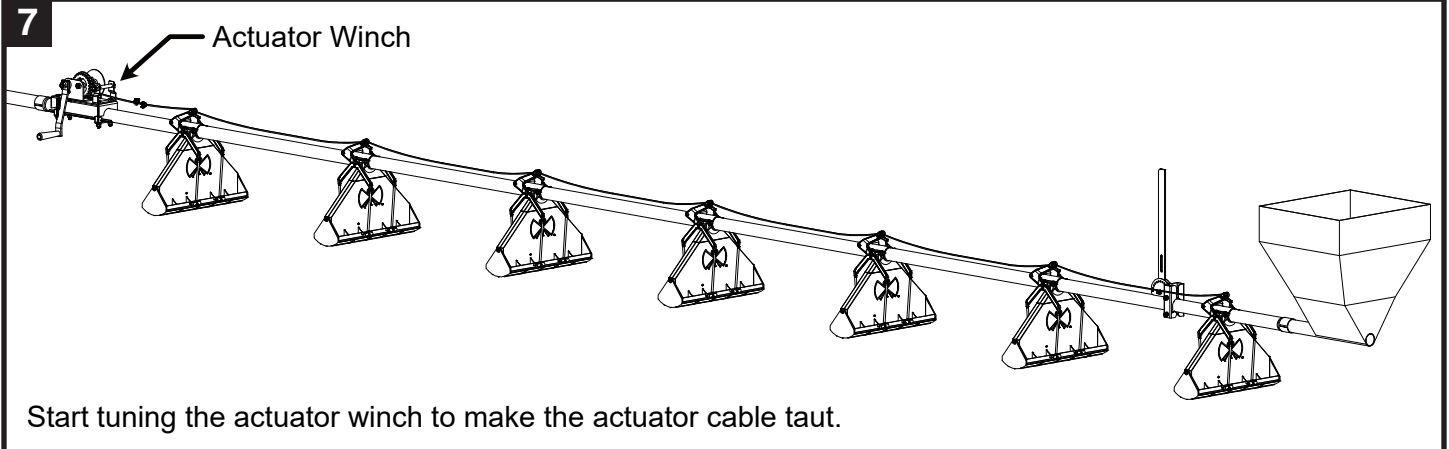

8

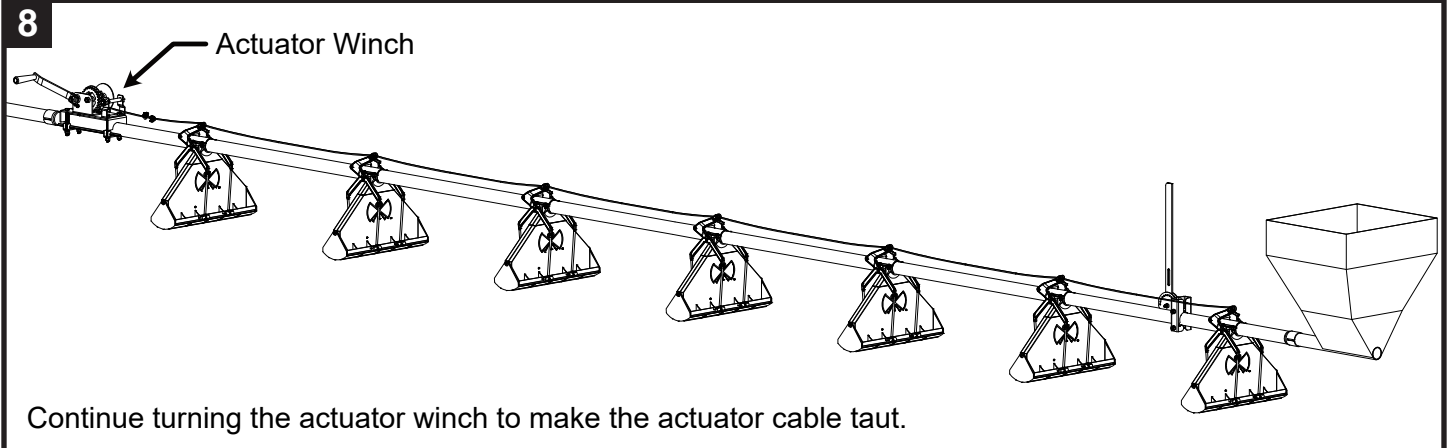

9

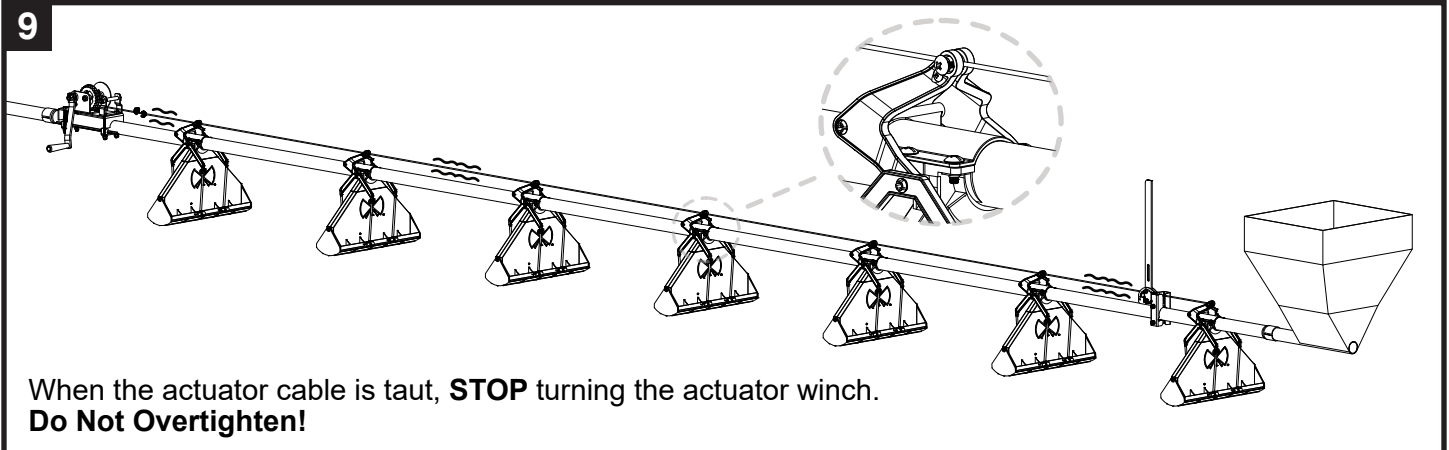

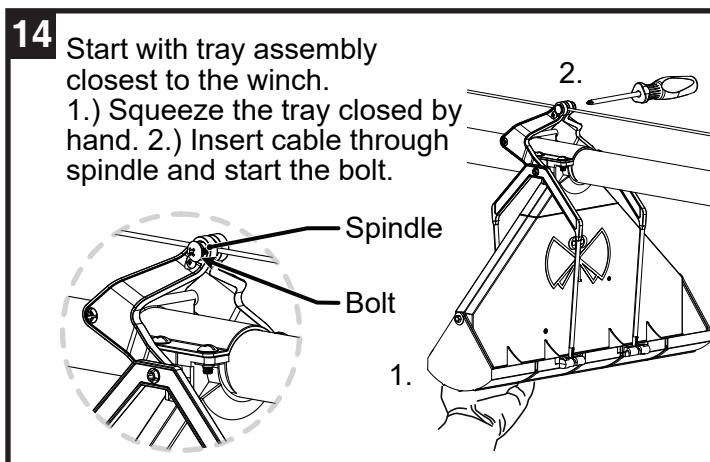
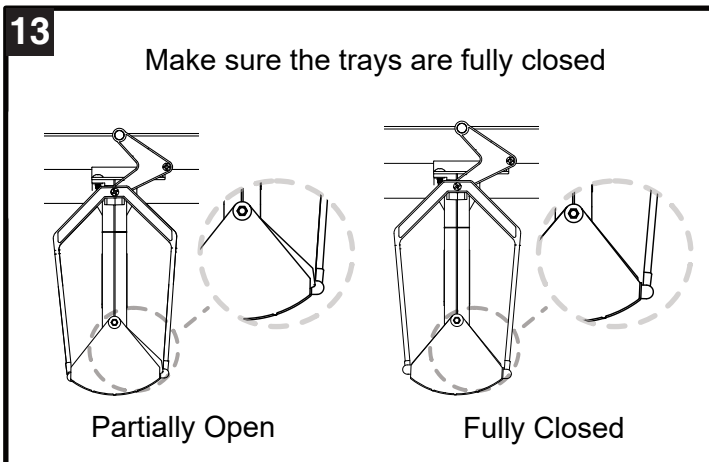
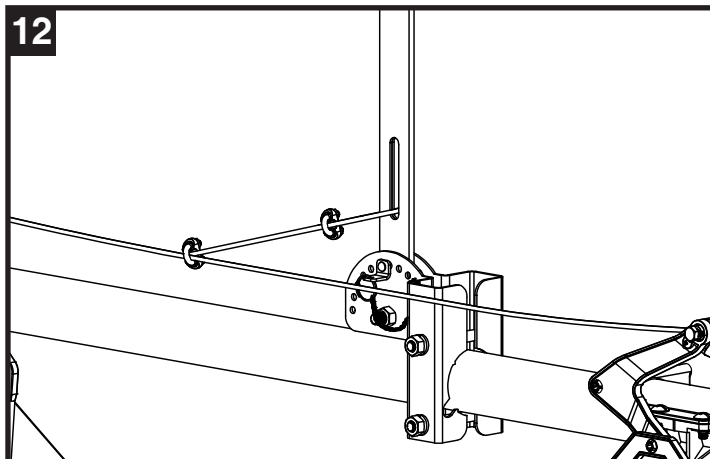
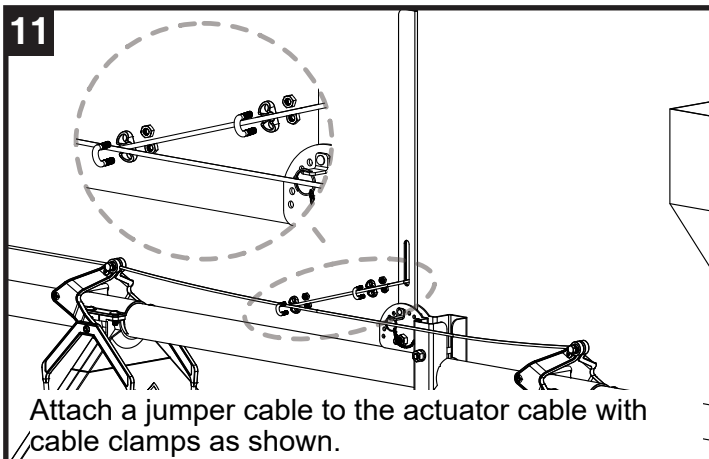
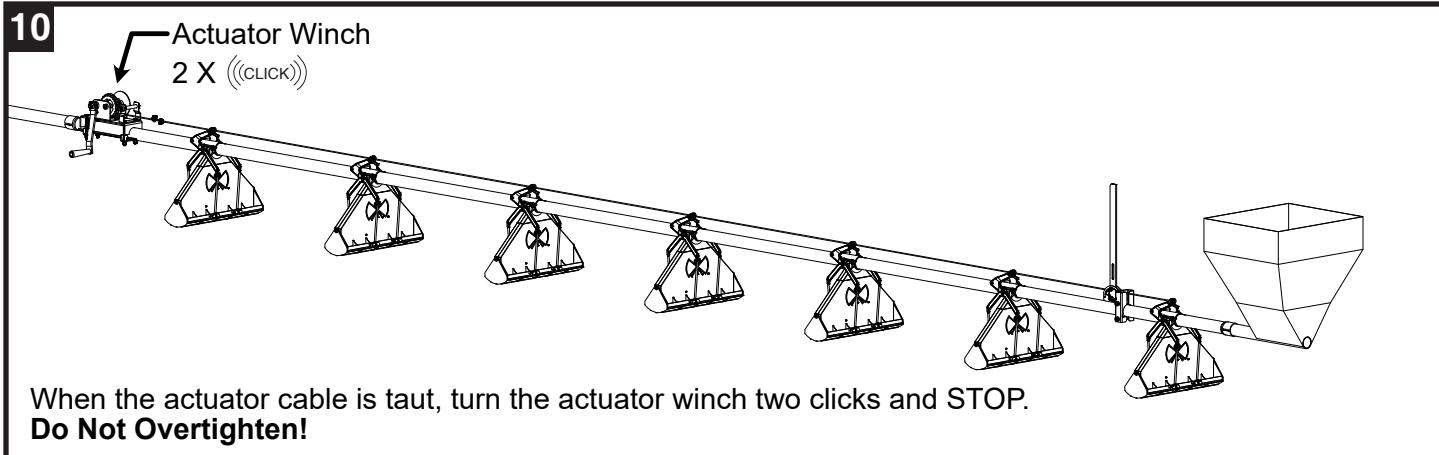

TRAY RETURN ASSEMBLY - HANDLE VERSION

15

Maintain the hand to tray pressure and tighten the bolt with a **screwdriver only**.
Do Not use impact tool.

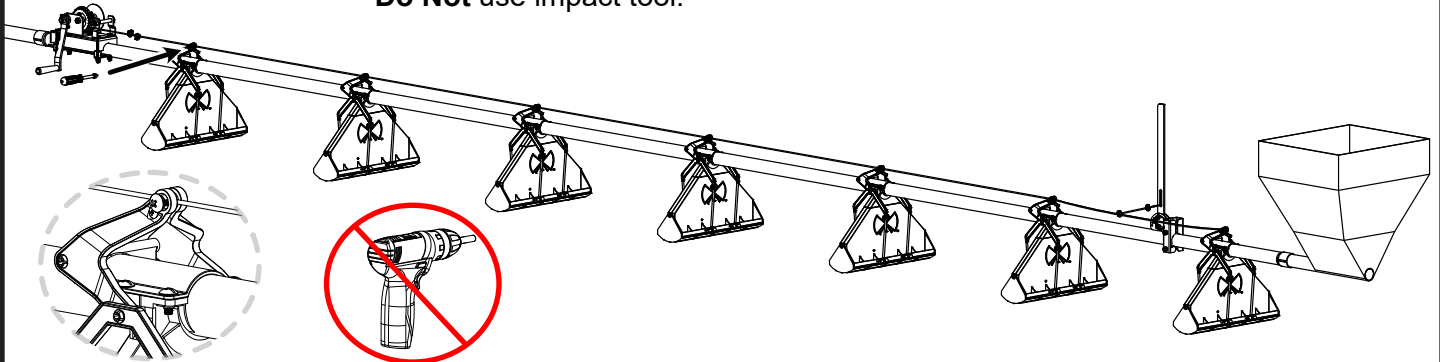

16

Moving away from the actuator winch, repeat these procedures on the remaining Butterfly trays to the end of the feeder line.

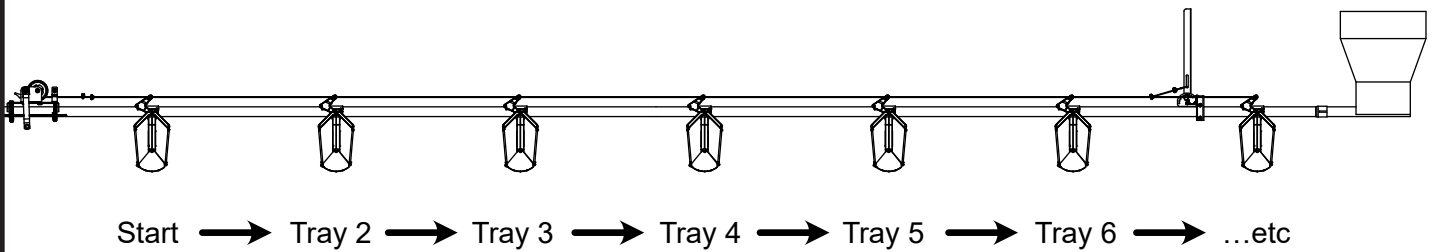

END CONTROL TRAY TO ACTUATOR CABLE INSTALLATION - SPRING VERSION

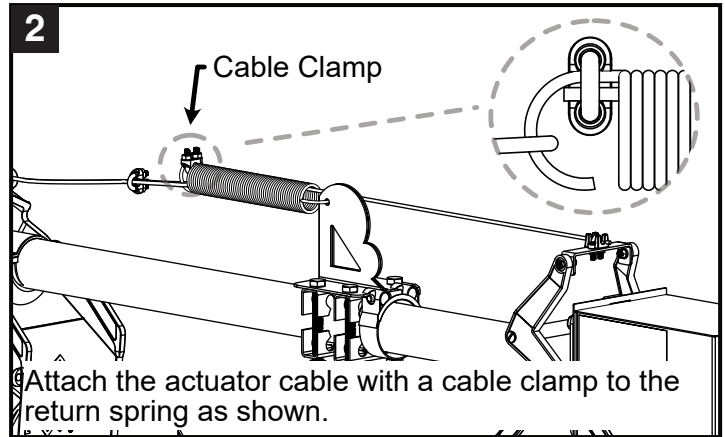
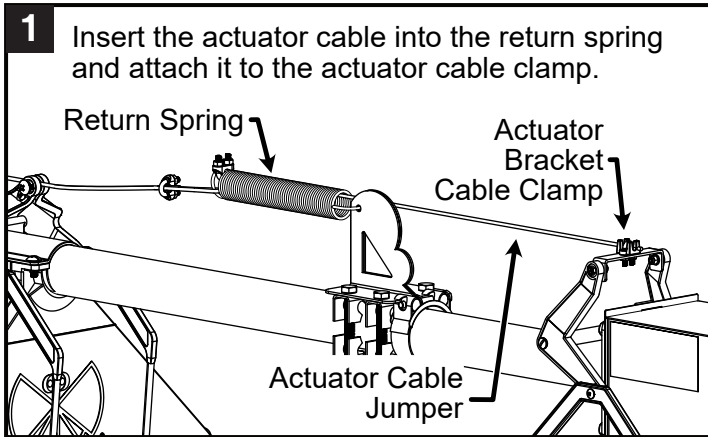

END CONTROL TRAY TO ACTUATOR CABLE INSTALLATION - HANDLE VERSION

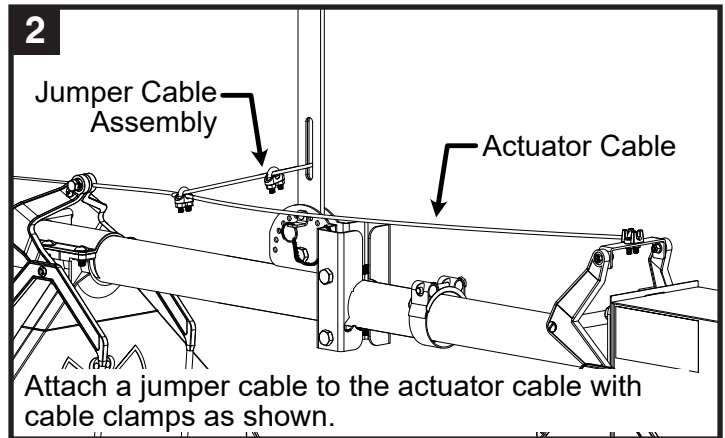
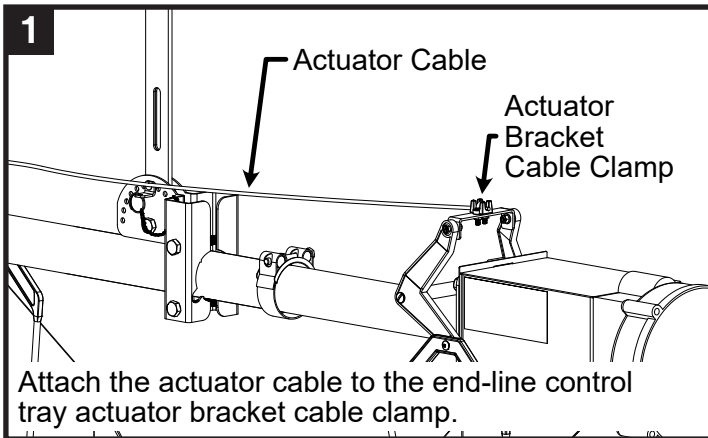

FEED TUBE HANGER LOCATION

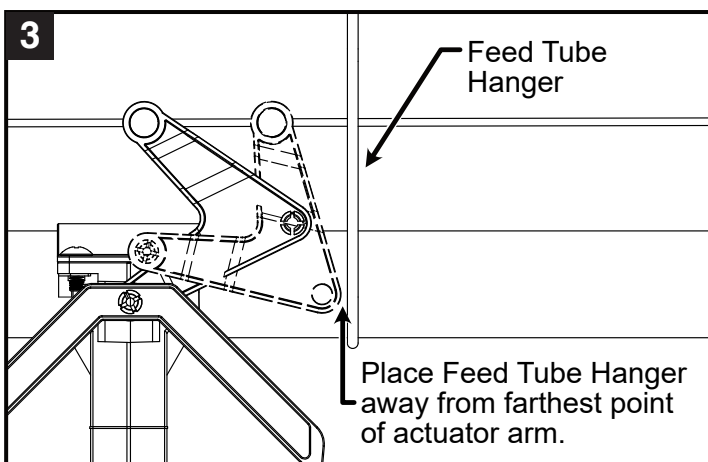
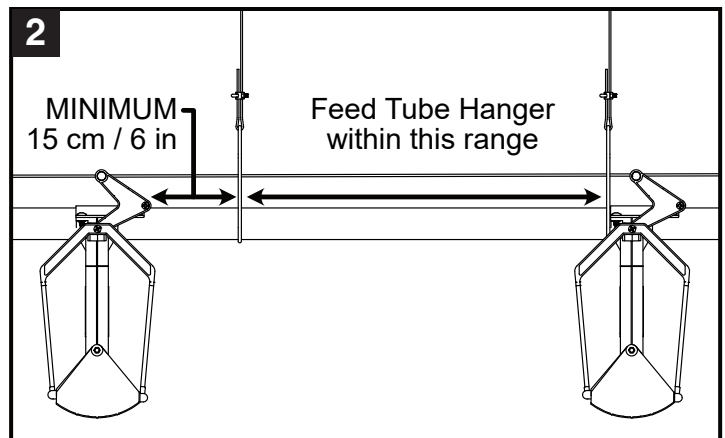
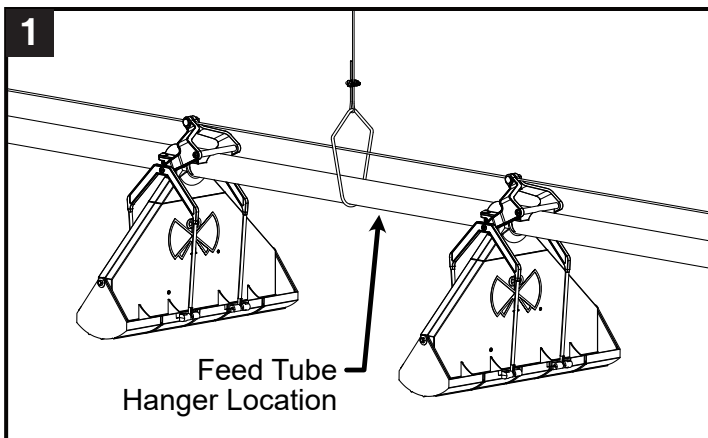

4

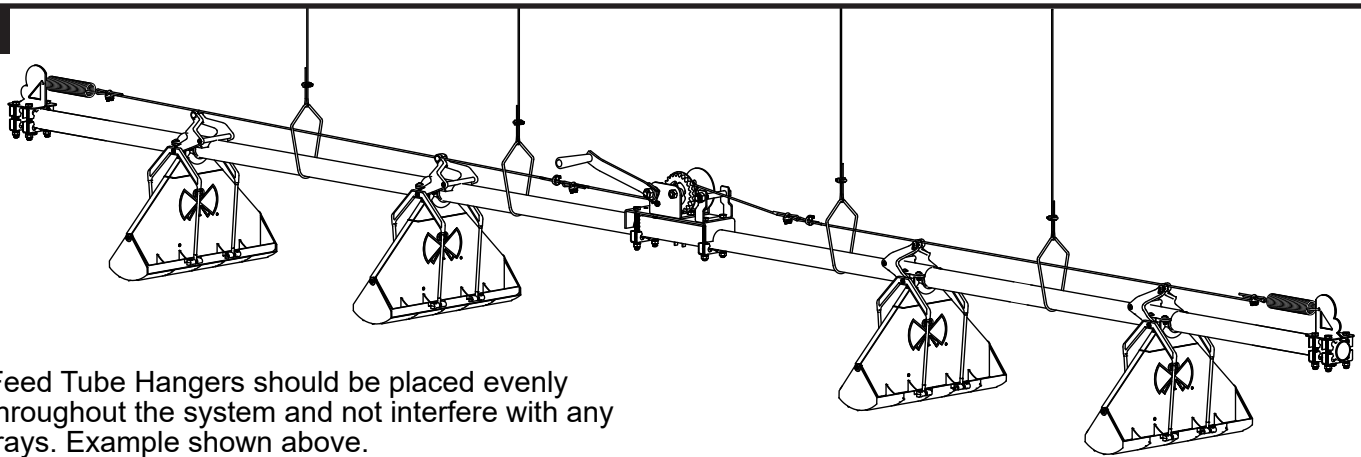

Feed Tube Hangers should be placed evenly throughout the system and not interfere with any trays. Example shown above.

IMPORTANT INSTRUCTIONS

1

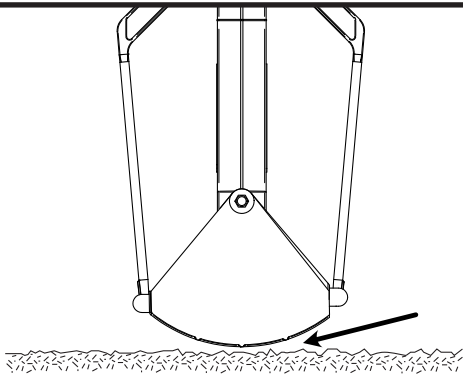

The bottom of the Butterfly Tray should **only touch** the litter.

2

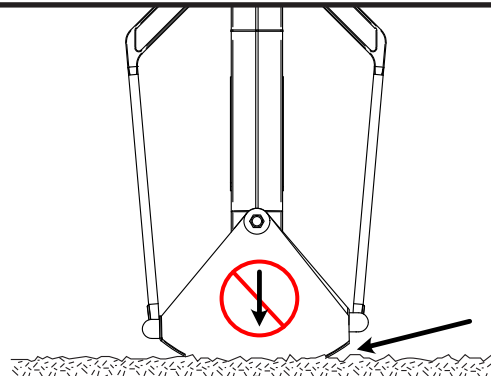

Do Not put any weight or upward pressure on the feed tray.

3

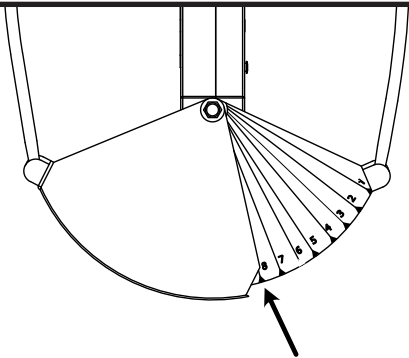

Never adjust the trays wider than the position 8 during the production cycles.

4

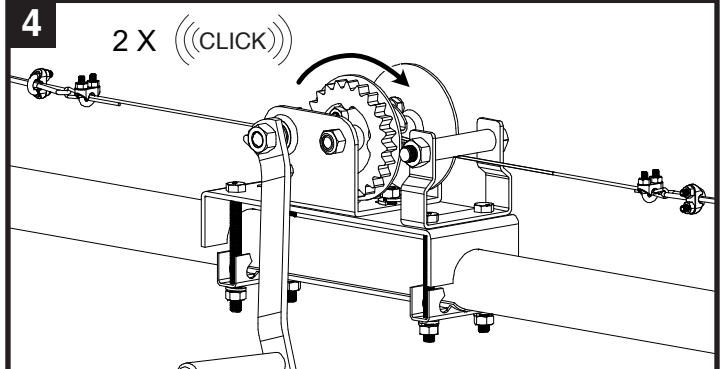

Never turn the actuator winch more than two clicks per day when adjusting the tray opening.

5

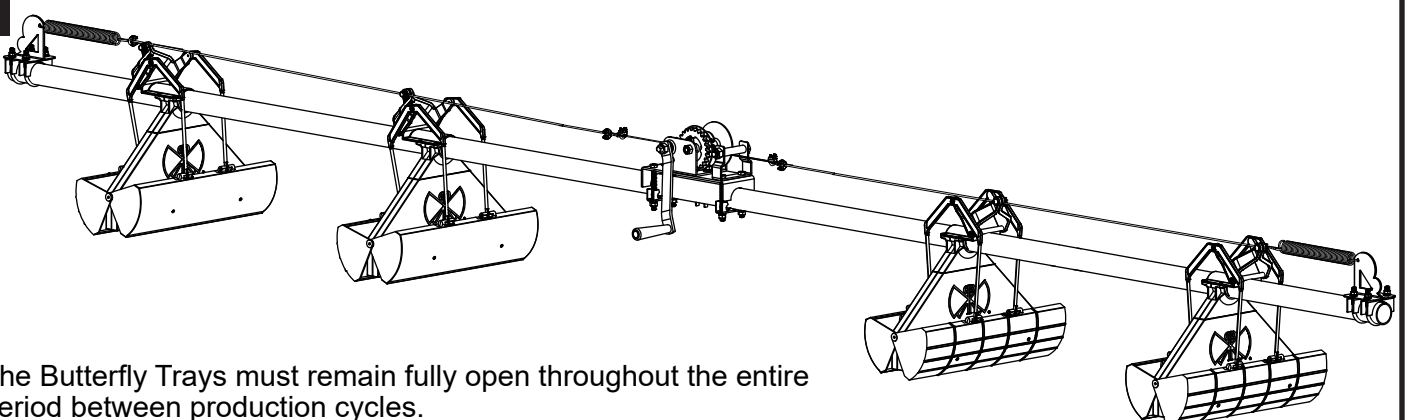

The Butterfly Trays must remain fully open throughout the entire period between production cycles.

TRAY RETURN HANDLE VERSION STARTUP

